

Acessórios/Acessories/Accessories

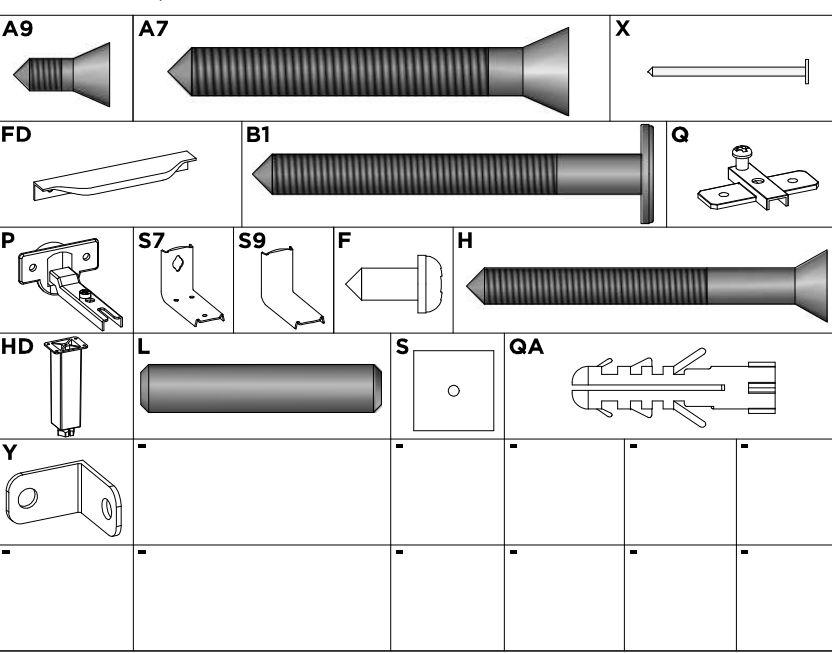

		AMERBOLCA		AVENA		AVENA				DESCRICO		DATA LANÇAMENTO: 19/01/2022		DIMENS		QUANTIDADE	
		BRANCO		GRAFITO		TOUCH				DESCRIPTION OF PARTS		DATA ATUALIZAO: 23/02/2022		DIMENSIONS / QUANTITY		DIMENSIONES / CANTIDAD	
										DESCRIPCION DE LAS PIEZAS							
SEQ.	CODIGO	REF_01	REF_02	REF_03	REF_04	REF_05	REF_06	REF_07	DESCRICAO	DESCRIPTION_EN	DESCRIPCION_ES	DIMENS	QTD				
1	03256	138	157	157	-	-	-	-	BASE	BASE	BASE	670 X 500 X 15	1				
2	03257	138	157	157	-	-	-	-	BASE INTERMEDIARIA	SHELF	ESTANTERIA	670 X 500 X 15	1				
3	07190	138	157	157	-	-	-	-	CHAPEU	TOP PANEL	TAPA SUPERIOR DEL ROPERO	670 X 500 X 15	1				
4	11596	136	158	158	-	-	-	-	LATERAL DIREITA	RIGHT SIDE PANEL	LATERAL DERECHA	2020 X 500 X 15	1				
5	11597	136	158	158	-	-	-	-	LATERAL ESQUERDA	LEFT SIDE PANEL	LATERAL IZQUIERDA	2020 X 500 X 15	1				
7	14408	153	163	159	-	-	-	-	PORTA INFERIOR PANELEIRO	DOOR	PUERTA	625 X 339 X 15	2				
8	15263	138	157	157	-	-	-	-	PRATELEIRA	SHELF	ESTANTERIA	670 X 360 X 15	2				
9	15264	136	158	158	-	-	-	-	PRATELEIRA EXTERNA	SHELF	ESTANTERIA	670 X 360 X 15	1				
10	19336	136	158	158	-	-	-	-	TAMPO	DRAWER CABINET TOP PANEL	TAPA DEL CAJN	670 X 500 X 15	1				
11	20589	138	157	157	-	-	-	-	TRASEIRO DO MICROONDAS	BACK PANEL	TRASERO	696 X 446 X 3	1				
12	20590	138	157	157	-	-	-	-	TRASEIRO DO PANELEIRO	BACK PANEL	TRASERO	696 X 338 X 3	4				
13	20604	138	157	157	-	-	-	-	TRASEIRO DO NICHU	BACK PANEL	TRASERO	696 X 215 X 3	1				
14	28140	136	158	158	-	-	-	-	TRAVESSA FRONTAL	FRONT CRANKCASE	TRAVESA FRONTAL	670 X 70 X 15	1				
SEQ.	CODIGO	REF_01	REF_02	REF_03	REF_04	REF_05	REF_06	REF_07	DESCRICAO	DESCRIPTION_EN	DESCRIPCION_ES	DIMENS	QTD				
6	14407	153	163	159	-	-	-	-	PORTA SUPERIOR DO PANELEIRO	TOP PAN CABINET DOOR	PUERTA	680 X 339 X 15	2				
SEQ.	CODIGO	REF_01	REF_02	REF_03	REF_04	REF_05	REF_06	REF_07	DESCRICAO	DESCRIPTION_EN	DESCRIPCION_ES	DIMENS	QTD				
15	327001	10	10	10	-	-	-	-	PORTA DE VIDRO	GLASS DOOR	PUERTA DE VIDRIO	680 X 339 X 15	2				

01

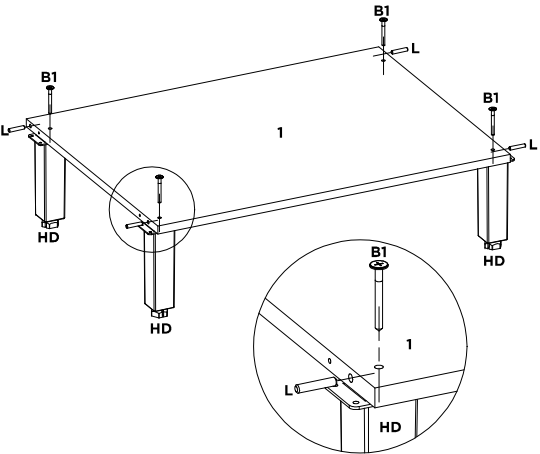

02

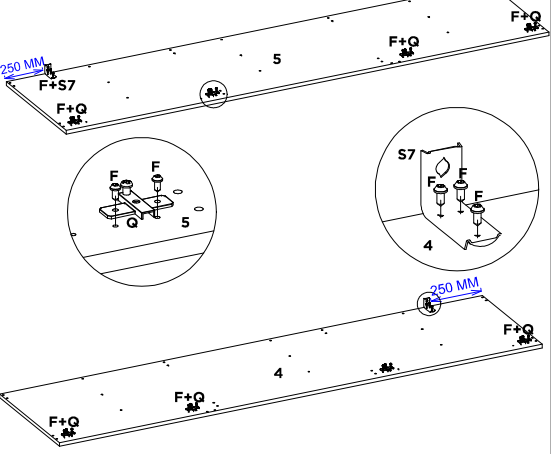

03

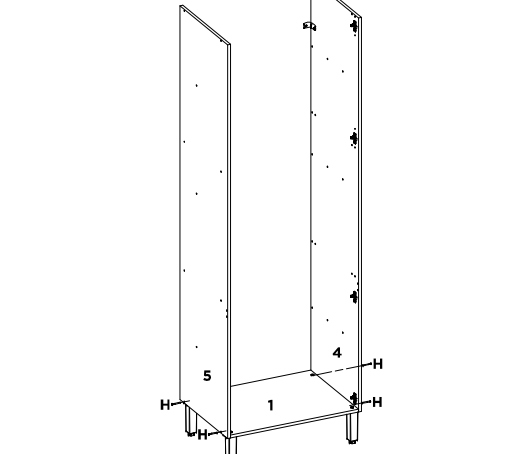

04

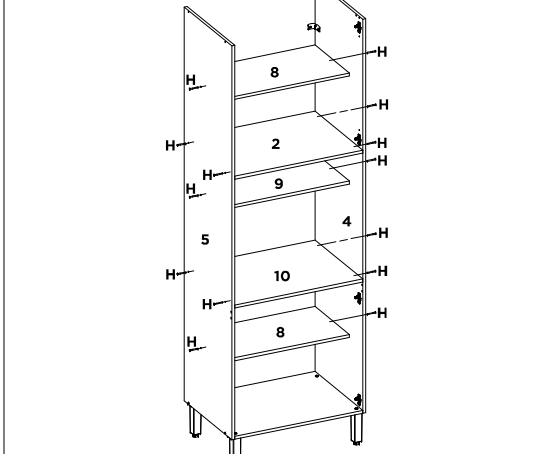

05

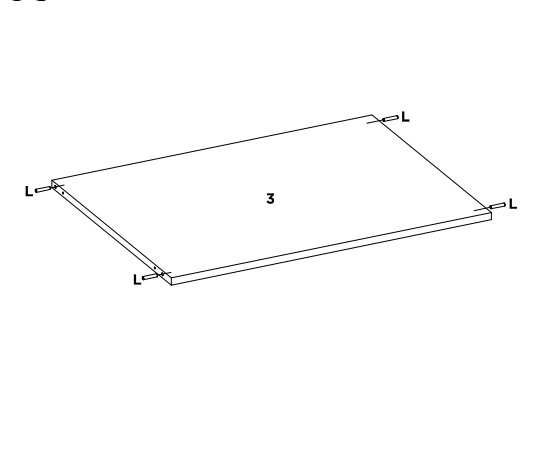

06

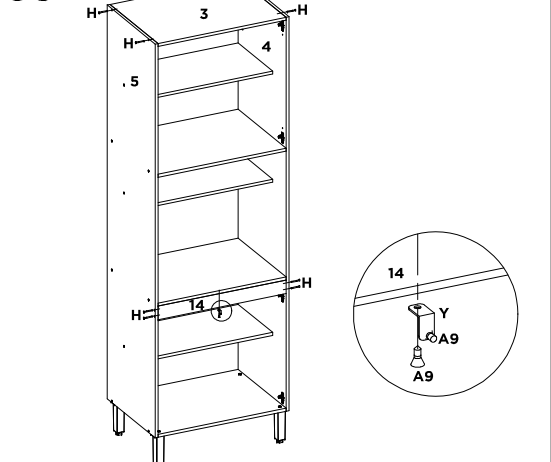

07

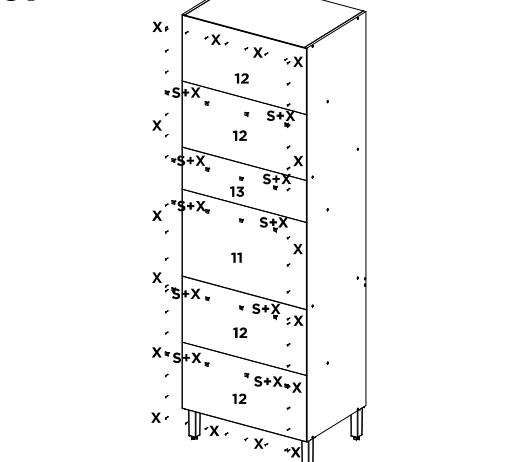

08

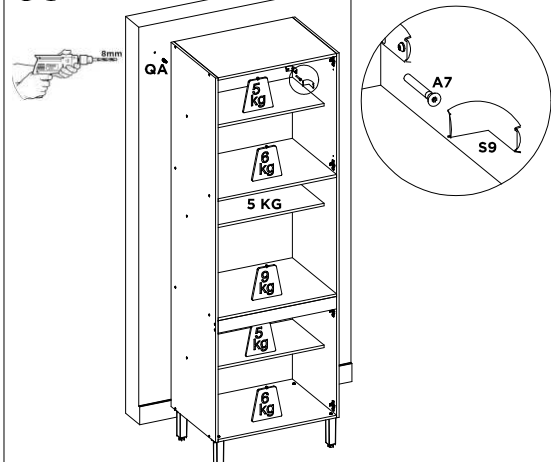

09

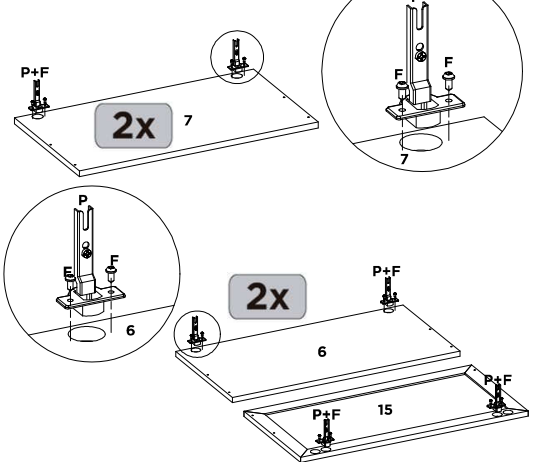

10

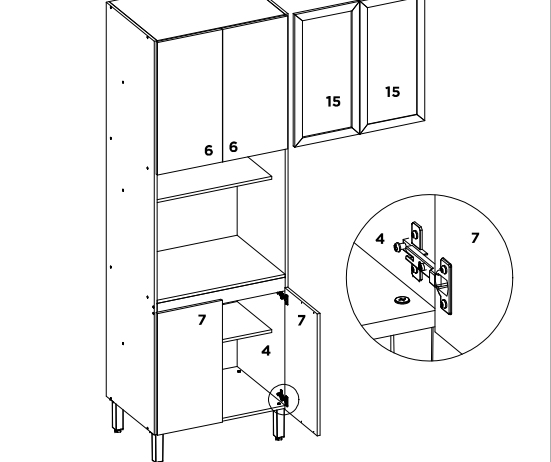

11

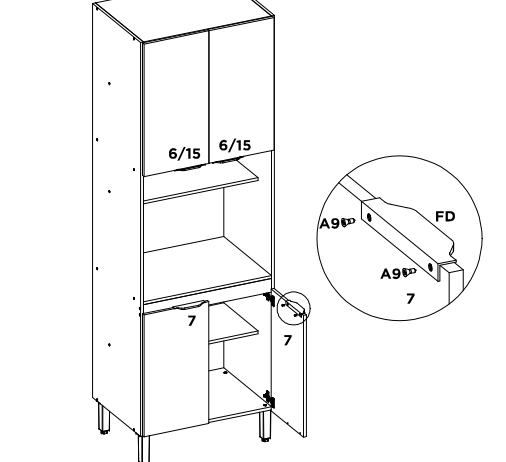

12

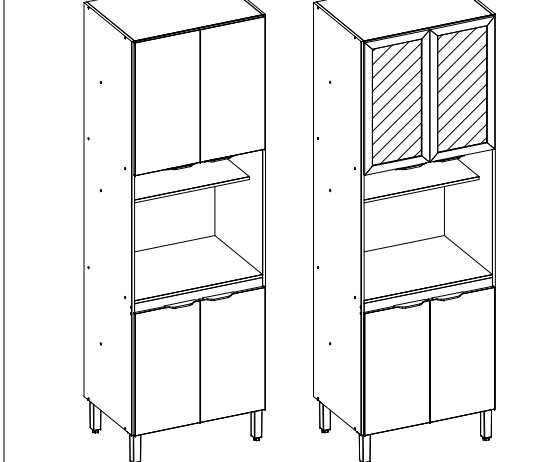

MANUAL COMPLETO
COMPLETE MANUAL



DEMÓBILE Indústria de Móveis Ltda.
Rua : Jurutau, 1350 - Pq. Industrial II.
Cep.: 86703-070
Arapongas - PR - Brasil
demobile@demobile.com.br

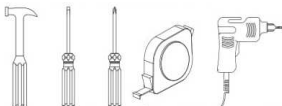

Avisos

1. Ler atentamente as instruções do manual antes de iniciar a montagem do móvel.
 2. A montagem deverá ser feita em superfície limpa e plana, aconselhamos forrar o chão com a embalagem do produto, para não danificar.
 3. Os parafusos devem ser apertados periodicamente.
 4. Evitar batidas e contato com objetos cortantes.
 5. O peso máximo de carga informado refere-se a objetos distribuídos de maneira uniforme sobre toda área de contato da peça.
- Limpeza e Conservação**
Efetuar a limpeza somente com pano macio limpo e seco.
Não Utilizar produtos abrasivos ou químicos.

- Garantia**
1. O fabricante responsabiliza-se apenas pelas peças do produto.
 2. A montagem incorreta acarretará na perda da garantia e das assistências, desta forma o produto deverá ser montado por profissional qualificado.
 3. Não estão cobertos pela garantia problemas que tenham origem na utilização inadequada do produto ou na exposição do mesmo a intempéries como: infiltrações, infestação de pragas em geral, aparecimento de mofo e outros, decorrentes do ambiente de instalação.
- Assistência Técnica:** Em caso de peças em assistência técnica é necessário que as mesmas sejam solicitadas junto a loja ou site no qual a compra do produto foi realizada

Warnings

1. Read the manual instructions carefully before starting to assemble the furniture.
 2. The assembly must be done in clean and flat surface, we advise to put the product packaging on the floor, not to damage it during the assembling.
 3. The screws must be tightened periodically.
 4. Avoid hitting and contacting sharp objects.
 5. The payload informed refers to the objects distributed all over the piece contact area.
- Cleaning and conservation**
Clean the product just with a soft, cleaned and dry cloth.
Do not use abrasive or chemicals products.
- Warranty**
1. The manufacturer is only responsible for product parts.
 2. Incorrect assembling will make you lost the guarantee and assistance, in this way the product must be assembled by qualified professional.
 3. It is Not covered by the warranty problems caused by an inappropriate use of the product or product exposure even in bad weather, such as: infiltrations, pest infestation in general, appearance of mold and others, caused by the installation environment.
- Technical Assistance:** Damaged pieces! Ask on the stores you bought it.

Advertencias

1. Lee atentamente las instrucciones del manual antes de empezar a armar los muebles.
 2. El montaje debe hacerse en superficie limpia y plana, utilice el empaque del Producto para cubrir el piso
 3. Los tornillos deben ser apretados periódicamente
 4. Evite golpear y chocar objetos punzantes
 5. El peso máximo de carga tiene relación a los objetos distribuydos sobre toda el área de contacto de la pieza.
- Limpeza y conservación**
Limpiar solo con un trapo suave, limpio y seco
No utilice productos abrasivos o productos químicos
- Garantía**
1. El fabricante solo es responsable a las partes del producto.
 2. Armar incorrectamente supone la pérdida de garantía y repuestos, de esta manera el producto debe ser ensamblado por profesional calificado
 3. No es garantizado problemas derivados del uso inapropiado del producto, o exposición del producto al mal tiempo, como: Infiltraciones, infestación de plagas en general, aparición de moho y otros.
- Asistencia técnica:** en caso de piezas rotas es necesario que sea solicitadas las mismas a la tienda o sitio web donde se compró el producto.

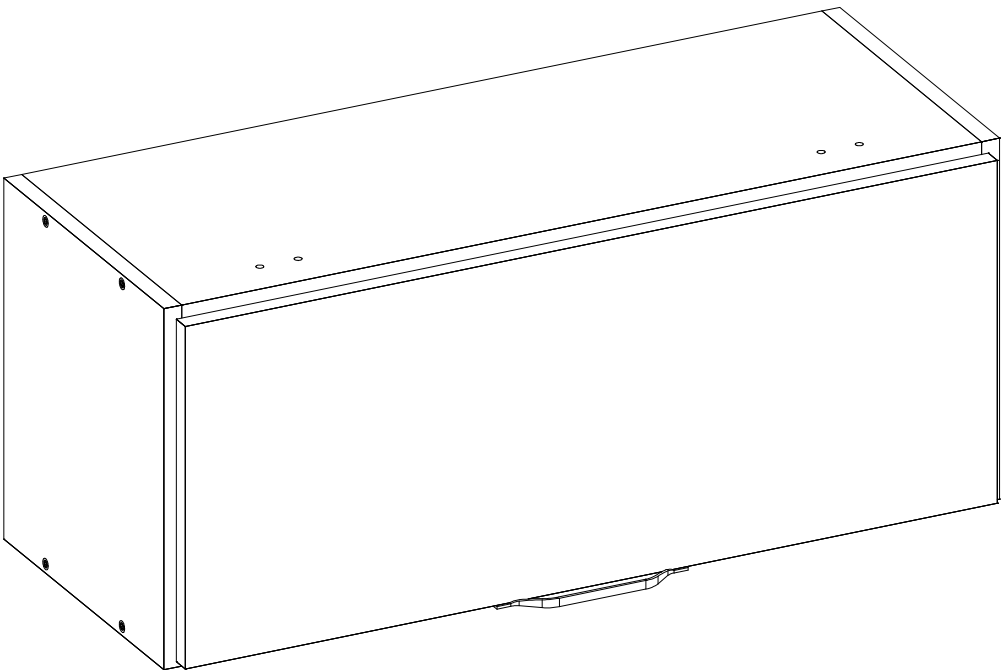

94101 ARMARIO AEREO 01 PORTA 70 CM FIRENZE

94101 WALL CABINET 01 DOOR 70 CM FIRENZE

94101 ARMARIO DE PARED 01 PUERTA 70 CM FIRENZE

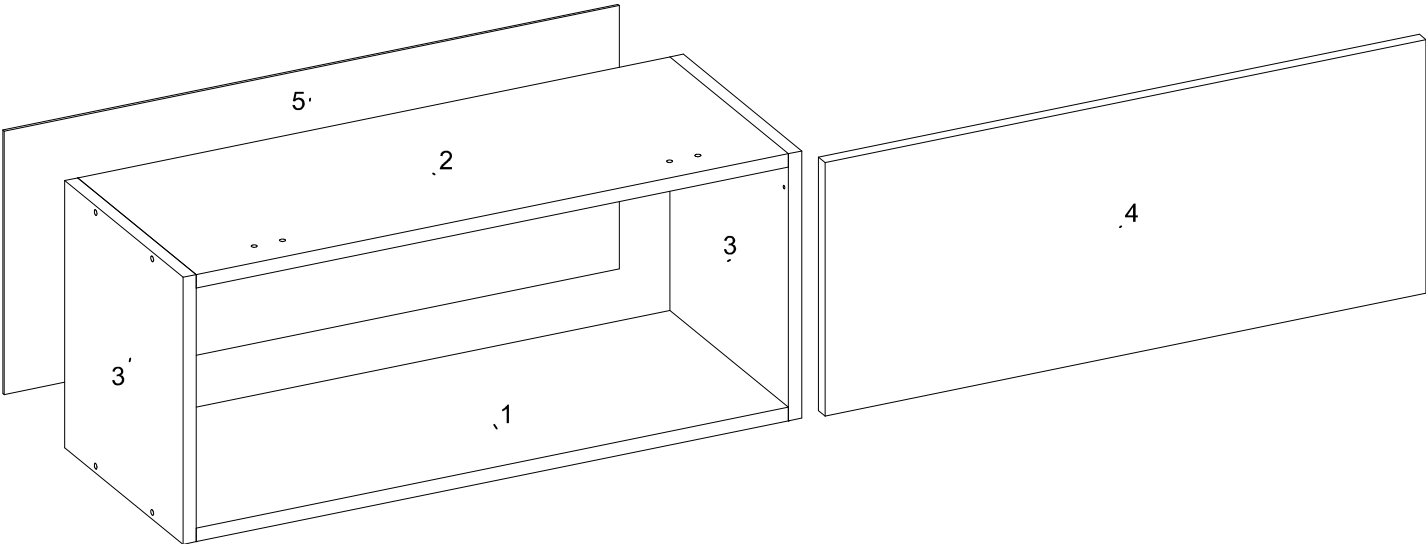

SEQ.	CODIGO	AMENDOLA	AVENA	AVENA	REF_04	REF_05	REF_06	REF_07	DESCRICAÇÃO DE PEÇAS DESCRIPTION OF PARTS DESCRIPCION DE LAS PIEZAS			DATA LANÇAMENTO: 21/01/2022 DATA ATUALIZAÇÃO: 07/03/2022		DIMENSÕES / QUANTIDADE DIMENSIONS / QUANTITY DIMENSIONES / CANTIDAD	
		BRANCO	GRAFITO	TOUCH					DESCRICAÇÃO	DESCRIPTION_EN	DESCRIPCION_ES	DIMENSOES_MM		QTD	
1	03262	138	157	157	-	-	-	-	BASE	BASE	BASE	670 X 268 X 15		1	
2	07193	138	157	157	-	-	-	-	CHAPEU	TOP PANEL	TAPA SUPERIOR DEL ROPERO	670 X 268 X 15		1	
3	11604	136	158	158	-	-	-	-	LATERAL	SIDE PANEL	LATERAL	296 X 268 X 15		2	
4	14415	153	163	159	-	-	-	-	PORTA BASCULANTE	TILTING DOOR	PUERTA ABATIBLE	680 X 281 X 15		1	
5	20603	138	157	157	-	-	-	-	TRASEIRO	BACK PANEL	TRASERO	696 X 292 X 3		1	

LISTA DE ACESSORIOS / LIST OF ACCESSORIES / LISTA DE ACCESORIOS					
SEQ.	CODIGO.	DESCRIÇÃO	DESCRIPTION_EN	DESCRIPCION_ES	QTD.
-	01446	KIT DE ACESSORIOS	KIT OF ACCESSORIES	KIT DE ACCESORIOS	1
A11	9905036	PARAFUSO 6,0 X 15 MM MM UNIAO CHATO ZB PHILIPS	FLANGE SCREW PHILIPS	TORNILLO REBORDEADO PHILIPS	4
A7	9905027	PARAFUSO 6 X 50 MM CHATA PHILIPS	PHILIPS FLAT HEAD SCREW	TORNILLO CHATA PHILIPS	2
A9	9905006	PARAFUSO 4 X 12 MM CHATA PHILIPS	PHILIPS FLAT HEAD SCREW	TORNILLO CHATA PHILIPS	2
D	9905018	PARAFUSO 3.5 X 25 MM CHATA PHILIPS	PHILIPS FLAT HEAD SCREW	TORNILLO CHATA PHILIPS	4
F	9905007	PARAFUSO 4 X 12 MM PANELA PHILIPS	PANHEAD SCREW	TORNILHO CABEZEIRA DE OLHA	10
FD	9904049	PUXADOR COVER F 128 MM	HANDLE	TIRADOR	1
H	9905015	PARAFUSO 4.5 X 45 MM CHATA PHILIPS	PHILIPS FLAT HEAD SCREW	TORNILLO CHATA PHILIPS	8
L	9920011	CAVILHAS 6 X 30 MM	WOODEN PEG	CLAVIJA DE MADERA	8
P	9920020	DOBRADICA ALTA 26 MM ESTAMPADA	HINGE	BISAGRA	2
PA	9920091	PISTAO A GAS 60N	GAS PISTON	PISTON DE GAS	1
Q	9920005	CALCO DOBRADICA 5 MM	CHOCK	CALCE	2
QA	9920056	BUCHA PLASTICA 8MM CINZA	PLASTIC PIPE BUSHING 8 MM GREY	BUJE PLASTICO 8MM GRIZ	2
S7	9920055	SUPORTE FIXACAO AEREO 45 MM ZB	FIXACAO AIR SUPPORT	SUPORTE FIXACAO AÉREO	2
S9	9924020	PROTECAO SUPORTE AEREO 45MM PLASTICO	OVERHEAD SUPORT PROTECTION 45MM	PROTECCIÓN DEL SOPORTE AEREO 45MM PLASTICO	2
X	9906002	PREGO 9X9 MM	NAIL	CLAVO	20



Acessórios/Accessories/Acessórios

FD

A9

A11

A7

F

H

P

L

Q

PA

QA

S7

S9

X

-

D

-

-

-

-

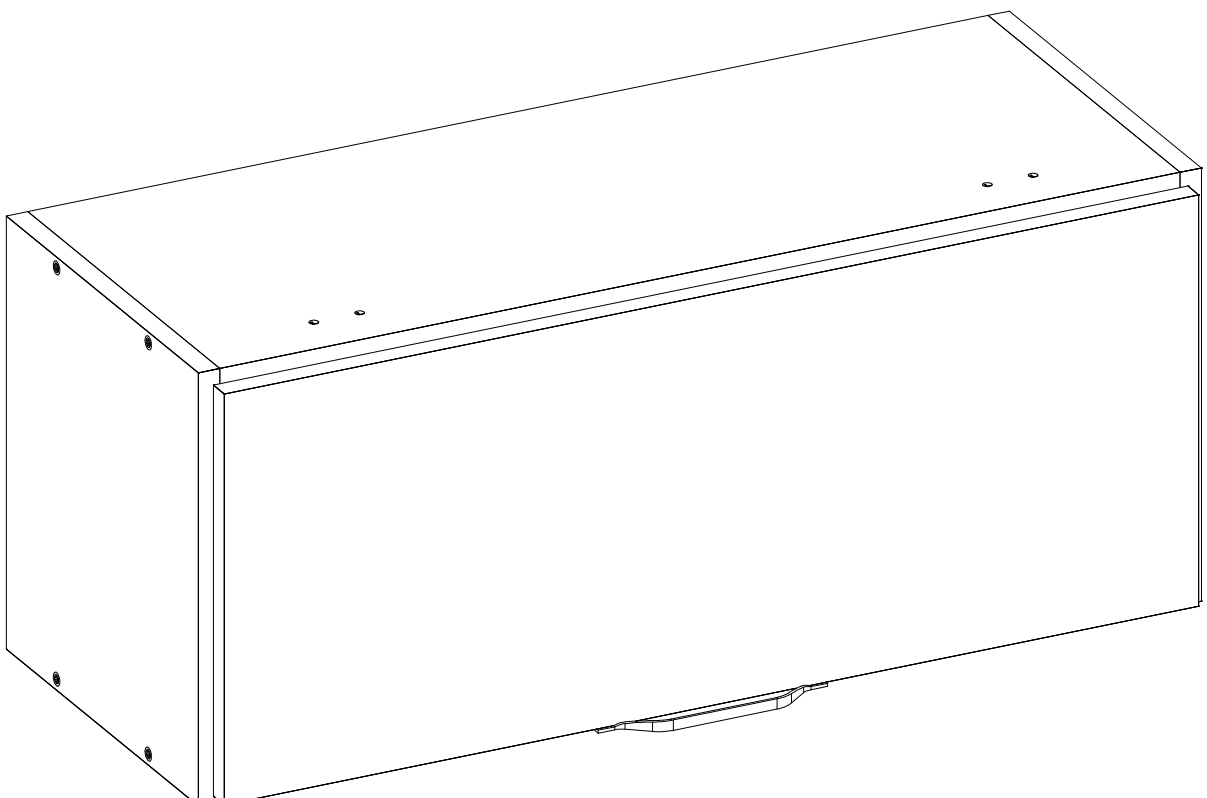

NÃO DOBRAR

NOT BEND

NO DOBLES

GABARITO DE FIXAÇÃO DO PISTAO

PISTON FIXATION TEMPLATE

PLANTILLA DE FIJACIÓN DEL PISTÓN

GB

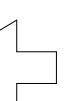

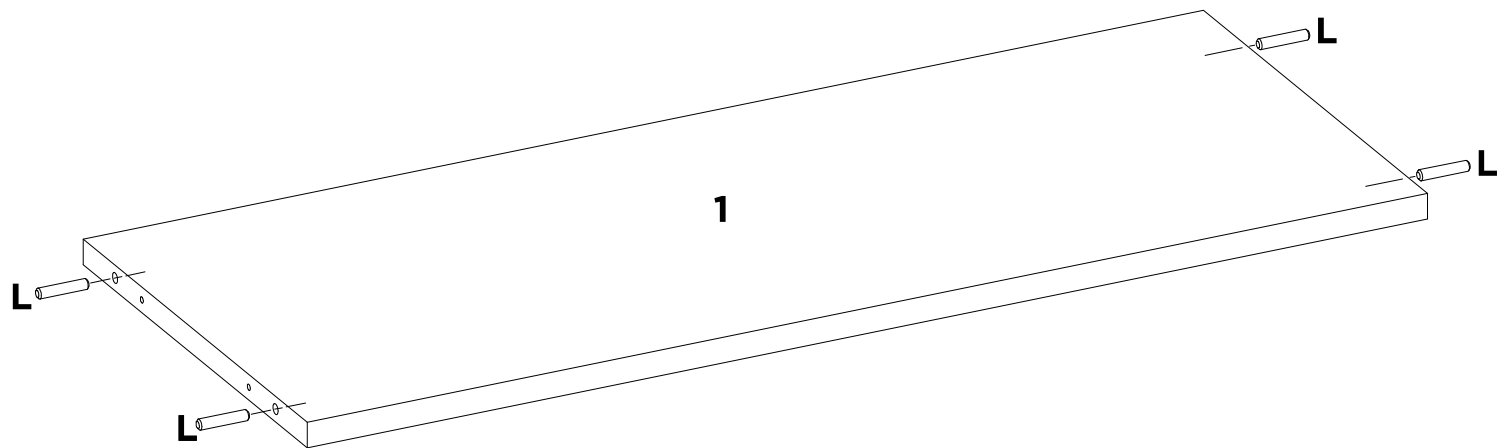

L	-	-	-	-	-	-	-
X4	-	-	-	-	-	-	-

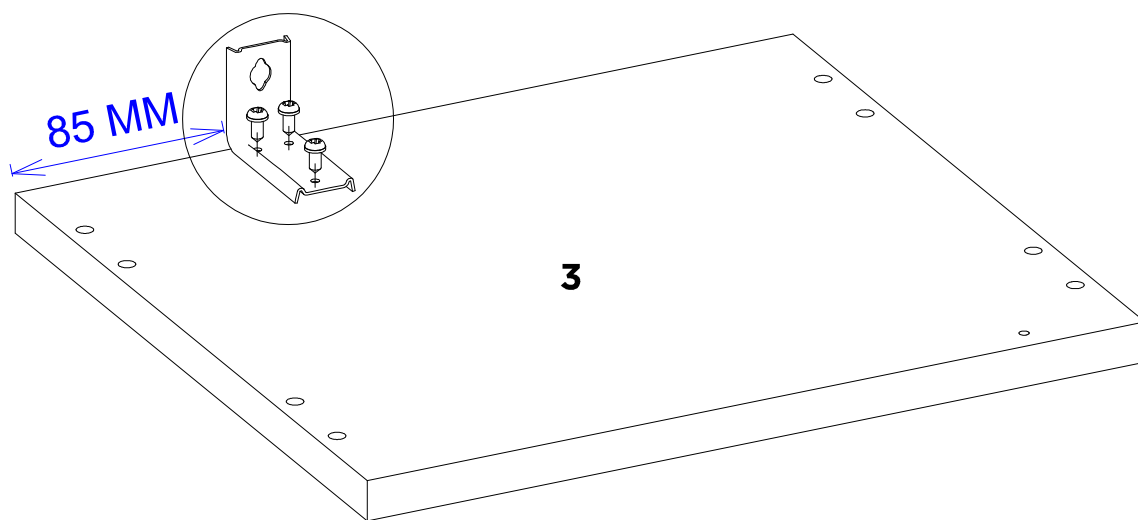
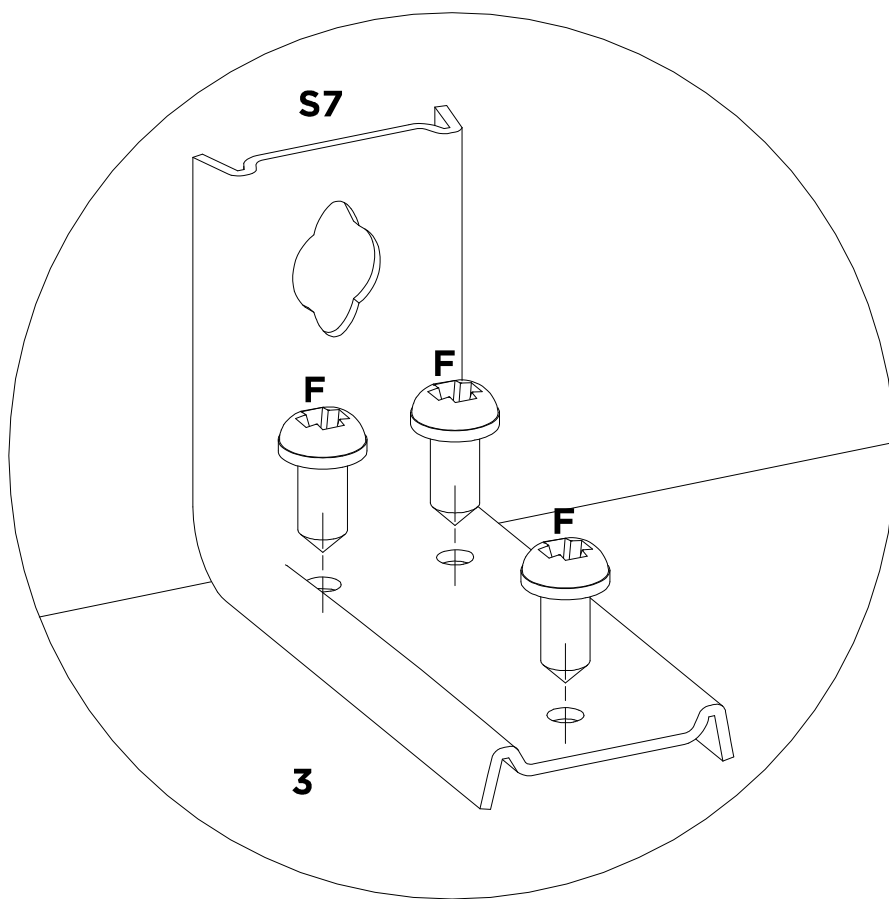

F	S7	-	-	-	-	-	-
X3	X1	-	-	-	-	-	-

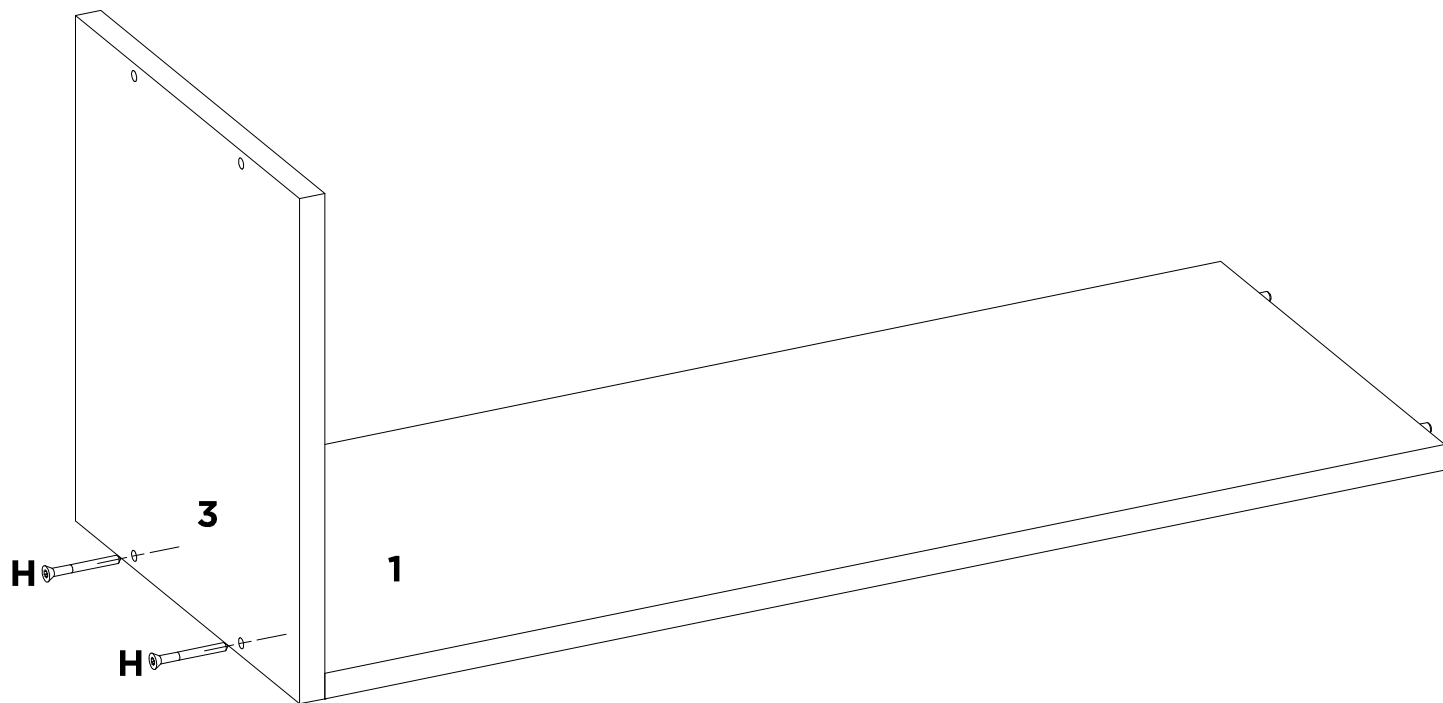

H

X2

-

-

-

-

-

-

-

-

-

-

-

-

-

-

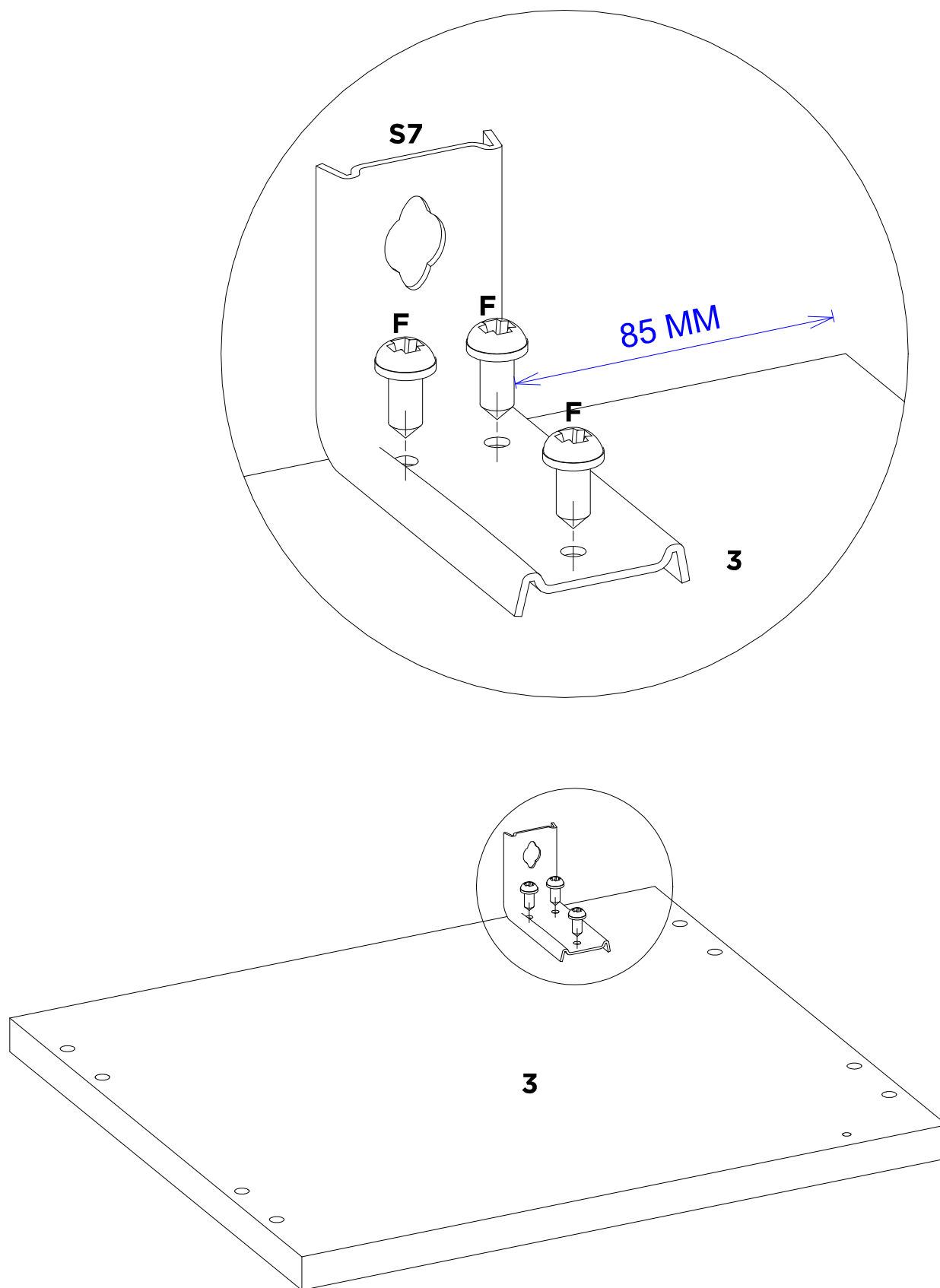

F

X3

S7

X1

-

-

-

-

-

-

-

-

-

-

-

-

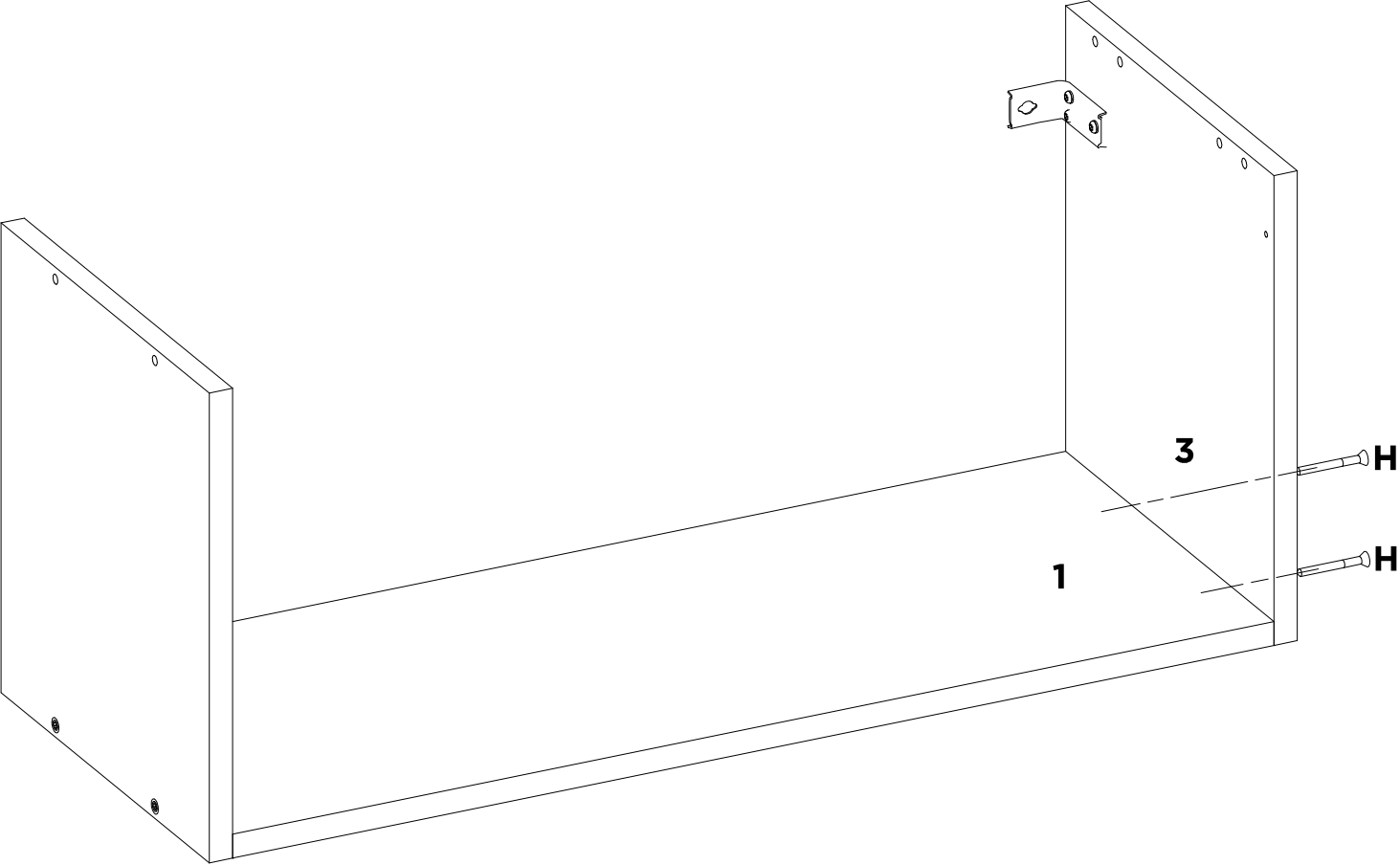

H	-	-	-	-	-	-	-
X2	-	-	-	-	-	-	-

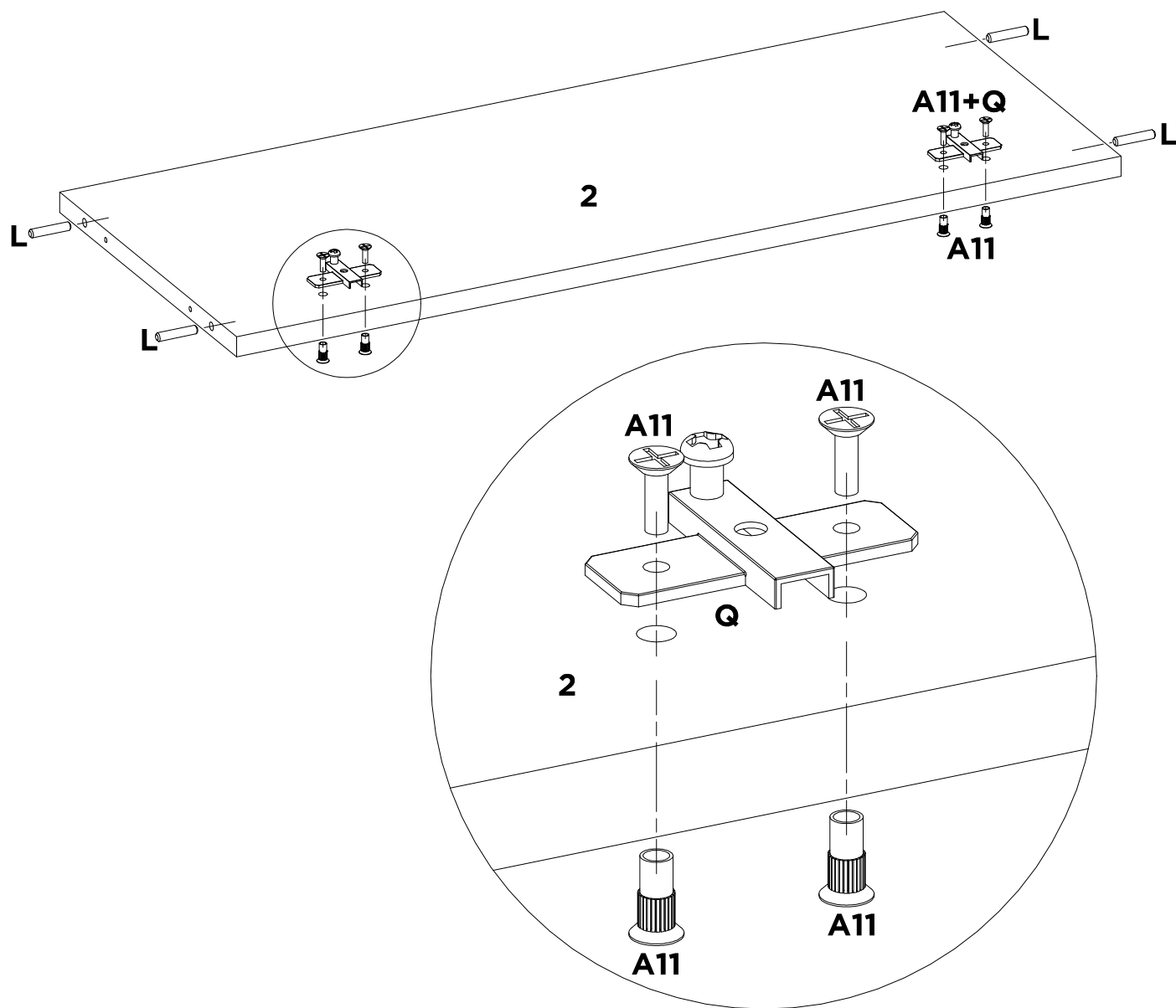

A11	L	Q	-	-	-	-	-
X4	X4	X2	-	-	-	-	-

07

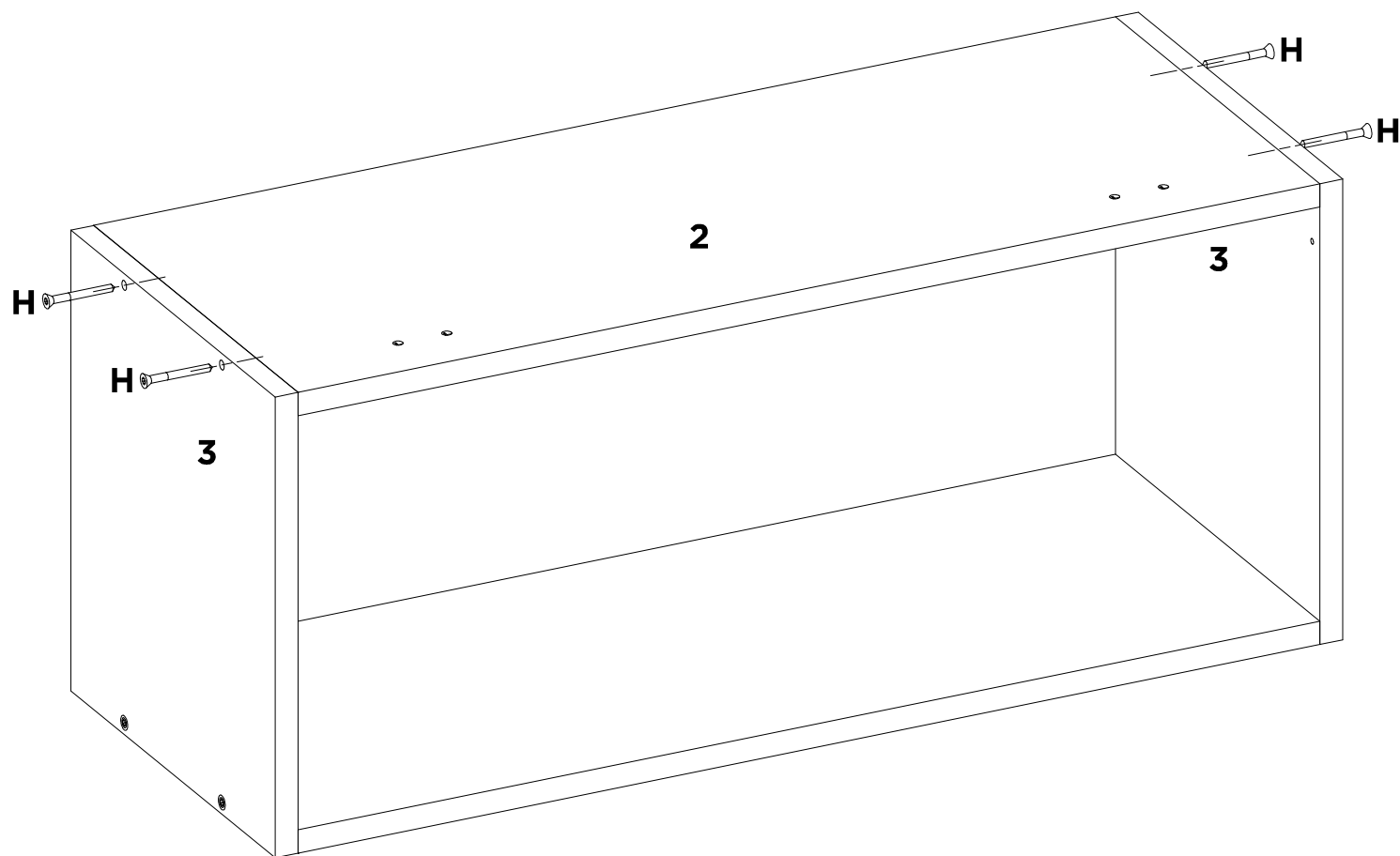

H

X4

-

-

-

-

-

-

-

-

-

-

-

-

-

-

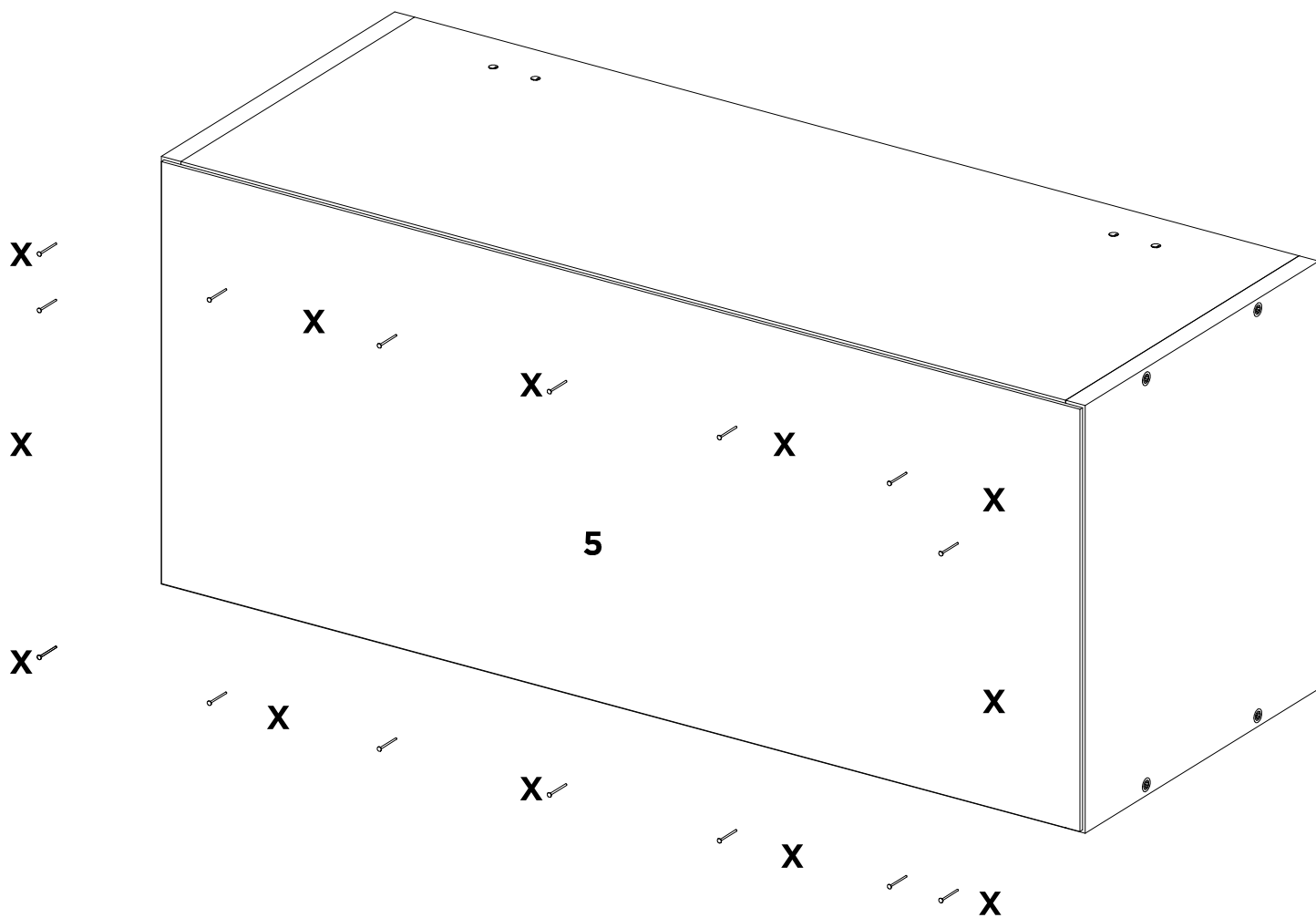

X	-	-	-	-	-	-	-
X16	-	-	-	-	-	-	-

09

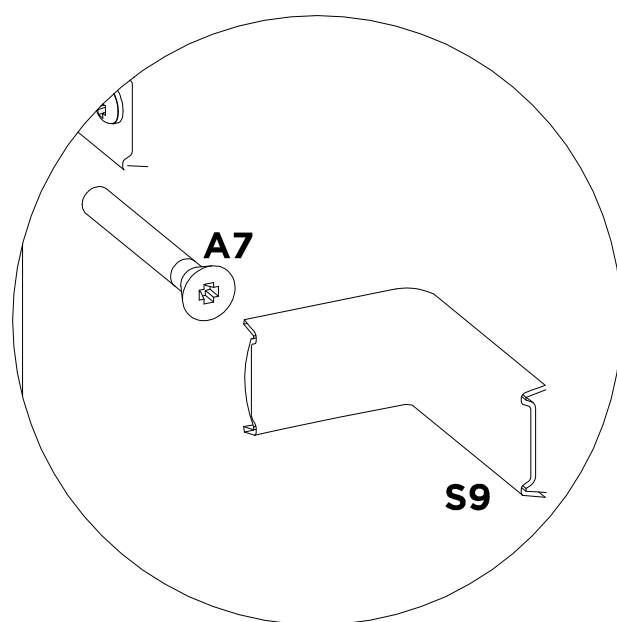
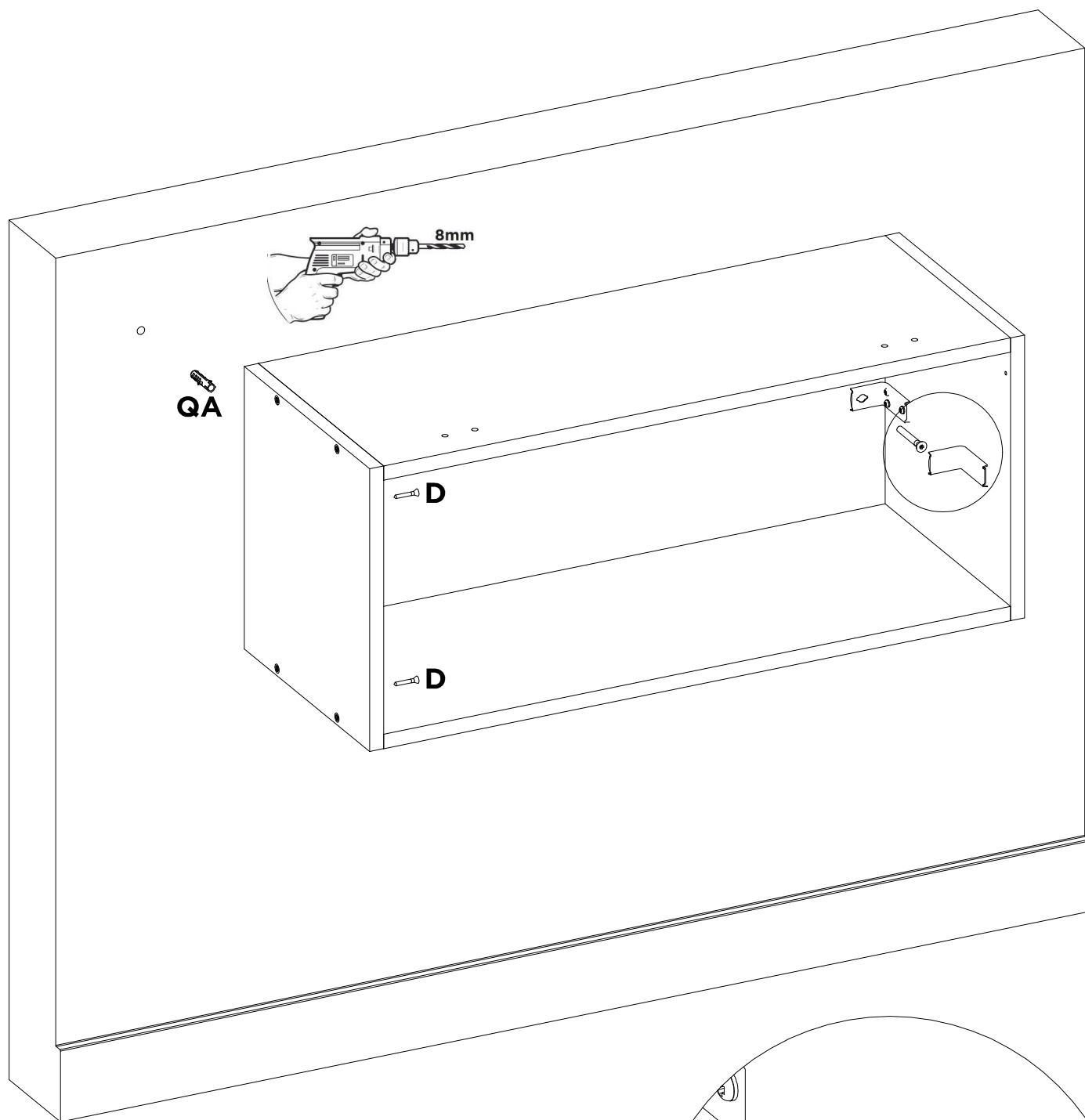

A7	QA	S9	D	-	-	-	-
X2	X2	X2	X4	-	-	-	-

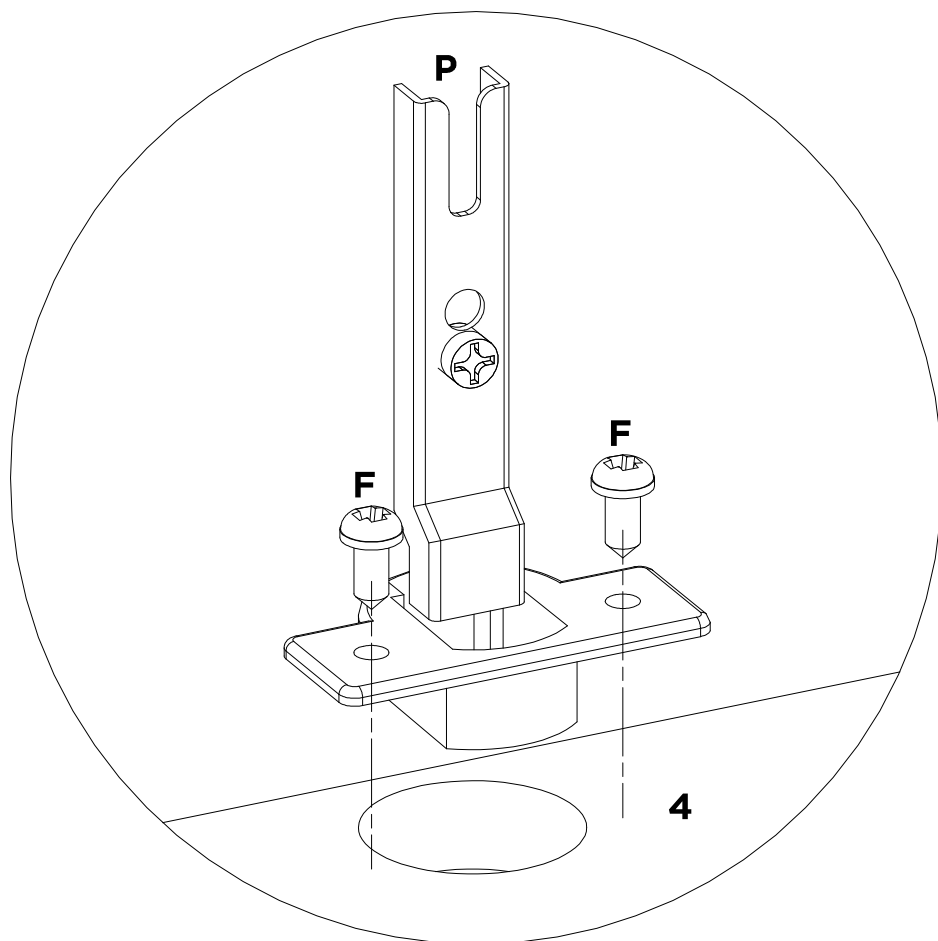

P+F

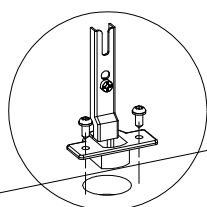
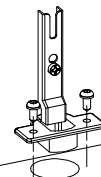

4

F

X4

P

X2

-

-

-

-

-

-

-

-

-

-

-

-

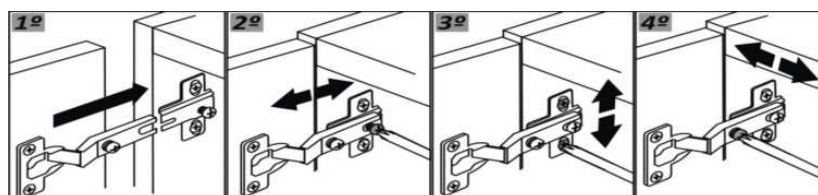
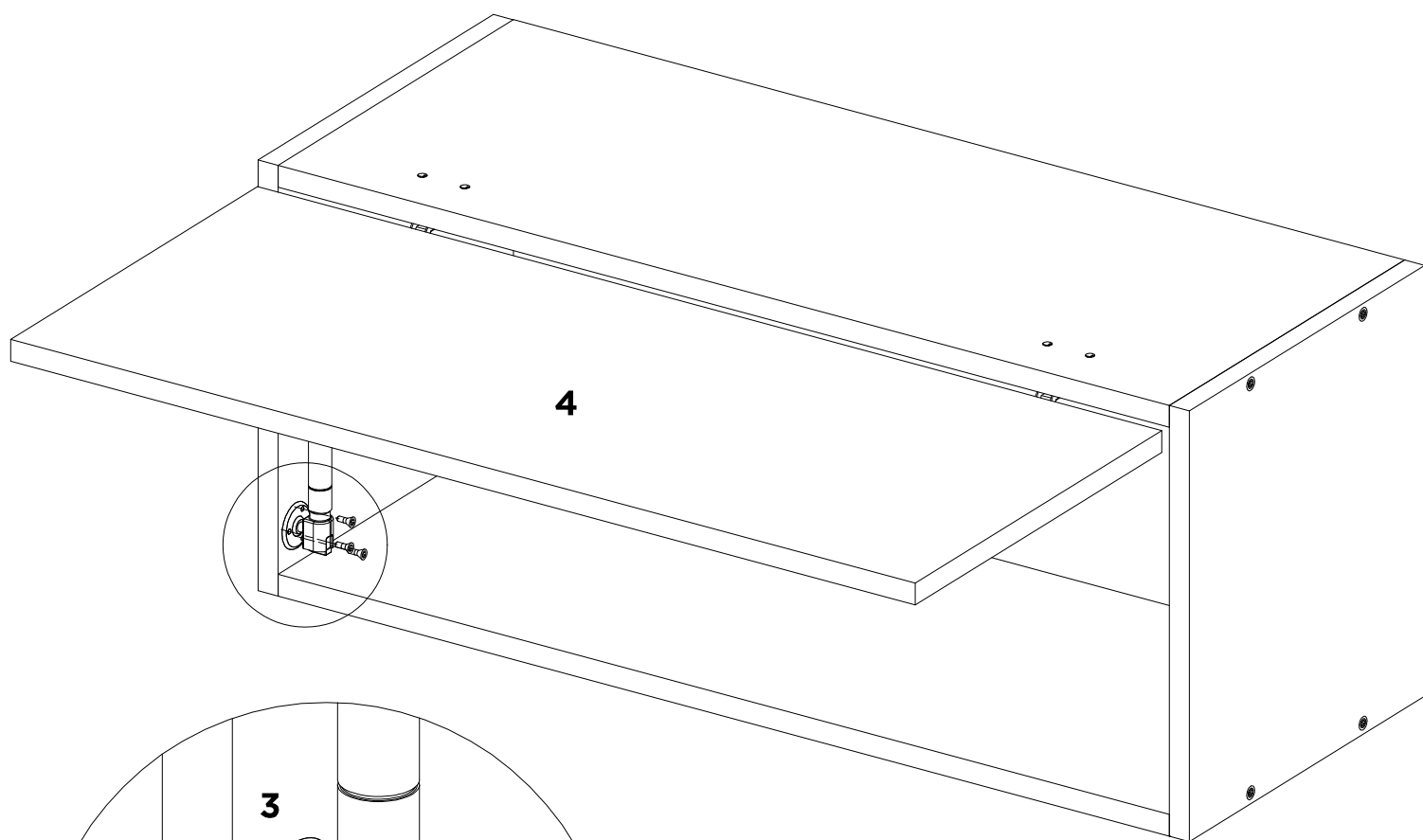

PA	GB	-	-	-	-	-	-
X1	X1	-	-	-	-	-	-

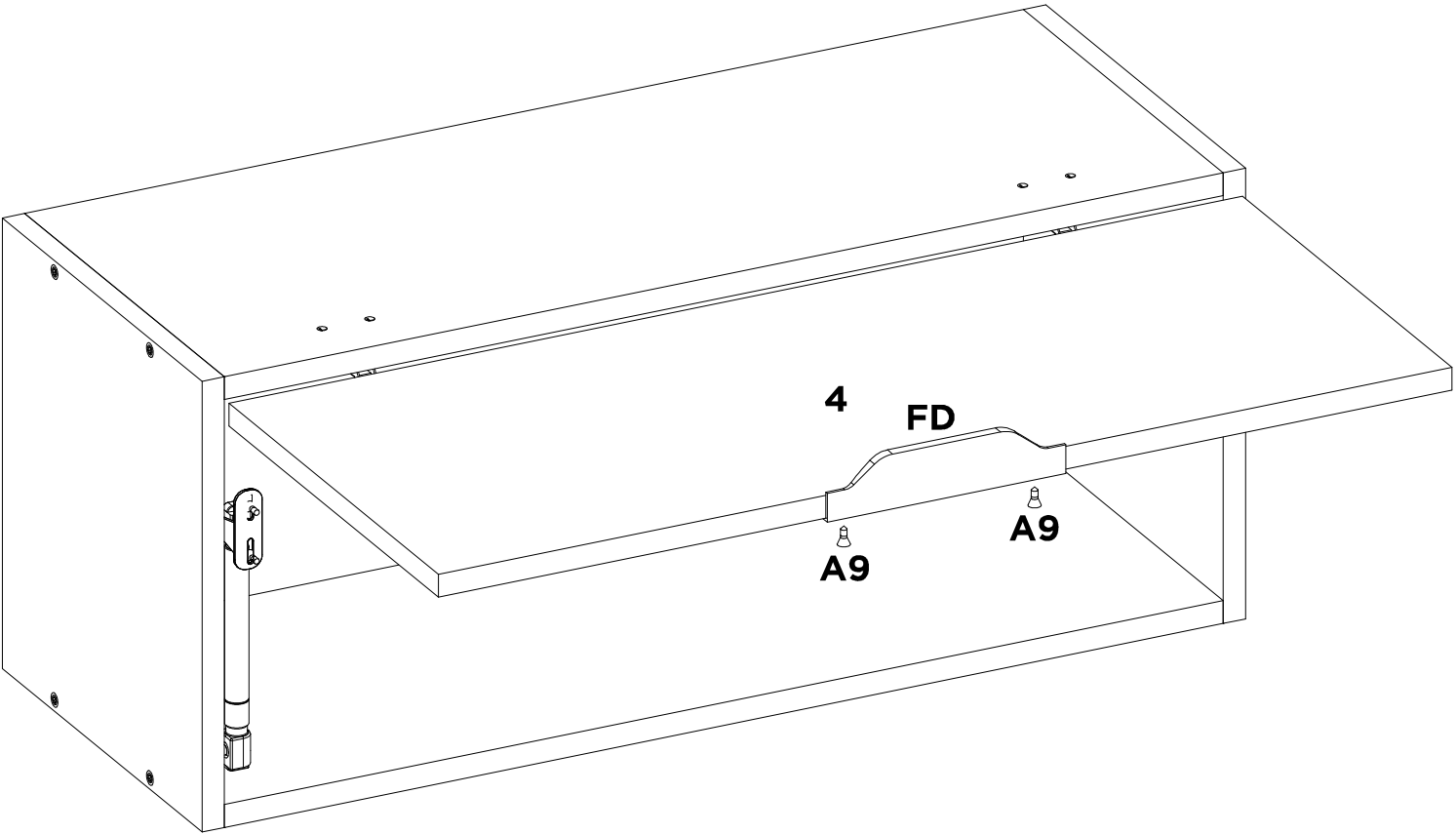

A9	FD	-	-	-	-	-	-
X2	X1	-	-	-	-	-	-

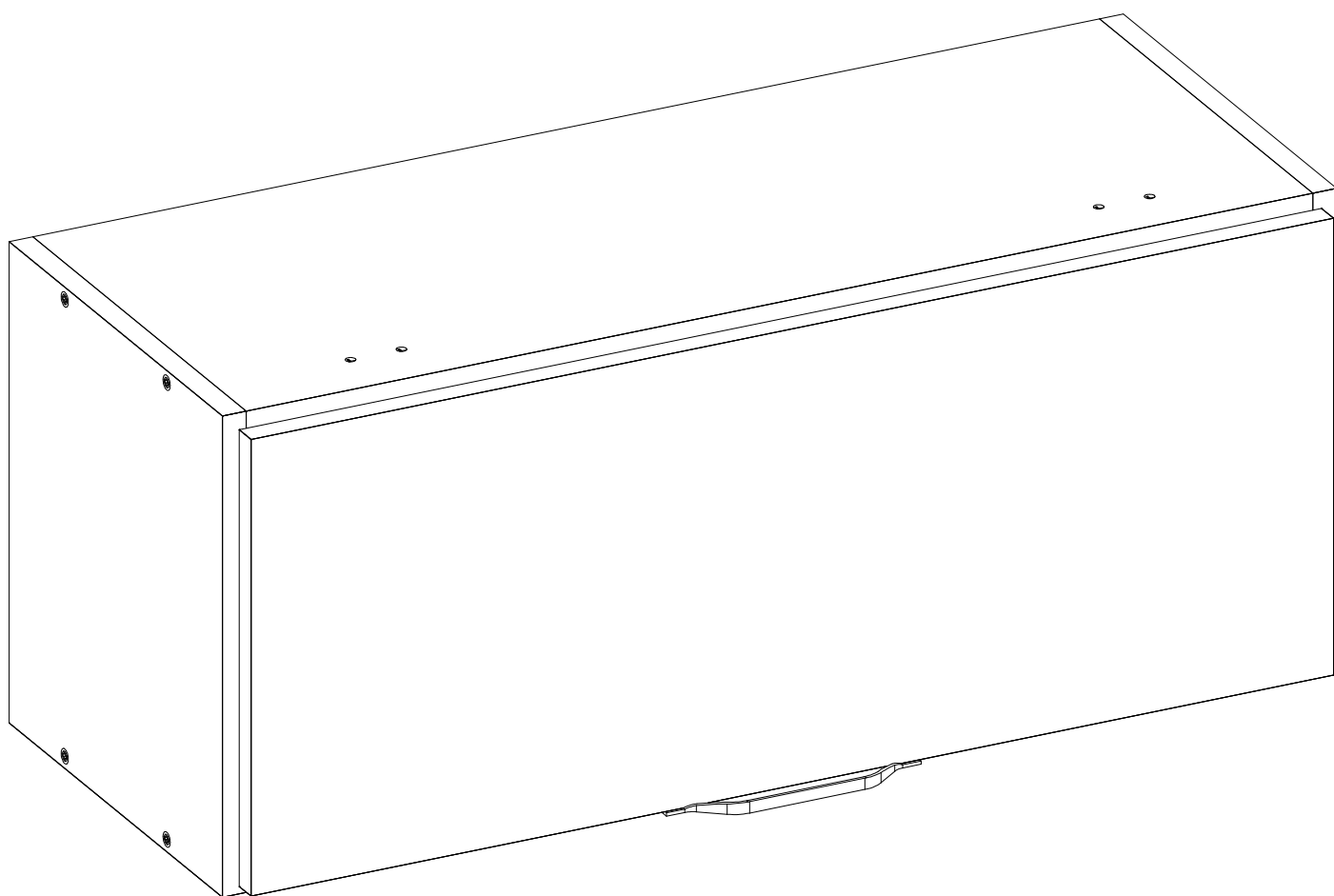
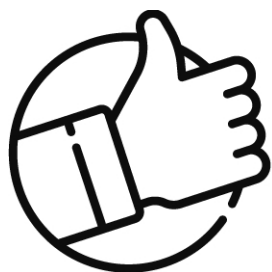

-	-	-	-	-	-	-	-
-	-	-	-	-	-	-	-



DemóBILE

MANUAL COMPLETO COMPLETE MANUAL



DEMÓBILE Indústria de Móveis Ltda.
Rua : Jurutau, 1350 - Pq. Industrial II.
Cep.: 86703-070
Arapongas - PR - Brasil
demobile@demobile.com.br

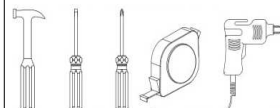

Avisos

1. Ler atentamente as instruções do manual antes de iniciar a montagem do móvel.
2. A montagem deverá ser feita em superfície limpa e plana, aconselhamos forrar o chão com a embalagem do produto, para não danificar.
3. Os parafusos devem ser apertados periodicamente.
4. Evitar batidas e contato com objetos cortantes.
5. O peso máximo de carga informado refere-se a objetos distribuídos de maneira uniforme sobre toda área de contato da peça.

Limpeza e Conservação

Efetuar a limpeza somente com pano macio limpo e seco.
Não Utilizar produtos abrasivos ou químicos.

Garantia

- 1.O fabricante responsabiliza-se apenas pelas peças do produto.
- 2.A montagem incorreta acarretará na perda da garantia e das assistências, desta forma o produto deverá ser montado por profissional qualificado.
- 3.Não estão cobertos pela garantia problemas que tenham origem na utilização inadequada do produto ou na exposição do mesmo a intempéries como: infiltrações, infestação de pragas em geral, aparecimento de mofo e outros, decorrentes do ambiente de instalação.

Assistência Técnica: Em caso de peças em assistência técnica é necessário que as mesmas sejam solicitadas junto a loja ou site no qual a compra do produto foi realizada

Warnings

1. Read the manual instructions carefully before starting to assemble the furniture.
2. The assembly must be done in clean and flat surface, we advise to put the product packaging on the floor, not to damage it during the assembling.
3. The screws must be tightened periodically.
4. Avoid hitting and contacting sharp objects.
5. The payload informed refers to the objects distributed all over the piece contact area.

Cleaning and conservation

Clean the product just with a soft, cleaned and dry cloth.
Do not use abrasive or chemicals products.

Warranty

- 1.The manufacturer is only responsible for product parts.
2. Incorrect assembling will make you lost the guarantee and assistance, in this way the product must be assembled by qualified professional.
3. It is Not covered by the warranty problems caused by an inappropriate use of the product or product exposure even in bad weather, such as: infiltrations, pest infestation in general, appearance of mold and others, caused by the installation environment.

Technical Assistance: Damaged pieces! Ask on the stores you bought it.

Advertencias

1. Lee atentamente las instrucciones del manual antes de empezar a armar los muebles.
2. El montaje debe hacerse en superficie limpia y plana, utilice el empaque del Producto para cubrir el piso
3. Los tornillos deben ser apretados periódicamente
4. Evite golpear y chocar objetos punzantes
5. El peso máximo de carga tiene relación a los objetos distribuydos sobre toda el área de contacto de la pieza.

Limpeza y conservación

Limpiar solo con un trapo suave, limpio y seco
No utilice productos abrasivos o productos químicos

Garantía

- 1.El fabricante solo es responsable a las partes del producto.
2. Armar incorrectamente supone la pérdida de garantía y repuestos, de esta manera el producto debe ser ensamblado por profesional calificado
- 3.No es garantizado problemas derivados del uso inapropiado del producto, o exposición del producto al mal tiempo, como: infiltraciones, infestación de plagas en general, aparición de moho y otros.

Asistencia técnica: en caso de piezas rotas es necesario que sea solicitadas las mismas a la tienda o sitio web donde se compró el producto.

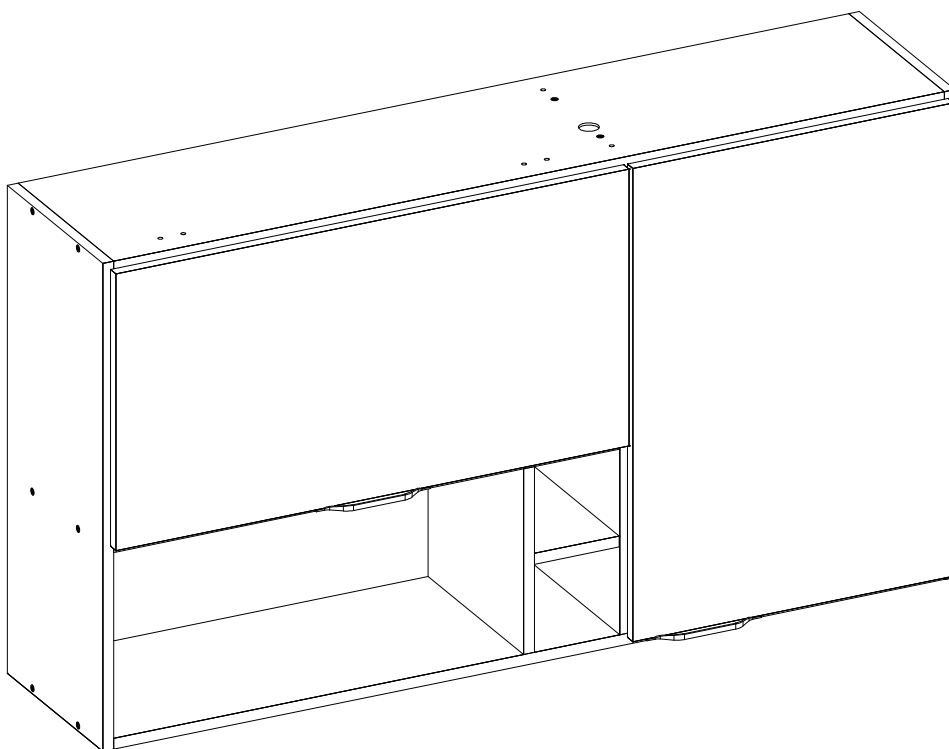

94221 ARMARIO AEREO 02 PORTAS 120 CM NICHO FIRENZE

94221 WALL CABINET 02 DOORS AND NICHE 120 CM FIRENZE

94221 ARMARIO DE PARED 02 PUERTAS Y NICHO FIRENZE

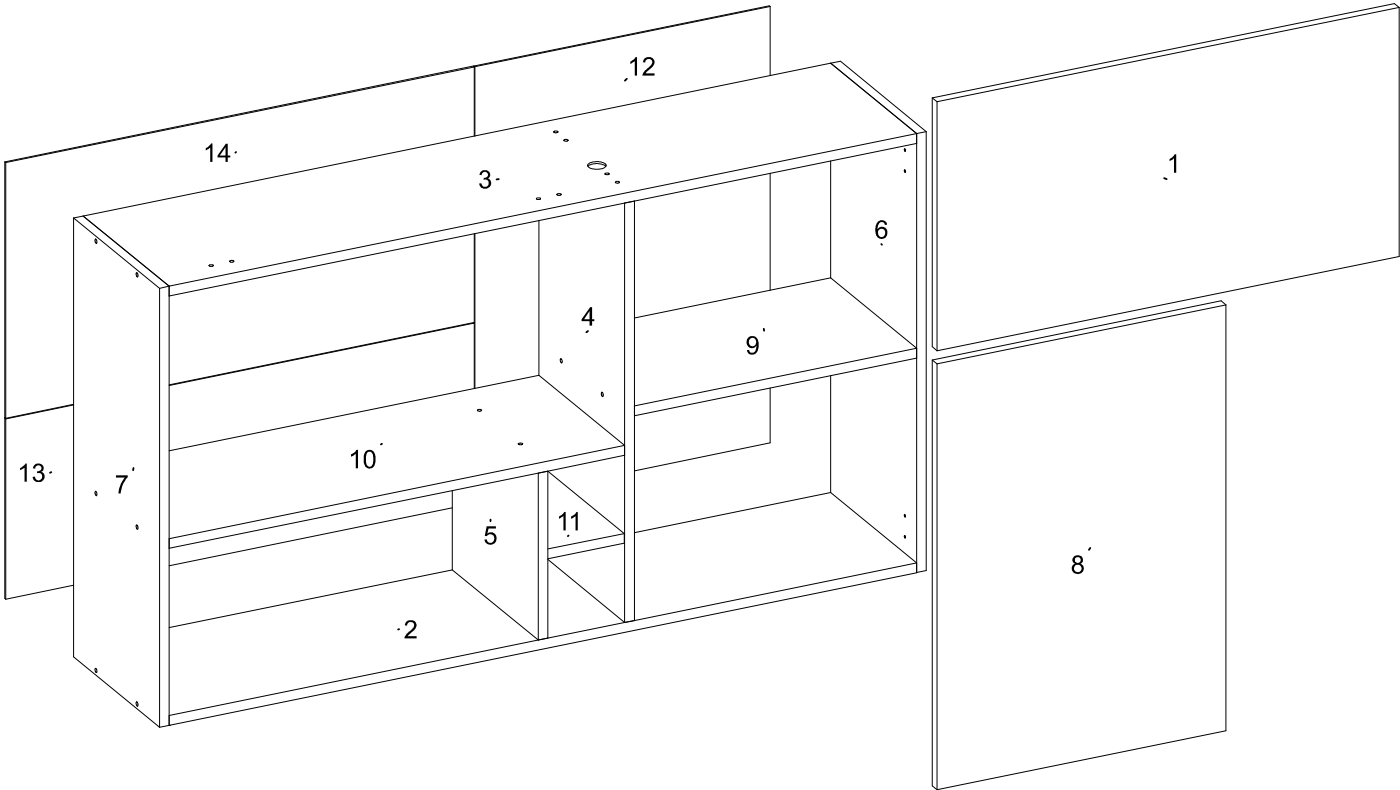

		AMENDOLA BRANCO	AVENA GRAFITO	AVENA TOUCH					DESCRIÇÃO DE PEÇAS DESCRIPTION OF PARTS DESCRIPCION DE LAS PIEZAS	DATA LANÇAMENTO: 20/01/2022 DATA ATUALIZAÇÃO: 11/02/2022	DIMENSÕES / QUANTIDADE DIMENSIONS / QUANTITY DIMENSIONES / CANTIDAD		
SEQ.	CODIGO	REF_01	REF_02	REF_03	REF_04	REF_05	REF_06	REF_07	DESCRICA0	DESCRIPTION_EN	DESCRIPCION_ES	DIMENSOES_MM	QTD
1	14414	153	163	159	-	-	-	-	PORTA BASCULANTE	TILTING DOOR	PUERTA ABATIBLE	720 X 380 X 15	1
2	03261	136	158	158	-	-	-	-	BASE	BASE	BASE	1165 X 268 X 15	1
3	07192	136	158	158	-	-	-	-	CHAPEU	TOP PANEL	TAPA SUPERIOR DEL ROPERO	1165 X 268 X 15	1
4	08449	136	158	158	-	-	-	-	DIVISAO DIREITA	RIGHT DIVISION	DIVISION DERECHA	640 X 268 X 15	1
5	08450	136	158	158	-	-	-	-	DIVISAO DO NICH0	LEFT DIVISION	RIGHT DIVIDE	268 X 255 X 15	1
6	11602	136	158	158	-	-	-	-	LATERAL DIREITA	RIGHT SIDE PANEL	LATERAL DERECHA	670 X 268 X 15	1
7	11603	136	158	158	-	-	-	-	LATERAL ESQUERDA	LEFT SIDE PANEL	LATERAL IZQUIERDA	670 X 268 X 15	1
8	14413	153	163	159	-	-	-	-	PORTA	DOOR	PUERTA	650 X 450 X 15	1
9	15268	138	157	157	-	-	-	-	PRATELEIRA MENOR	SHELF	ESTANTERIA	440 X 268 X 15	1
10	15267	138	157	157	-	-	-	-	PRATELEIRA	SHELF	ESTANTERIA	710 X 268 X 15	1
11	15269	136	158	158	-	-	-	-	PRATELEIRA EXTERNA	SHELF	ESTANTERIA	266 X 120 X 15	1
12	20600	138	157	157	-	-	-	-	TRASEIRO	BACK PANEL	TRASERO	666 X 460 X 3	1
13	20602	138	157	157	-	-	-	-	TRASEIRO DO NICH0	BACK PANEL	TRASERO	730 X 275 X 3	1
14	20605	138	157	157	-	-	-	-	TRASEIRO SUPERIOR AEREO	BACK PANEL	TRASERO	730 X 390 X 3	1

LISTA DE ACESSORIOS / LIST OF ACCESSORIES / LISTA DE ACCESORIOS					
SEQ.	CODIGO.	DESCRIÇÃO	DESCRIPTION_EN	DESCRIPCION_ES	QTD.
-	01445	KIT DE ACESSORIOS	KIT OF ACCESSORIES	KIT DE ACCESORIOS	1
A11	9905036	PARAFUSO 6,0 X 15 MM MM UNIAO CHATO ZB PHILIPS	FLANGE SCREW PHILIPS	TORNILLO REBORDEADO PHILIPS	4
A7	9905027	PARAFUSO 6 X 50 MM CHATA PHILIPS	PHILIPS FLAT HEAD SCREW	TORNILLO CHATA PHILIPS	4
A9	9905006	PARAFUSO 4 X 12 MM CHATA PHILIPS	PHILIPS FLAT HEAD SCREW	TORNILLO CHATA PHILIPS	4
D	9905018	PARAFUSO 3.5 X 25 MM CHATA PHILIPS	PHILIPS FLAT HEAD SCREW	TORNILLO CHATA PHILIPS	4
F	9905007	PARAFUSO 4 X 12 MM PANELA PHILIPS	PANHEAD SCREW	TORNILHO CABEZERA DE OLHA	24
FD	9904049	PUXADOR COVER F 128 MM	HANDLE	TIRADOR	2
H	9905015	PARAFUSO 4.5 X 45 MM CHATA PHILIPS	PHILIPS FLAT HEAD SCREW	TORNILLO CHATA PHILIPS	24
L	9920011	CAVILHAS 6 X 30 MM	WOODEN PEG	CLAVIJA DE MADERA	28
P	9920020	DOBRADICA ALTA 26 MM ESTAMPADA	HINGE	BISAGRA	4
PA	9920091	PISTAO A GAS 60N	GAS PISTON	PISTON DE GAS	1
Q	9920005	CALCO DOBRADICA 5 MM	CHOCK	CALCE	4
QA	9920056	BUCHA PLASTICA 8MM CINZA	PLASTIC PIPE BUSHING 8 MM GREY	BUJE PLASTICO 8MM GRIZ	4
S	9920026	FIXADOR DE FUNDO 10 X 10 MM	BOOTOM FASTENER	FIJADOR DE FONDO	12
S7	9920055	SUPORTE FIXACAO AEREO 45 MM ZB	FIXACAO AIR SUPPORT	SUPORTE FIXACAO AÉREO	4
S9	9924020	PROTECAO SUPORTE AEREO 45MM PLASTICO	OVERHEAD SUPORT PROTECTION 45MM	PROTECCIÓN DEL SOPORTE AEREO 45MM PLASTICO	4
X	9906002	PREGO 9X9 MM	NAIL	CLAVO	60



Acessórios/Accessories/Acessórios	FD	A9	A11	A7	F	H	S	
	L	P	Q	PA	QA	S7	S9	X
	D							

01

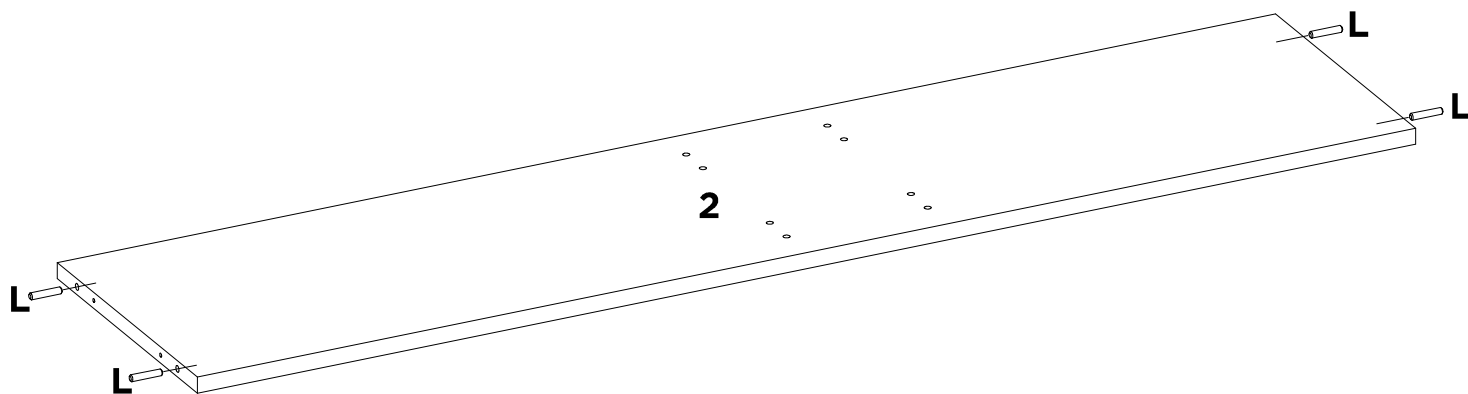

L	-	-	-	-	-	-	-
X4	-	-	-	-	-	-	-

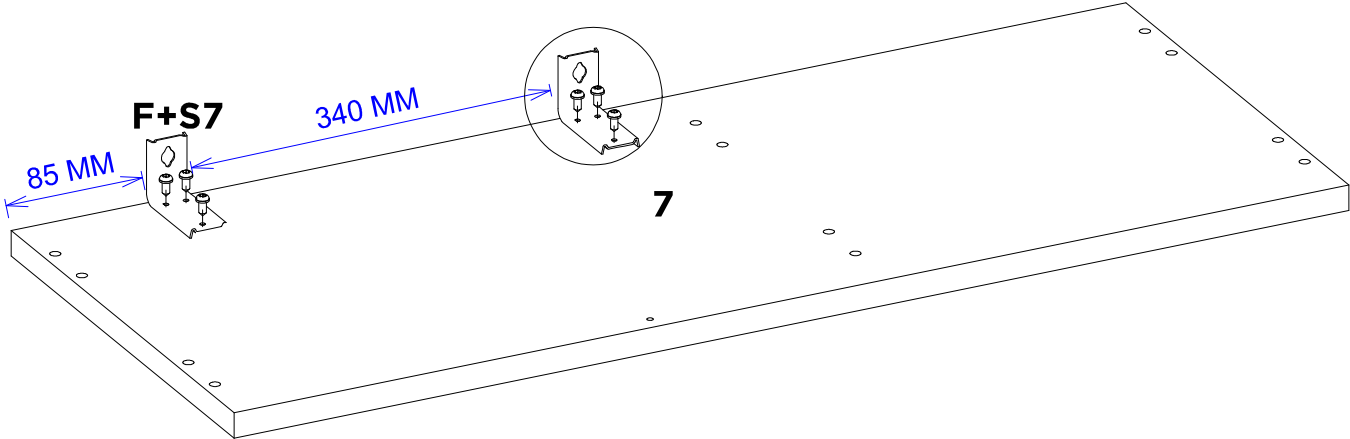
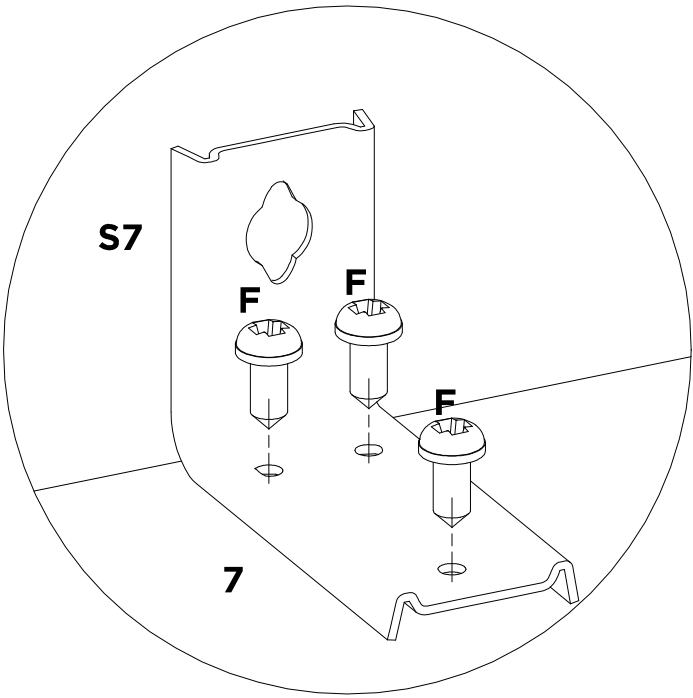

F	S7	-	-	-	-	-	-
X6	X2	-	-	-	-	-	-

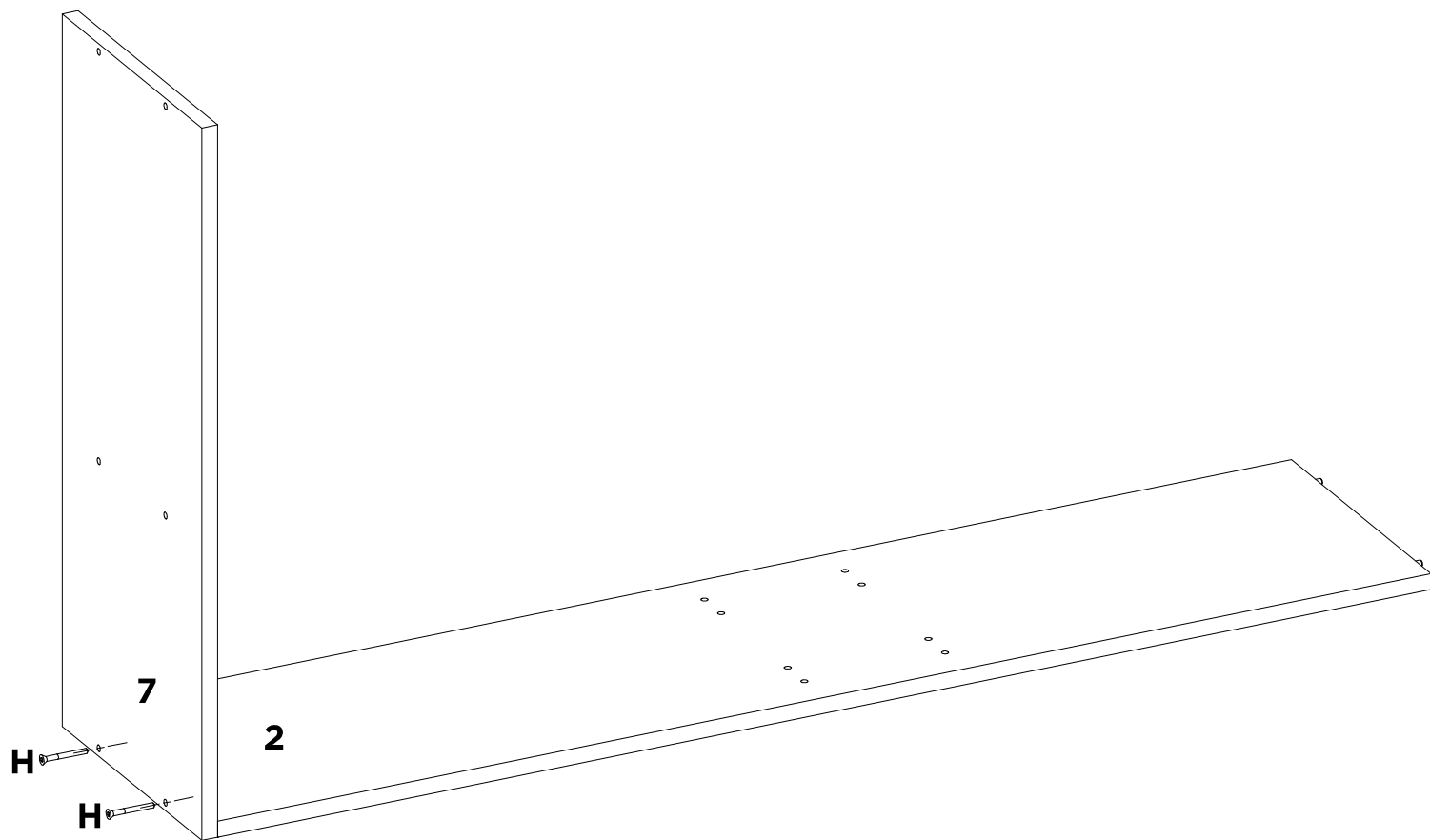

H	-	-	-	-	-	-	-
X2	-	-	-	-	-	-	-

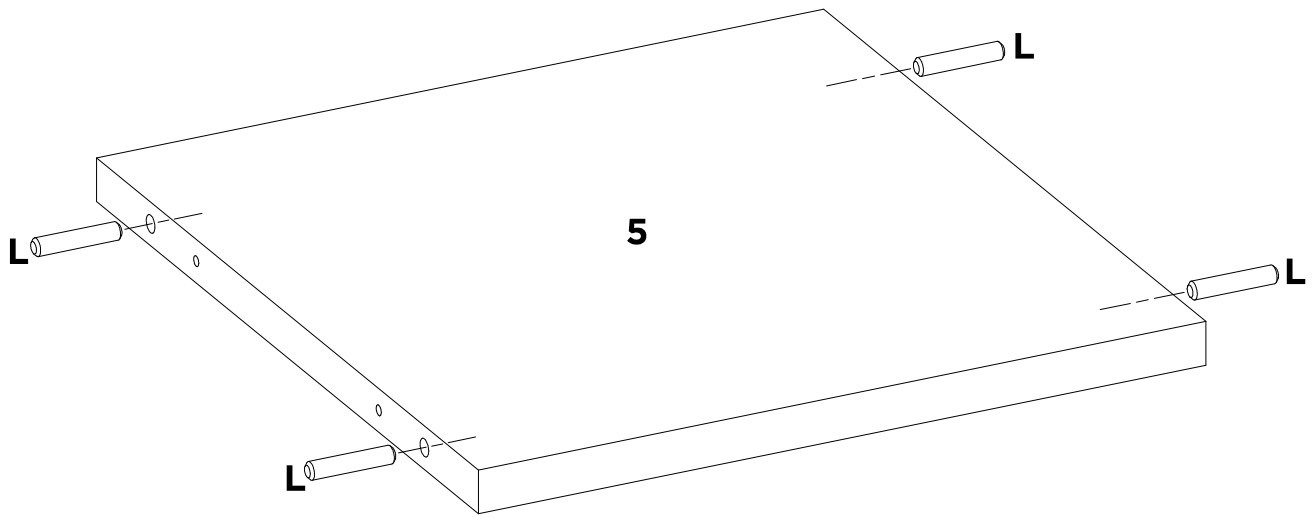

L	-	-	-	-	-	-	-
X4	-	-	-	-	-	-	-

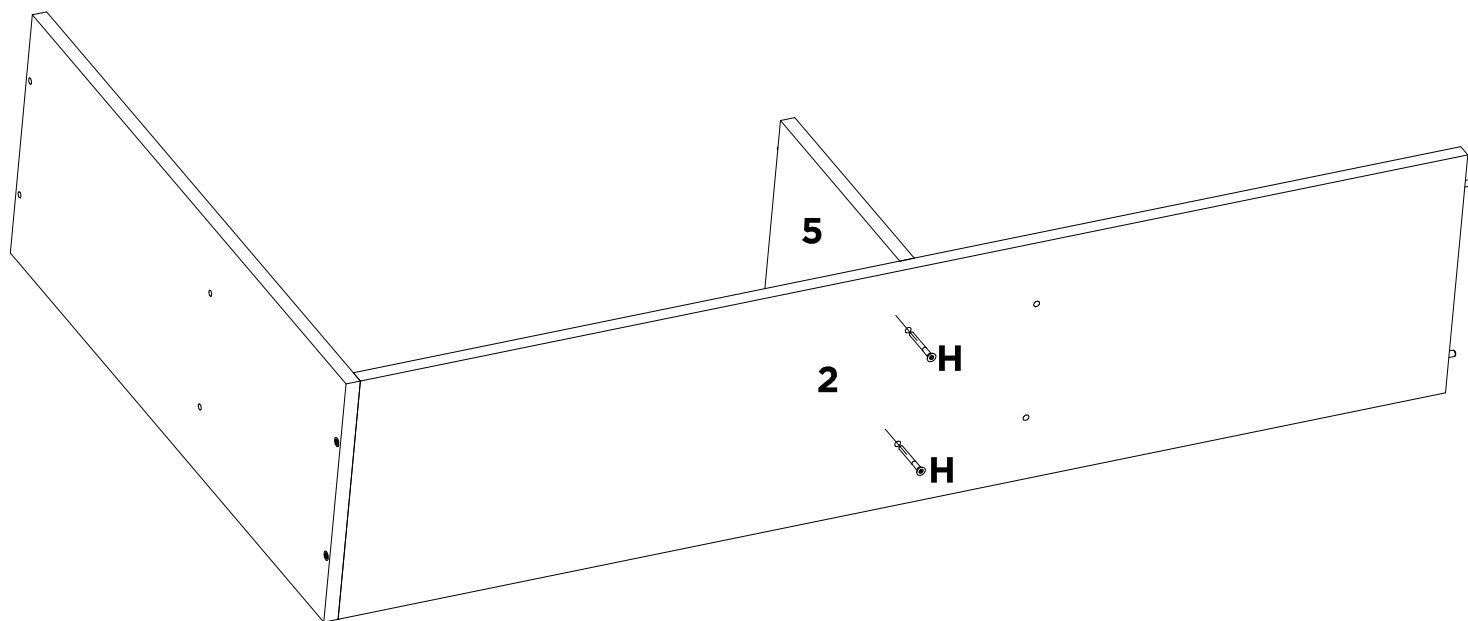

H	-	-	-	-	-	-	-
X2	-	-	-	-	-	-	-

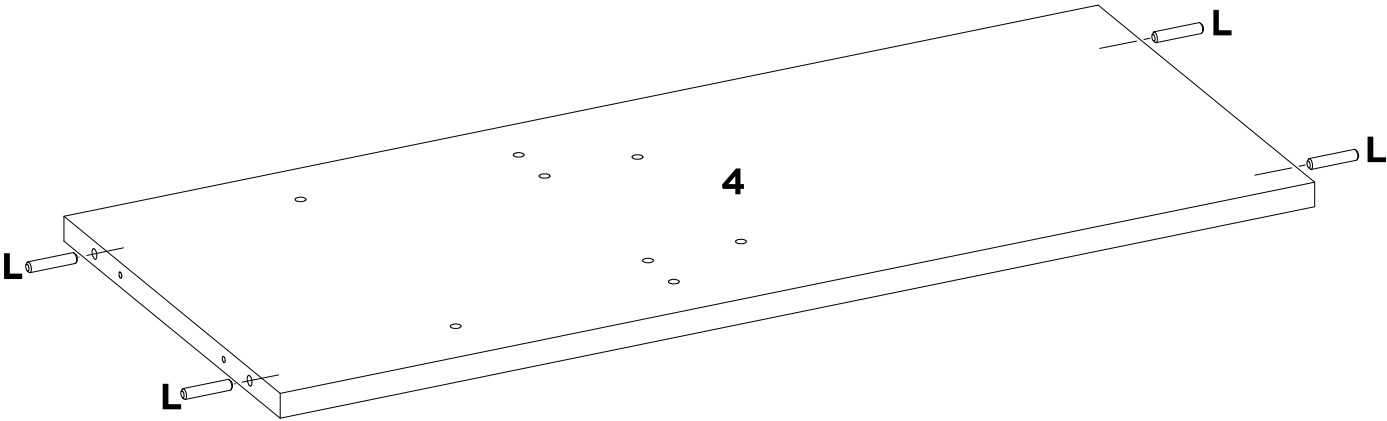

L

X4

-

-

-

-

-

-

-

-

-

-

-

-

-

-

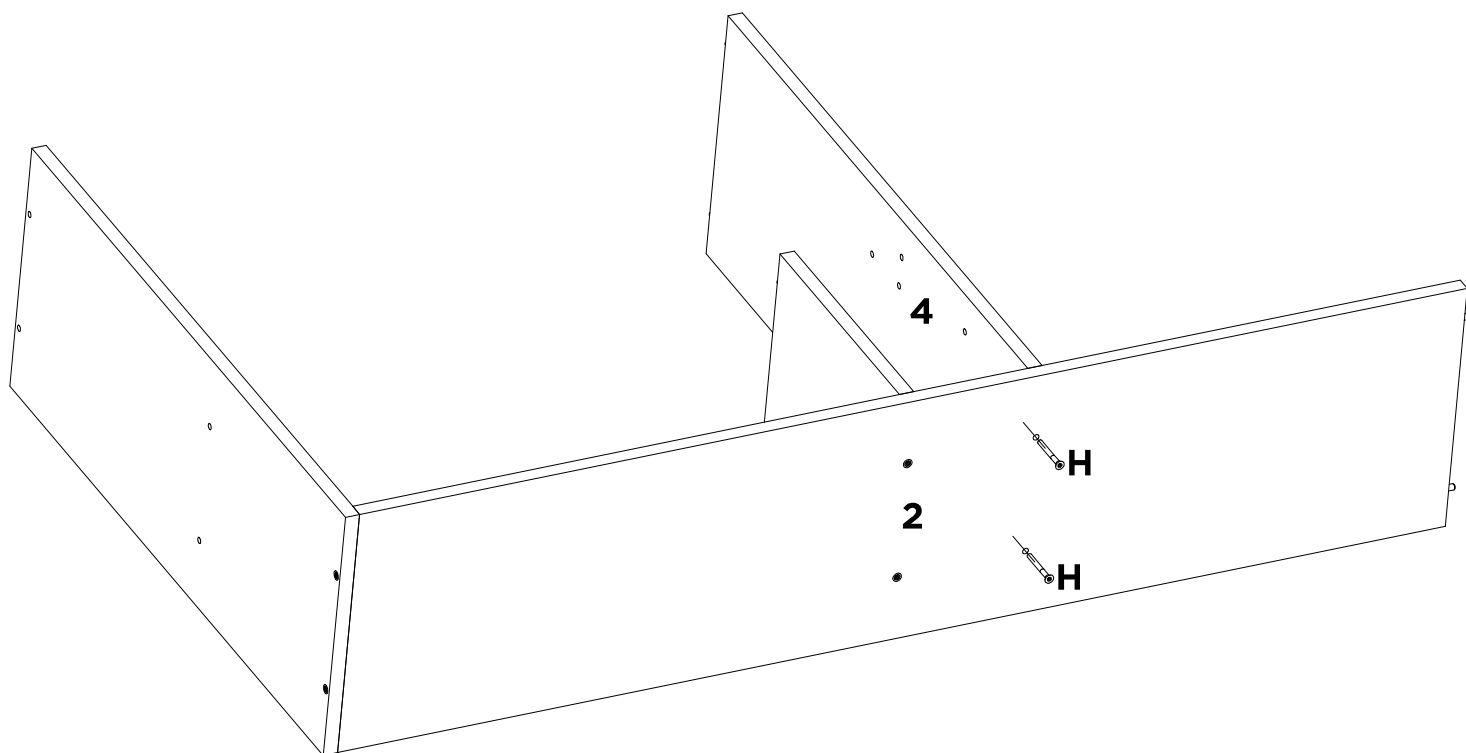

H	-	-	-	-	-	-	-
X2	-	-	-	-	-	-	-

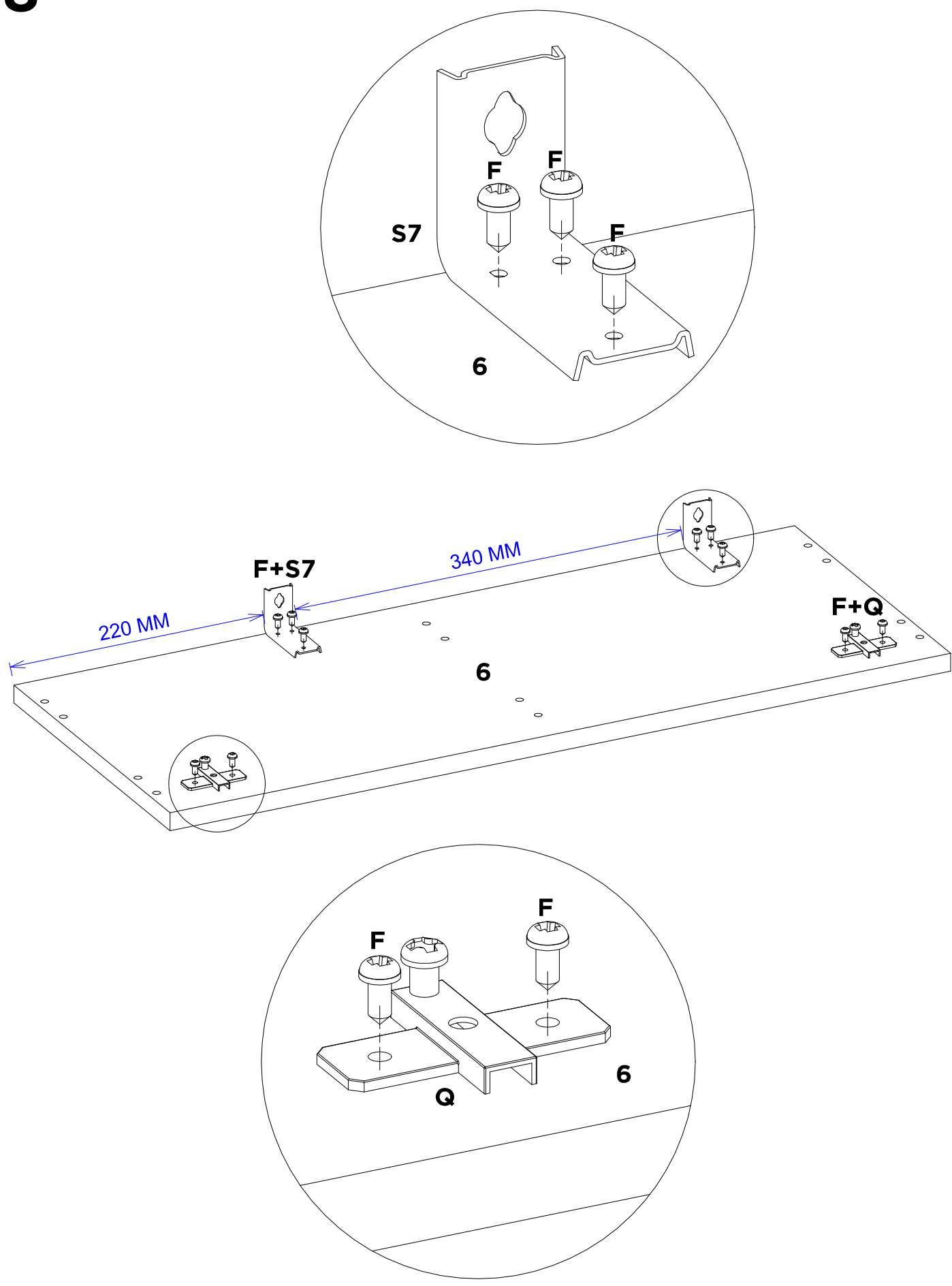

F	Q	S7	-	-	-	-	-
X10	X2	X2	-	-	-	-	-

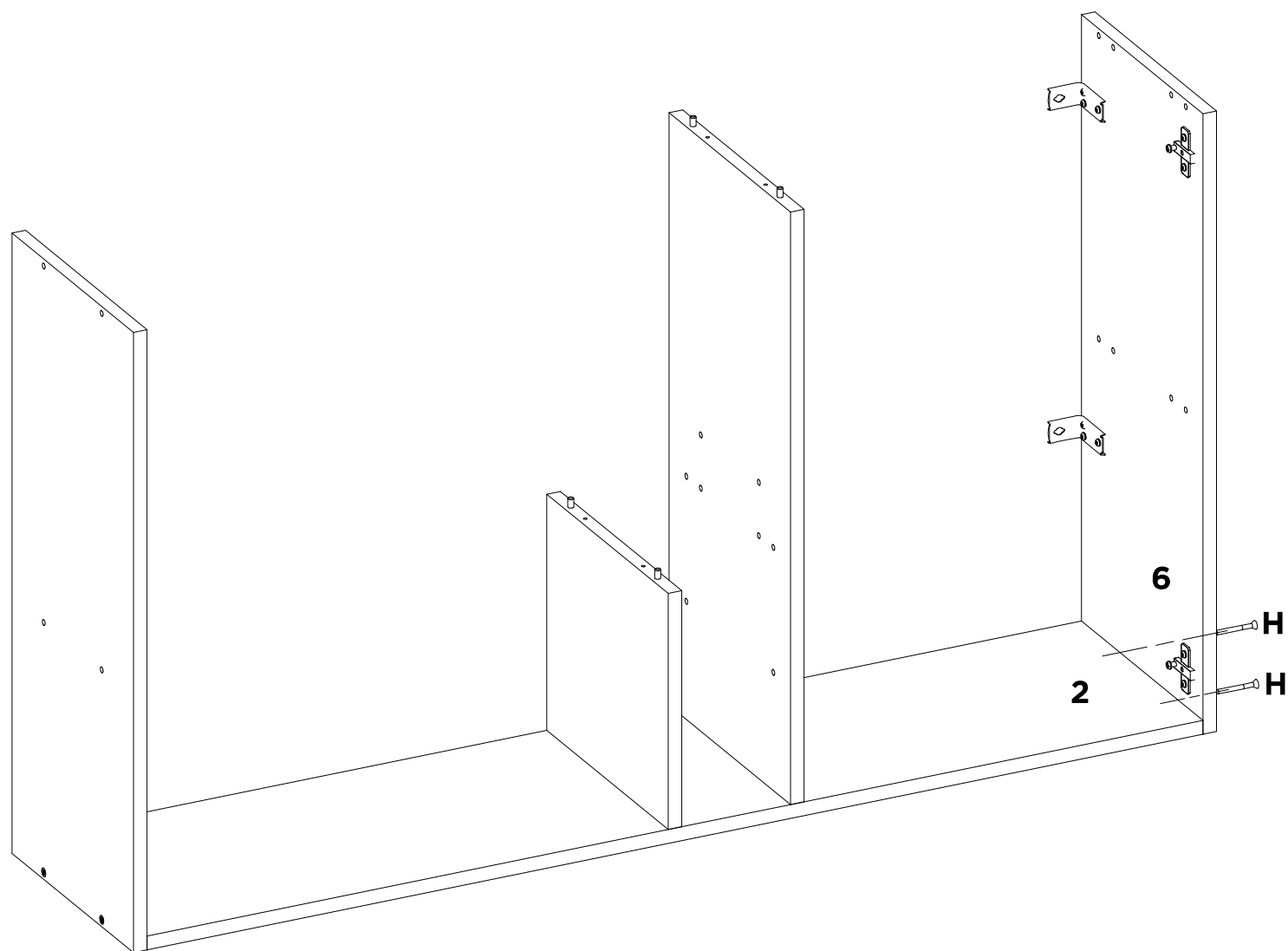

H	-	-	-	-	-	-	-
X2	-	-	-	-	-	-	-

10

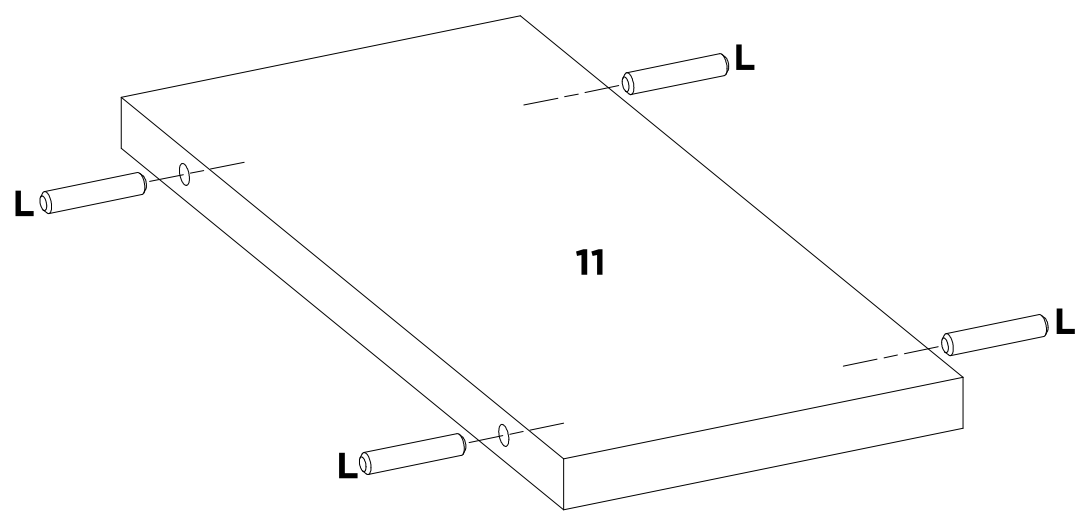

L	-	-	-	-	-	-	-
X4	-	-	-	-	-	-	-

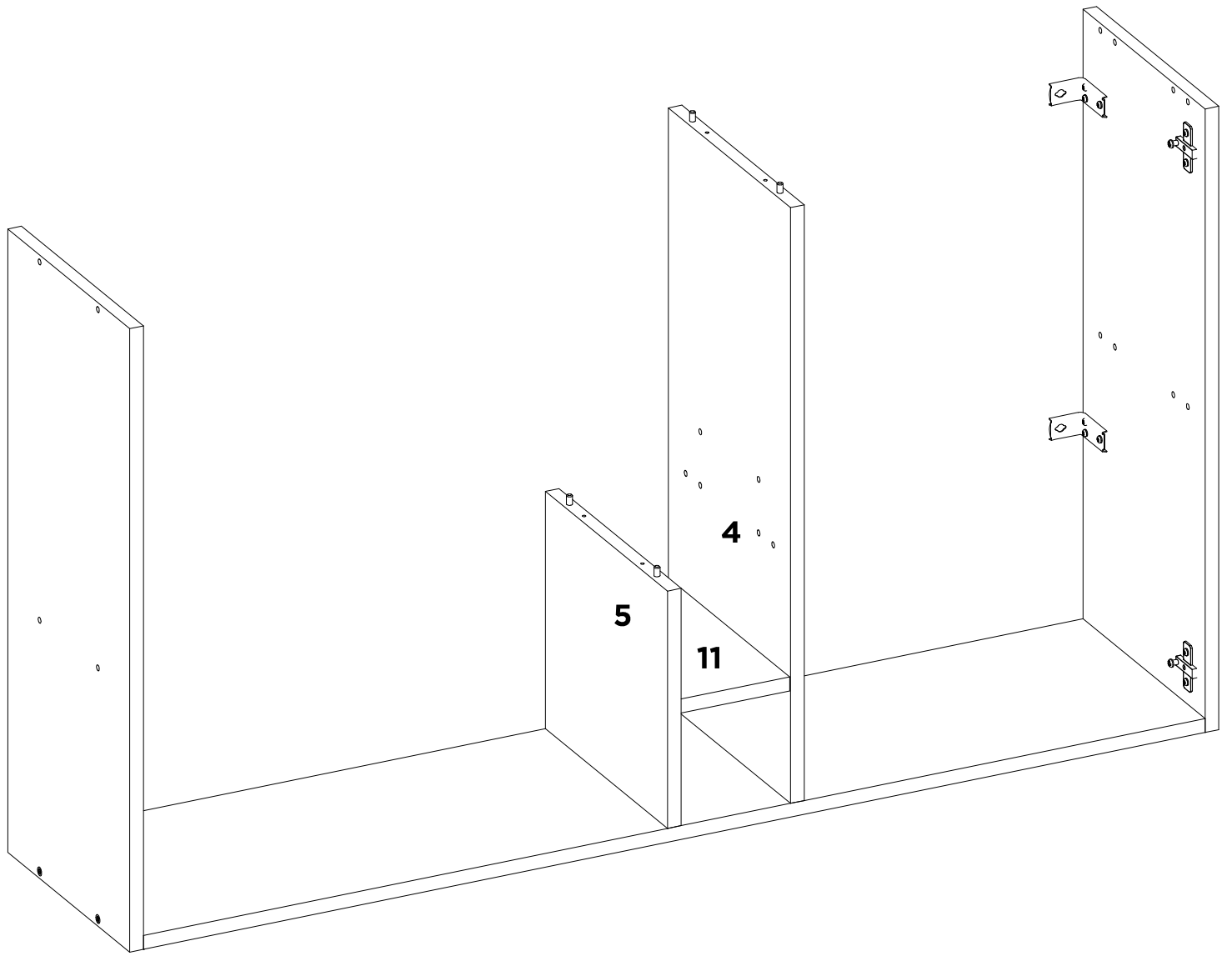

-	-	-	-	-	-	-	-
-	-	-	-	-	-	-	-

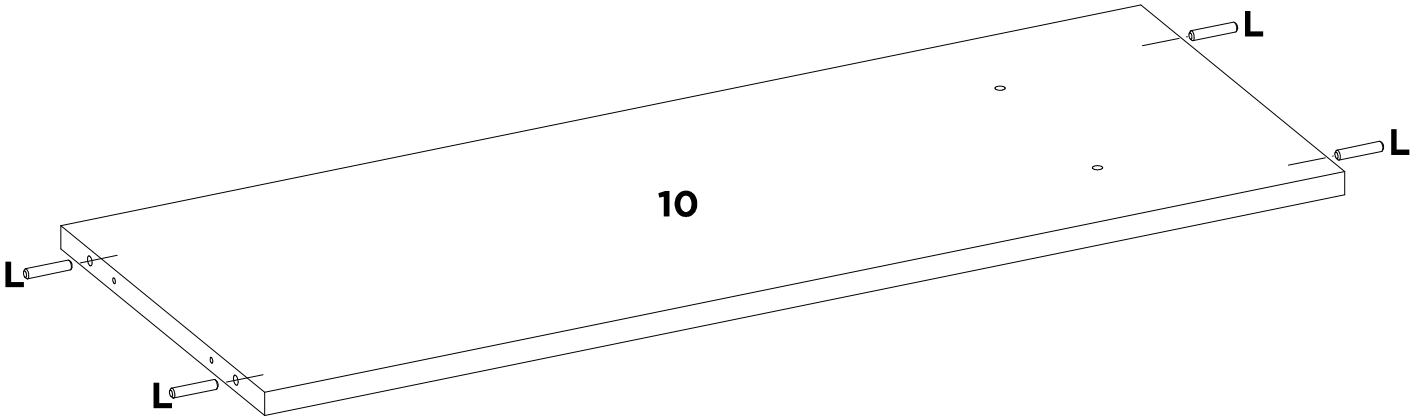

L	-	-	-	-	-	-	-
X4	-	-	-	-	-	-	-

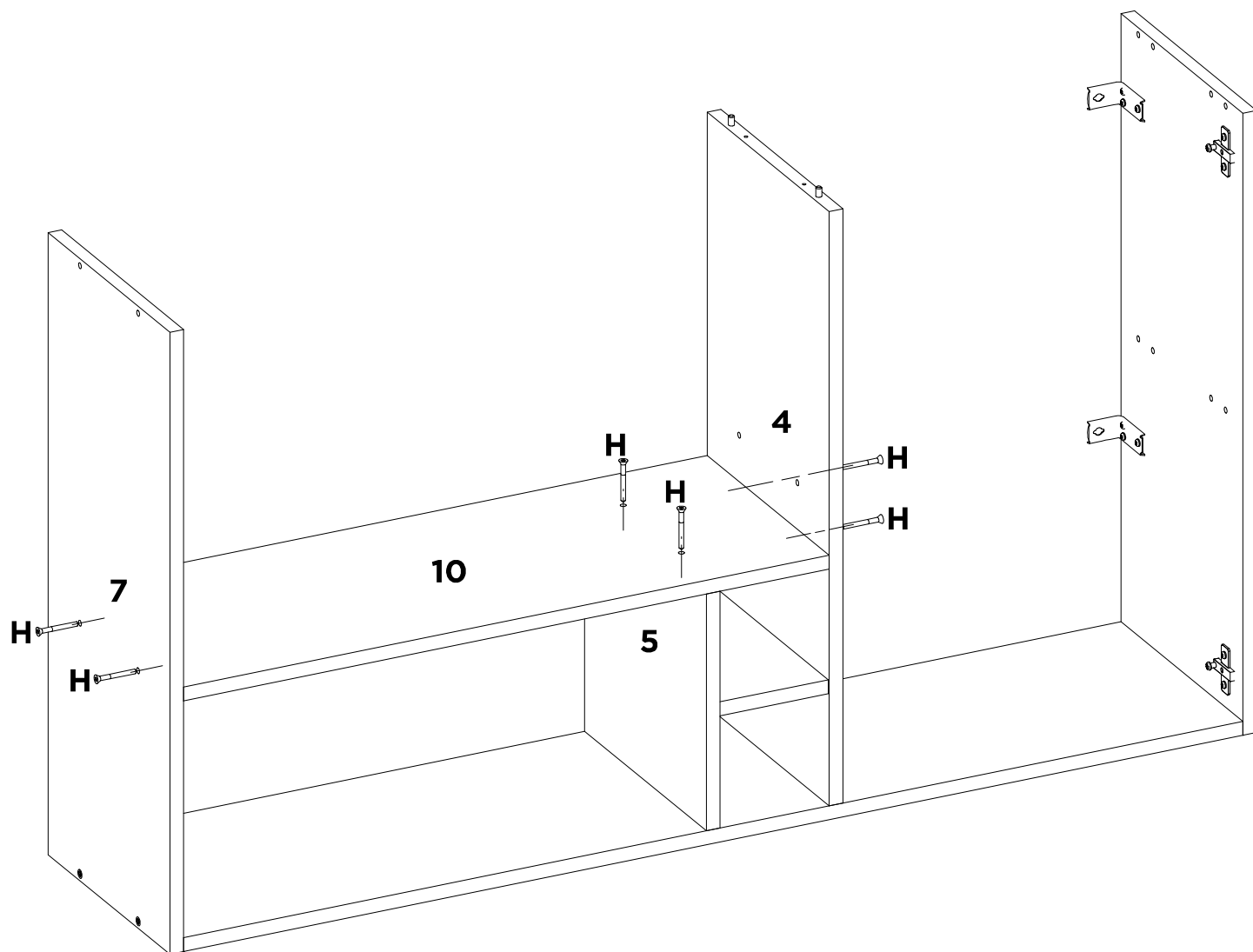

H	-	-	-	-	-	-	-
X6	-	-	-	-	-	-	-

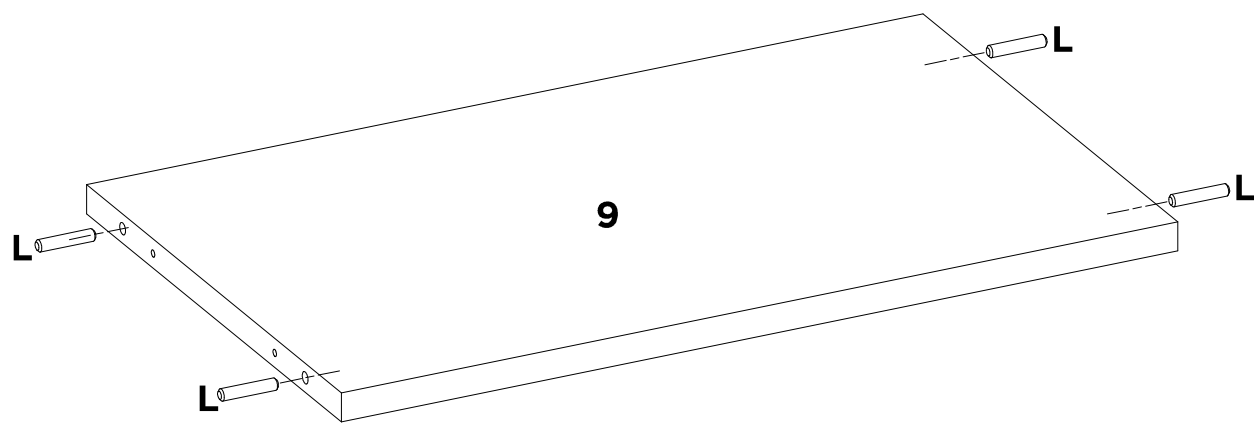

L	-	-	-	-	-	-	-
X4	-	-	-	-	-	-	-

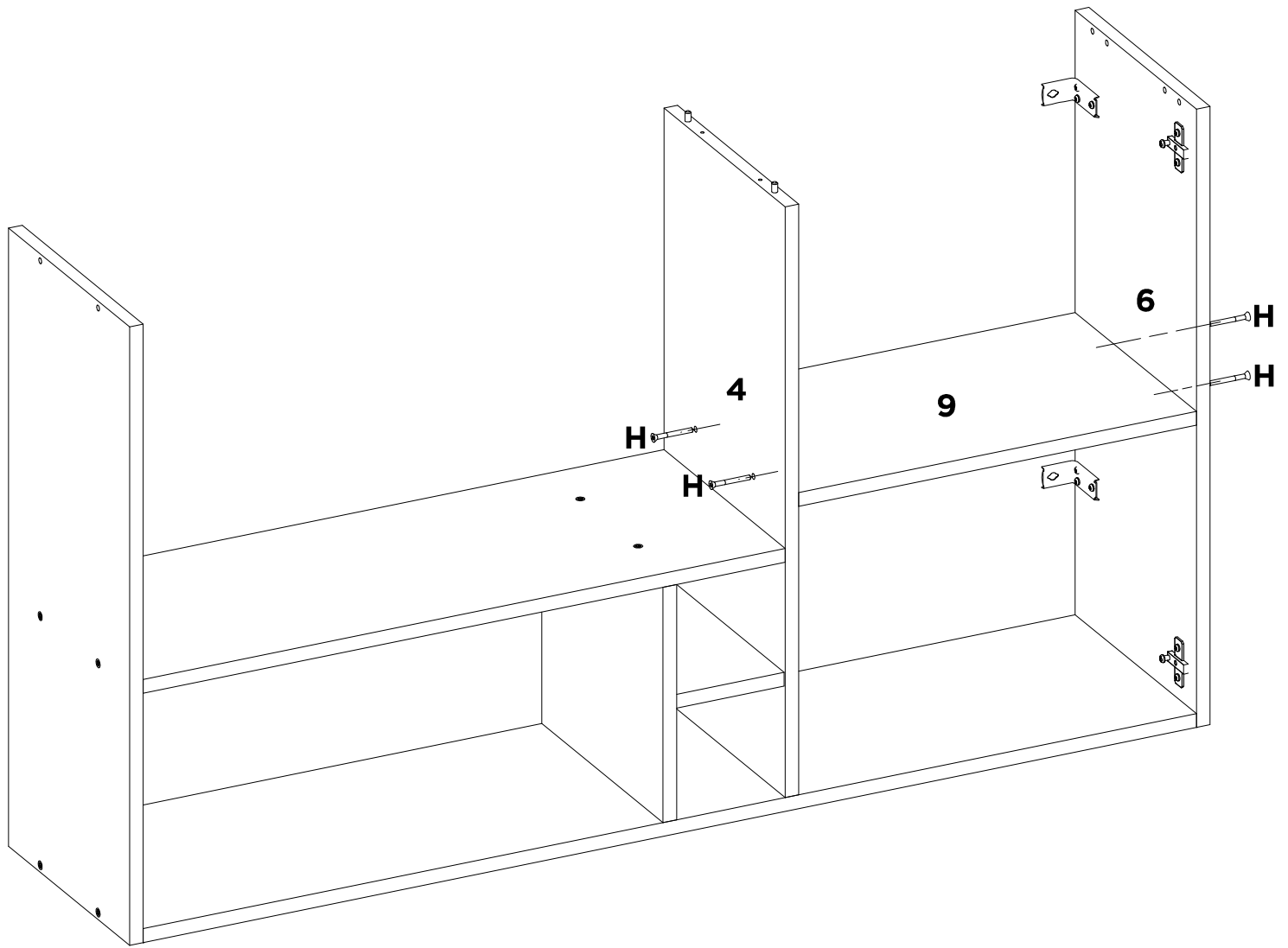

H	-	-	-	-	-	-	-
X4	-	-	-	-	-	-	-

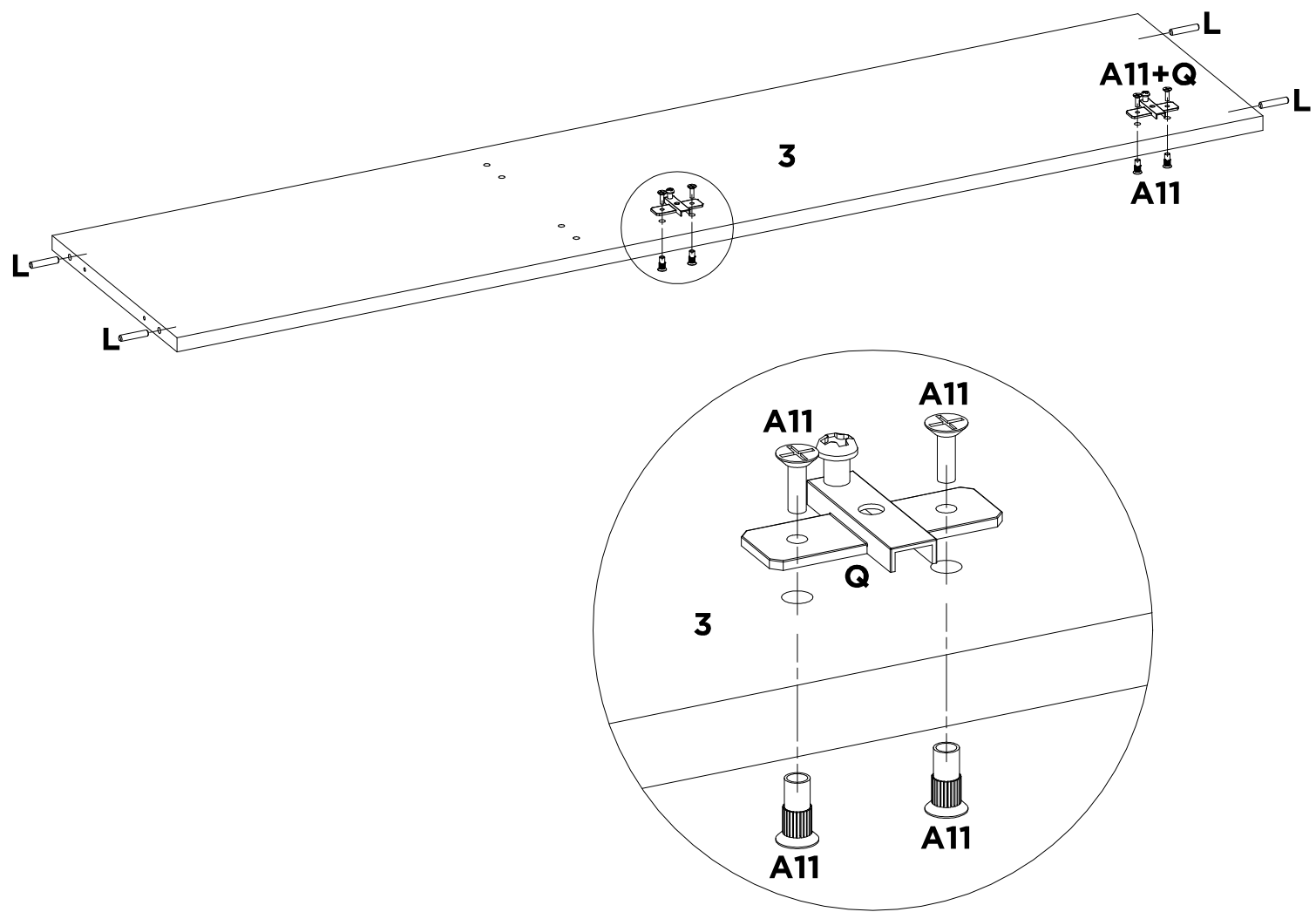

A11	L	Q	-	-	-	-	-
X4	X4	X2	-	-	-	-	-

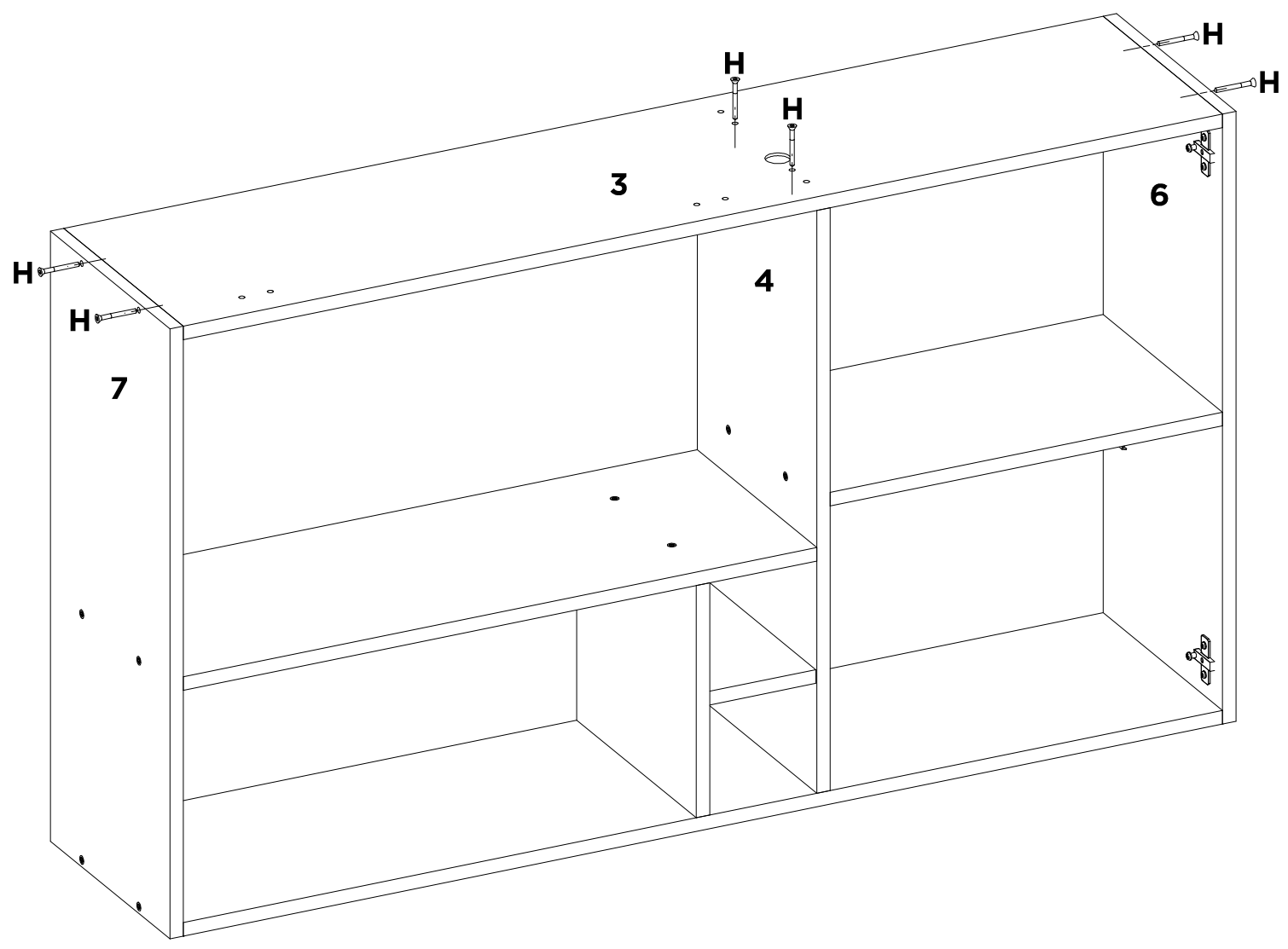

H	-	-	-	-	-	-	-
X6	-	-	-	-	-	-	-

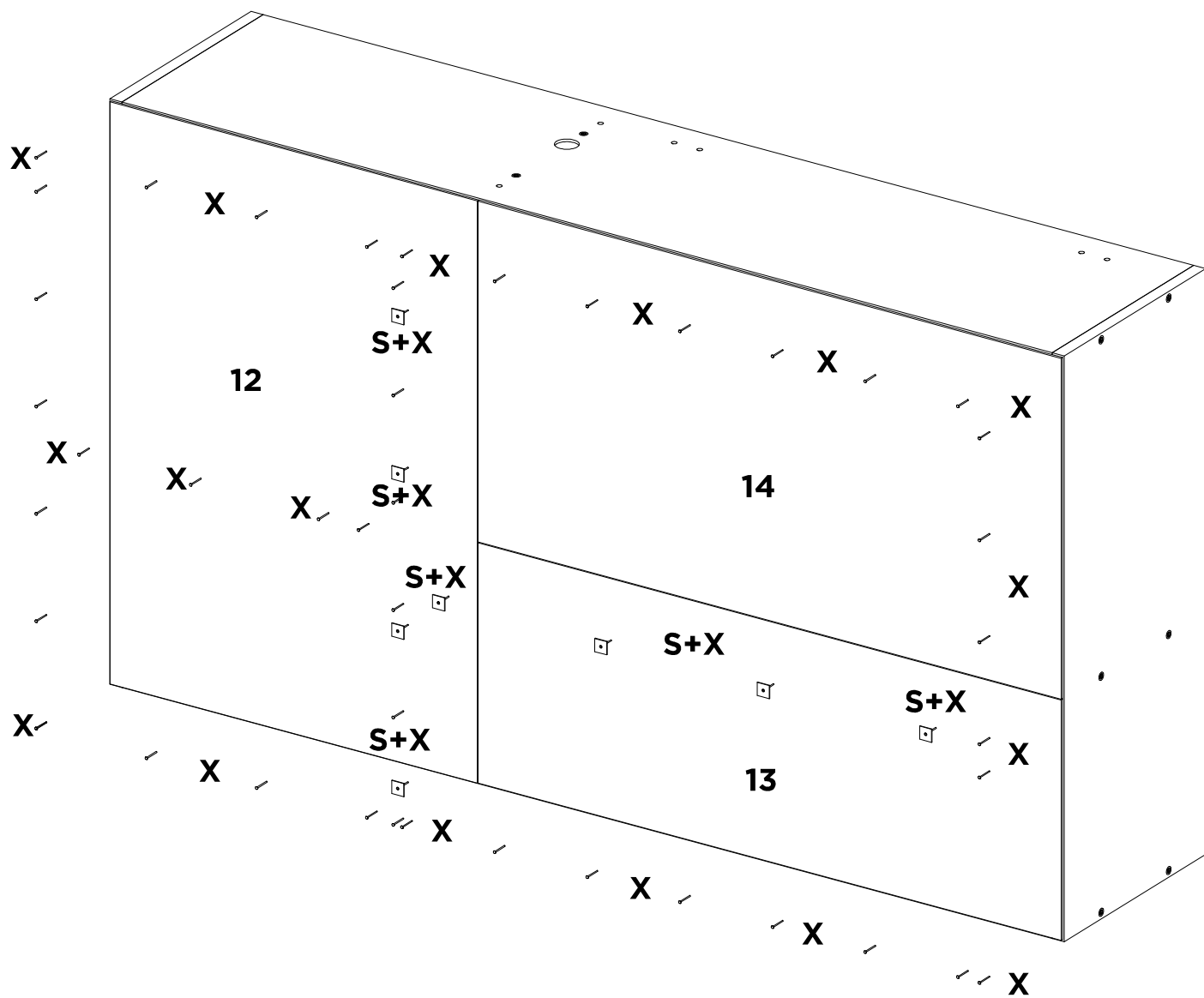

S	X	-	-	-	-	-	-
X8	X50	-	-	-	-	-	-

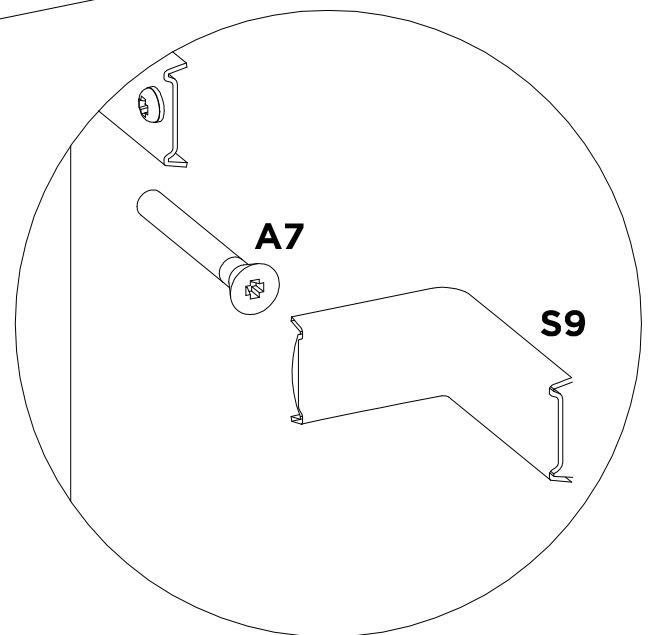
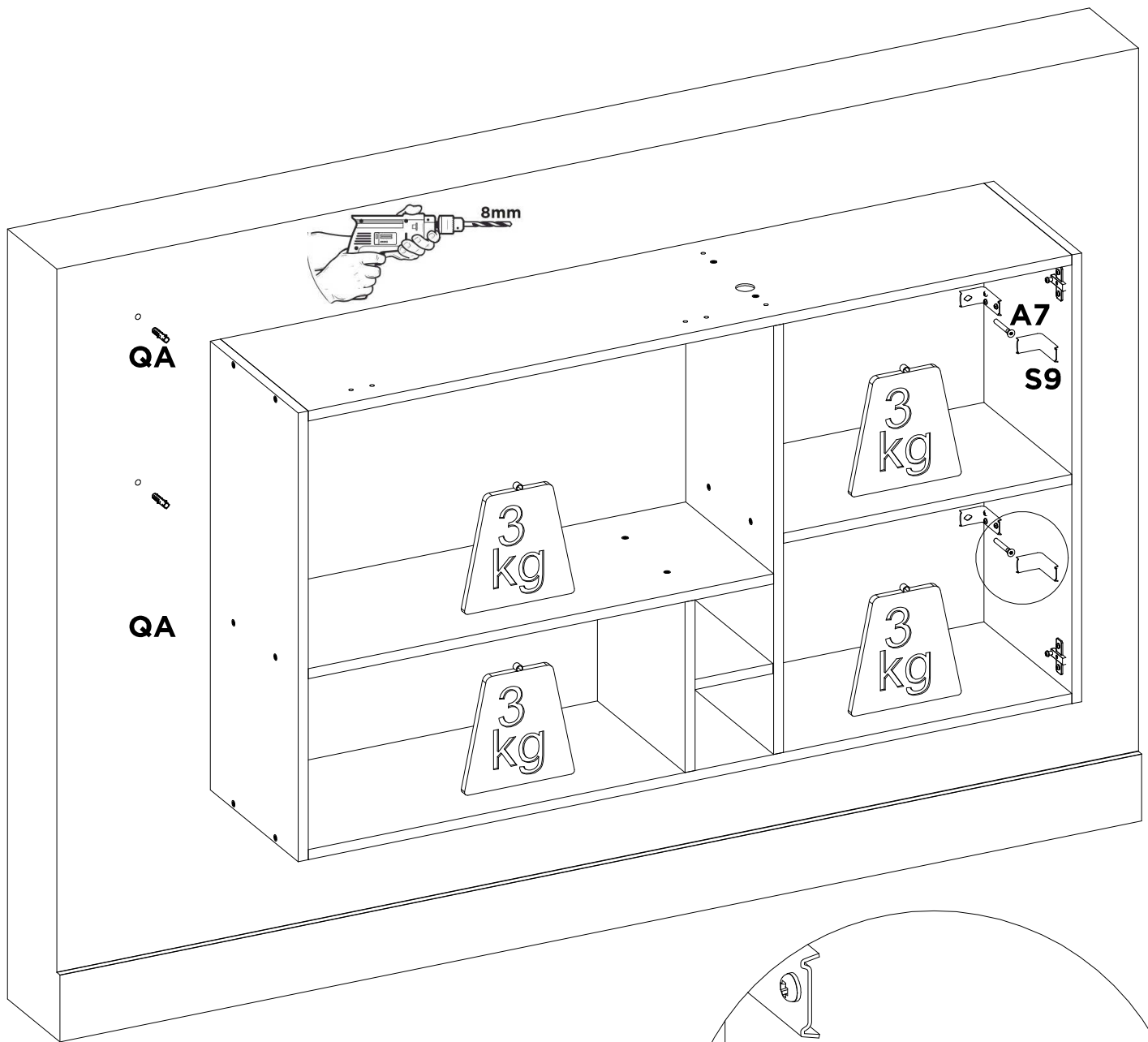

A7	QA	S9	-	-	-	-	-
X4	X4	X4	-	-	-	-	-

20

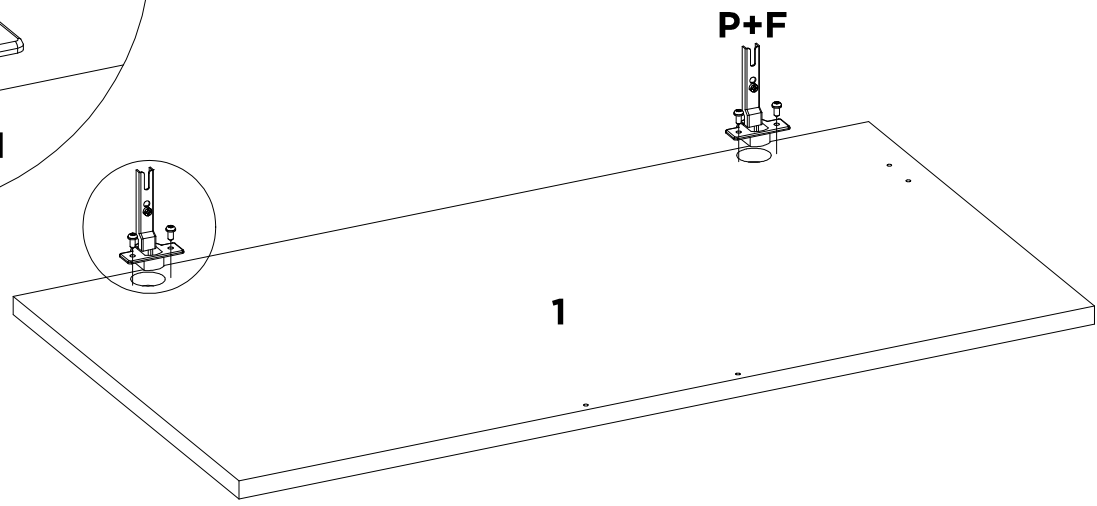
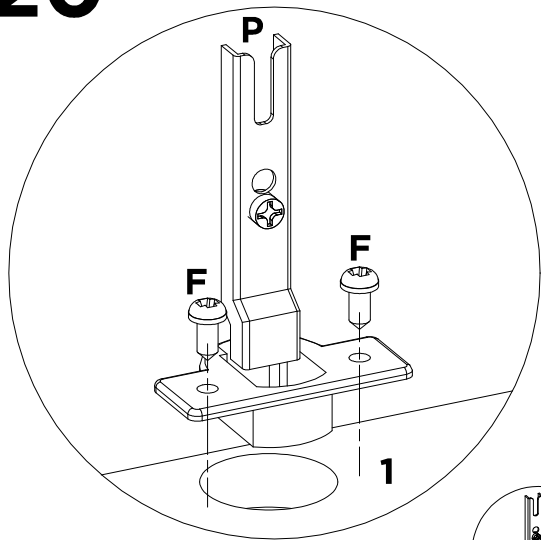

F	P	-	-	-	-	-	-
X4	X2	-	-	-	-	-	-

20A

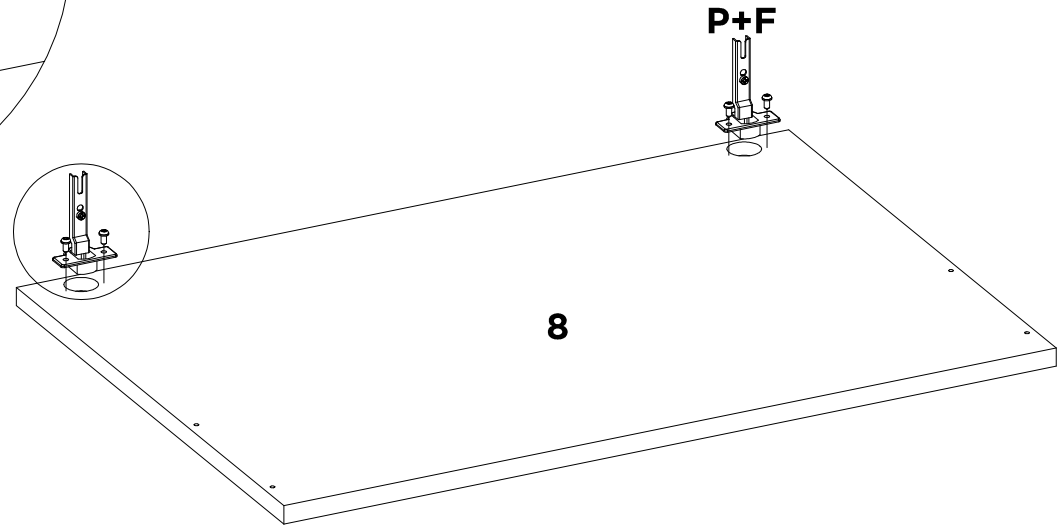
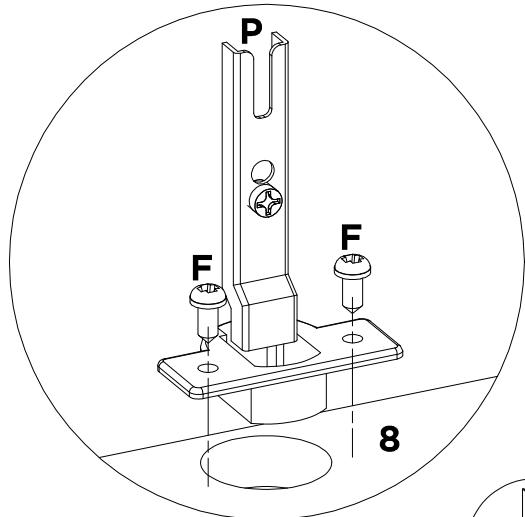

F	P	-	-	-	-	-	-
X4	X2	-	-	-	-	-	-

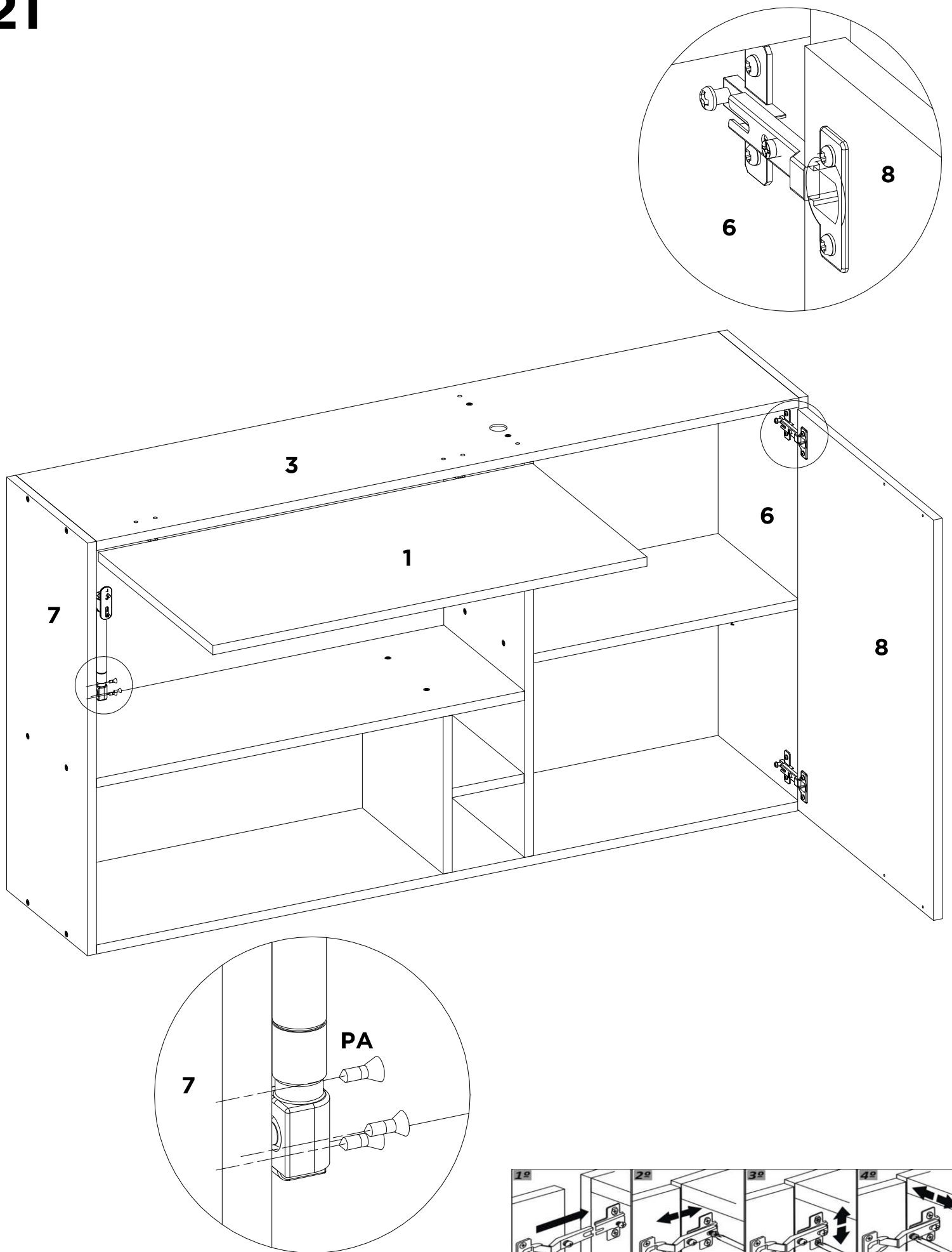

PA	-	-	-	-	-	-	-
X1	-	-	-	-	-	-	-

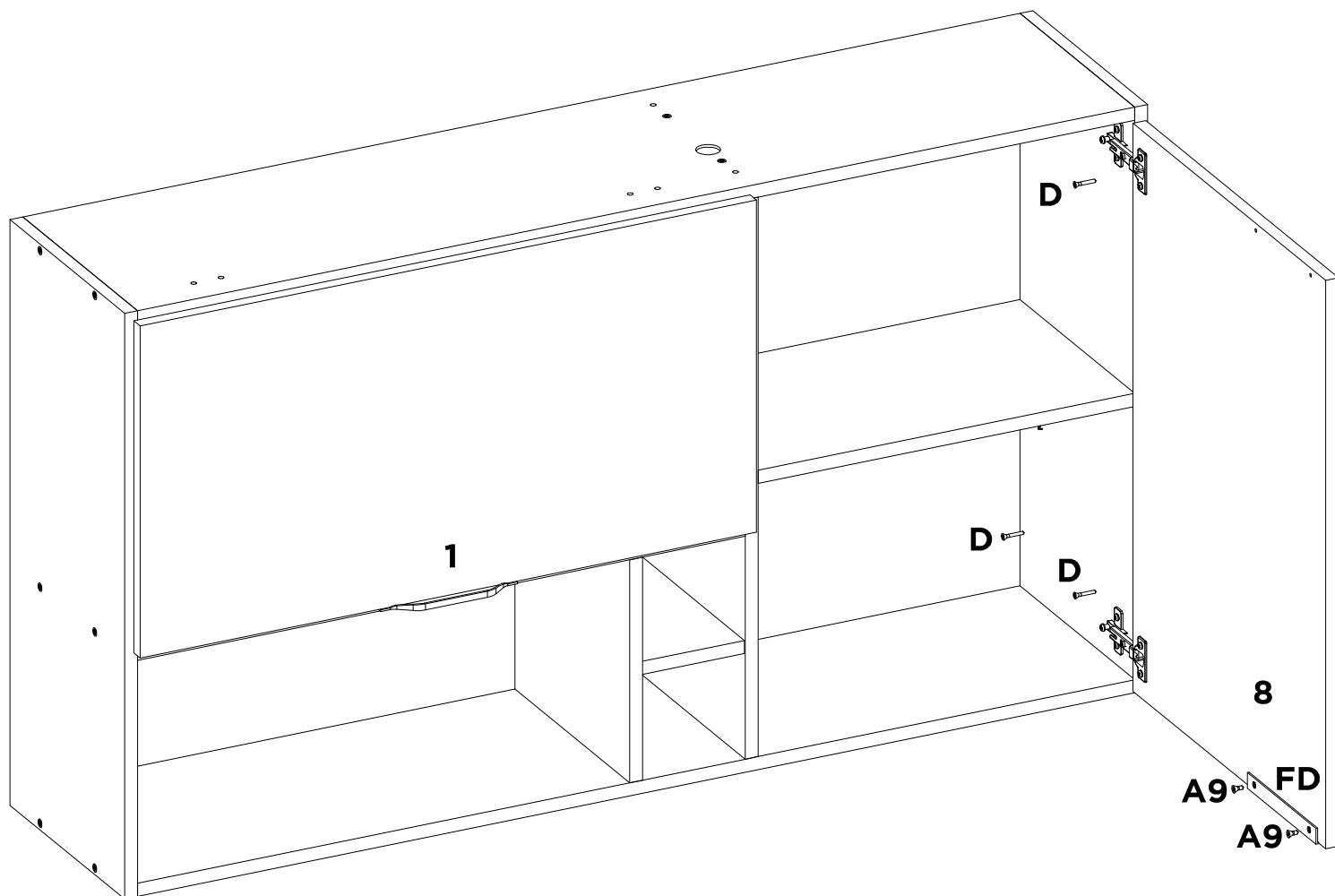

A9	FD	D	-	-	-	-	-
X4	X2	X4	-	-	-	-	-

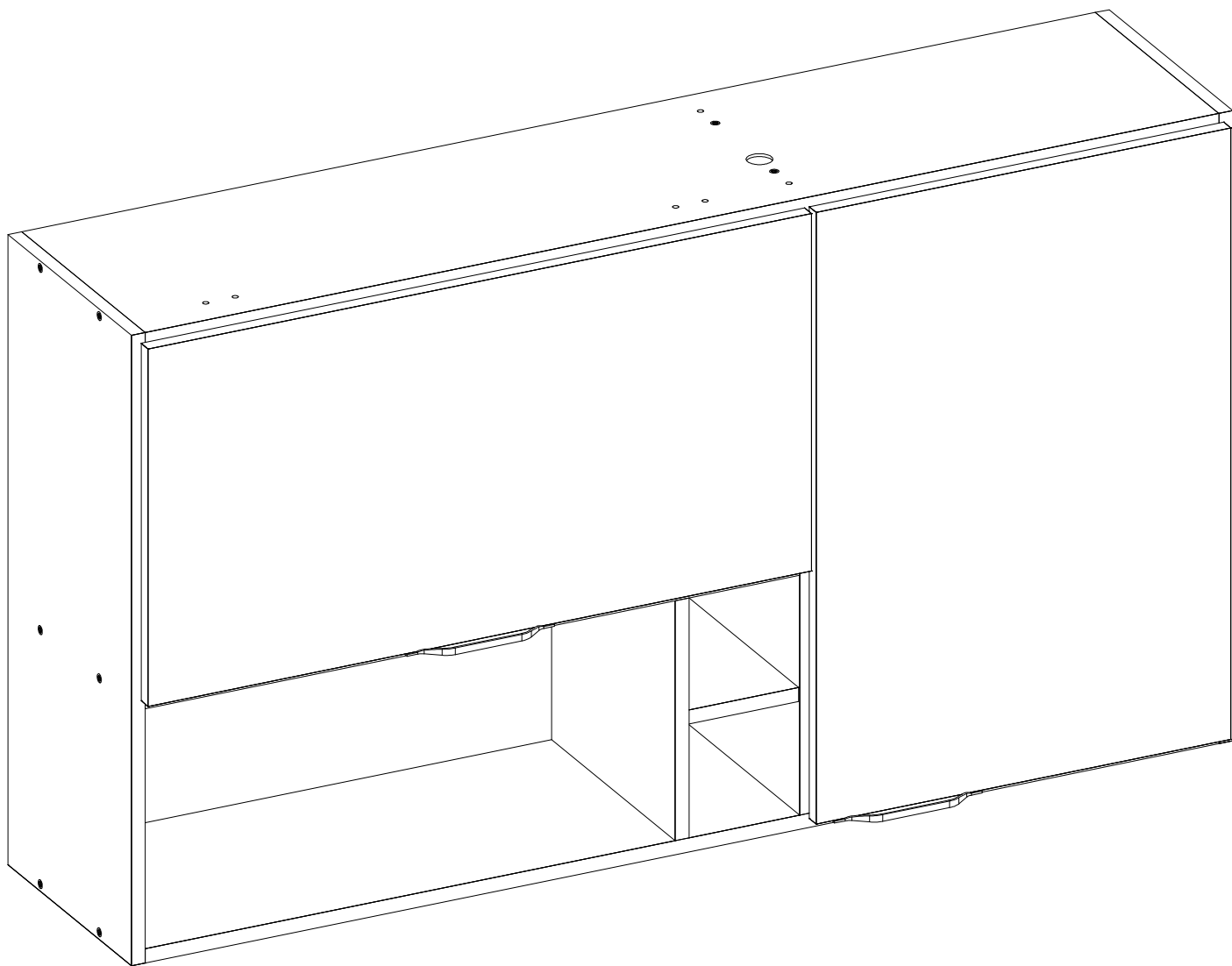

-	-	-	-	-	-	-	-
-	-	-	-	-	-	-	-



DemóBILE