

PH-1728 ROUPEIRO 2 PORTAS DE CORRER**Roupeiro 2 portas correr - Wardrobe 2 sliding doors - Armario 2 puertas correderas**

Ferramentas necessárias para montar o móvel.
Tools needed to assemble the furniture.
Herramientas necesarias para armar el mueble.

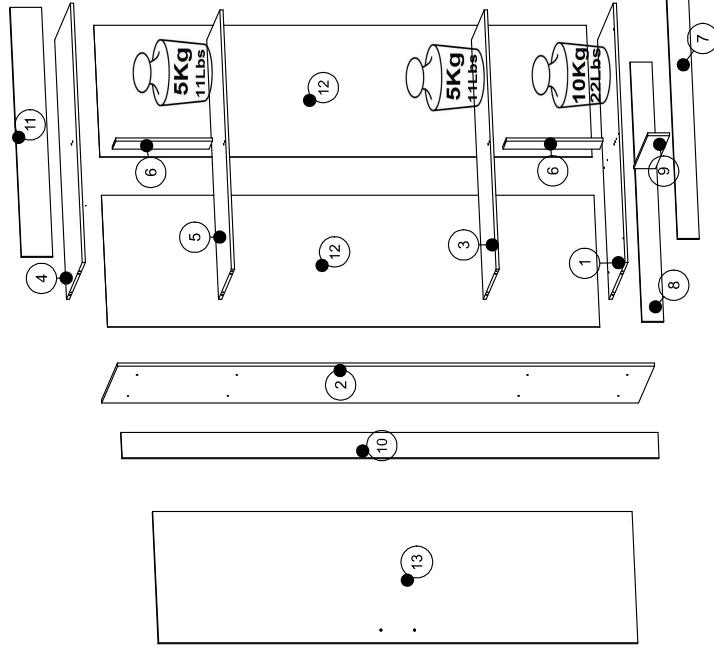

A montagem deve ser efetuada por uma pessoa.
The assembly must be done by one people.
El montaje debe ser efectuado por una persona.

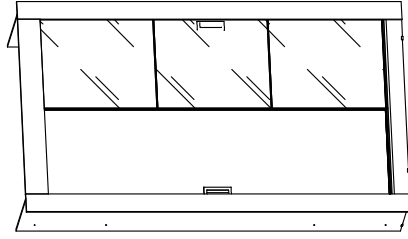
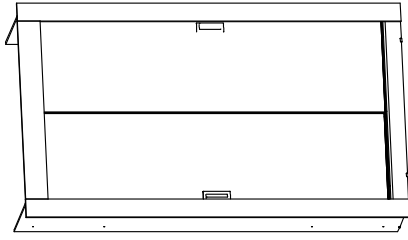
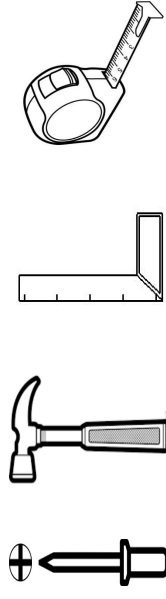
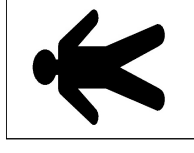

Montar o móvel sobre uma superfície plana.
Assemble the furniture on a clean and flat surface.
Armar el mueble sobre una superficie limpia y plana.



Tempo necessário para a montagem:
Time required for assembly:
Tiempo requerido para el montaje:

Dúvidas? Entrar em contato:
Doubts? Get in touch:
Dudas? Ponerse en contacto:



PH-1728 ROUPEIRO 2 PORTAS DE CORRER

LISTA DE PEÇAS - LIST OF PARTS - LISTA DE PIEZAS

VOLUME 1

REF.	CÓDIGO	PEÇA	PART	PIEZA	MED/MEASURE/MED	QTDE
1	158108E	BASE	BASE	BASE	1030.0x452.0x12.0	1
2	158109E	LATERAL	SIDE	LATERAL	2050.0x452.0x12.0	2
3	158110L	PRATELEIRA	SHELF	PRATELERA	1030.0x369.0x12.0	1
4	158111L	TAMPO	TOP	TAPA	1030.0x452.0x12.0	1
5	158112L	MALEIRO	CLOSET TOP SHELF	PORTA EQUIPAJES	1030.0x369.0x12.0	1
6	158113L	DIVISÃO	DIVISION	DIVISIÓN	369.0x100.0x12.0	2
7	158114E	RODAPÉ FRONTAL	FRONT BASEBOARD	RODAPIÉ FRONTAL	1030.0x83.0x12.0	1
8	158115E	RODAPÉ TRASEIRO	BACK BASEBOARD	RODAPIÉ TRASERO	1030.0x83.0x12.0	1
9	158116E	TRAVESSA RODAPÉ	TRAVERSE BASEBOARD	TRAVESSA RODAPIÉ	404.0x83.0x12.0	1
10	158118E	VISTA LATERAL	SIDE VIEW	VISTA LATERAL	2050.0x100.0x12.0	2
11	158119E	VISTA SUPERIOR	UPPER VIEW	VISTA SUPERIOR	990.0x120.0x12.0	1
210	1606930	SIST JM 135 GUIA FOLGA ZERO	KIT SYSTEM RUNNING CM85/26,8 1 DOOR	KIT SISTEMA DE CORRER CM85/26,8 1 PUERTA	xx	2
220	1607705	PERFIL I 1880X20x3.8MM CINZA ALUM001	PROFILE I 1880X20x3.8MM	PERFIL I 1880X20x3.8MM	1880.0x17.0x6.0	1
222	1607710	PERF AL FOSCO SG2013 1830MM C/ FURACAO	MATTE PROFILE 1856MM	PERFIL MATE 1856MM	1830.0x15.0x18.0	2
224	1607157	TUBO OBL CAB ALUM 1014X28X16X0,60MM	IRON PIPE OBLONGO 664	TUBEIRÍA DE HIERRO OBLONGO 664	1014.0x28.0x15.0	1
226	1607657	PERFIL 2052 ANODIZADO INFERIOR 1029MM	LOWER ANODIZED PROFILE	PERFIL ANODIZADO INFERIOR	xx	1
228	1607658	PERFIL PLAST SUP E28 1029MM	SUPERIOR PLASTIC PROFILE	PERFIL PLÁSTICO SUPERIOR	1029.0x60.0x24.0	1
-	K072498	KIT ACESSÓRIOS	ACCESSORY KIT	KIT ACESSORIOS	xx	1
03G	1601803	PUXADOR CROMADO FOSCO 128mm 309CRF	FROSTED CHROME HANDLE 128mm 309CRF	TIRADOR CROMO ESCARCHADO 128mm 309CRV	xx	2

VOLUME 2

REF.	CÓDIGO	PEÇA	PART	PIEZA	MED/MEASURE/MED	QTDE
12	158117L	FUNDO	BOTTOM	FONDO	1880.0x523.0x3.0	2
13	158120L	PORTA	DOOR	PUERTA	1830.0x521.0x15.0	2

KIT ESPELHOS / MIRRORS KIT / KIT ESPEJOS

OPCIONAL / OPTIONAL

REF.	CÓDIGO	PEÇA	PART	PIEZA	MED/MEASURE/MED	QTDE
211	1607767	CJ ESP 605X515X3MM 3PCS LAP FITA3M	MIRRORS KIT 3 PARTS	KIT ESPEJOS 3 PIEZAS	xx	1

PH-1728 ROUPEIRO 2 PORTAS DE CORRER

KIT ACESSÓRIOS/ ACCESSORY KIT/ KIT ACESSORIOS -

K072498

REF.	PEÇA	QTDE	IMAGE	CÓDIGO
A	CANTONEIRA 18x18 (ZB)	5		1604301
B	CANTONEIRA DUPLA	8		1602982
C	CAVILHA DE MADEIRA 6X40	20		1604742
D	PARAFUSO 3 X 30 CAB. CHATA PHILIPS	8		-
E	PARAFUSO 3.5 X 16 CAB. FLANGEADO	4		-
F	PARAFUSO 4 X 12 CAB. CHATA PHILIPS REBAIXADA	76		1606847
G	PARAFUSO 4 X 40 CAB. CHATA PHILIPS	20		1604937
-	PREGO 10 X 10 C/CABEÇA - Ø1,5 x 23mm	66		1605365
I	SAPATA QUADRADA 12x12 (CINZA)	8		1606846
J	SUPORTE METÁLICO P PRENDER PERFIL (REF.2538)	2		-
K	SUPORTE TUBO OBLONGO PLÁSTICO	2		1603790

FERRAGENS EM ESCALA REAL - REAL SCALE HARDWARE - HERRAJES EM TAMAÑO VERDADERO

Em caso de dúvidas, compare as ferragens com as imagens abaixo em tamanho real.
En caso de dudas, compare las herrajes con las imágenes a seguir en tamaño real.
In case of doubt, compare the hardware with the full-size images below.

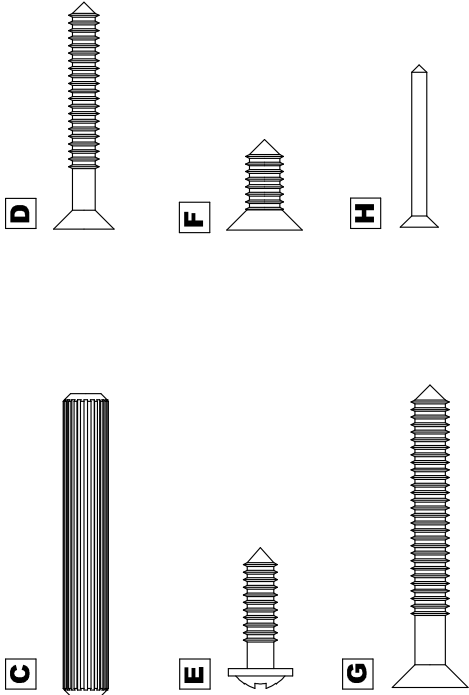

PREPARAÇÃO DAS PEÇAS - PREPARATION OF PARTS - PREPARACION DE PIEZAS

C	16
H	4
I	4

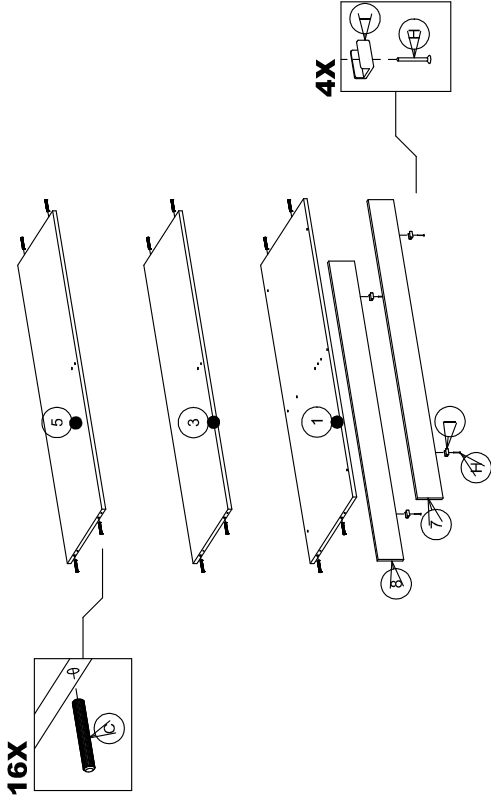

PH-1728 ROUPEIRO 2 PORTAS DE CORRER

PREPARAÇÃO DAS PEÇAS - PREPARATION OF PARTS - PREPARACION DE PIEZAS

C	4
F	4
H	4
I	4
K	2

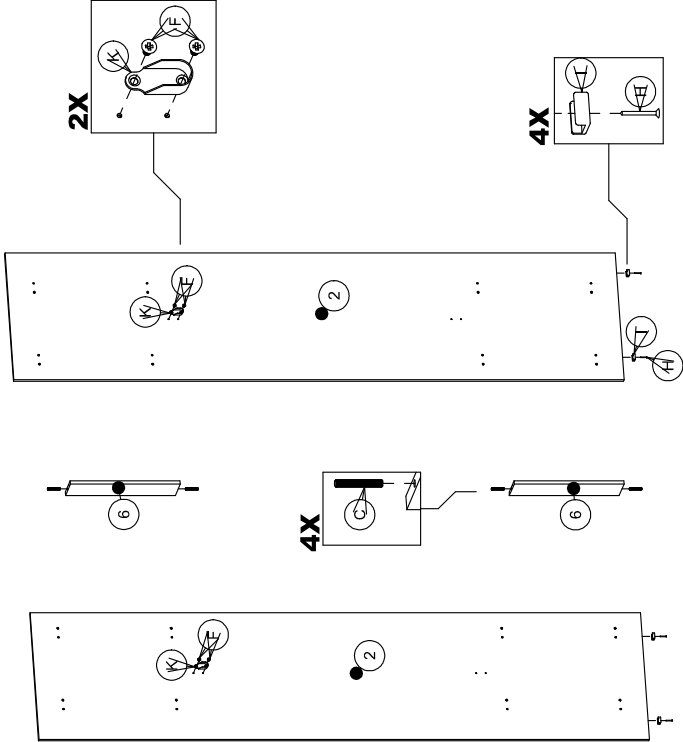

2X

4X

1

A	2	4
F		

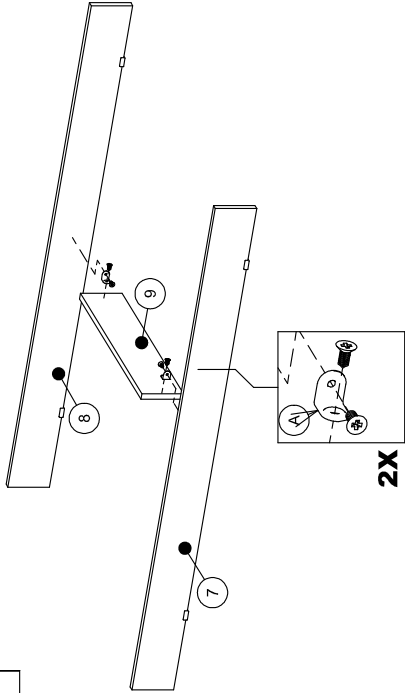

2X

2

G	2
---	---

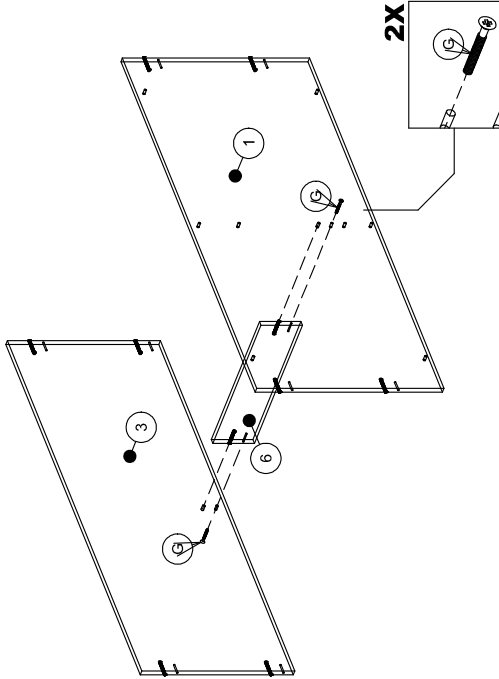

2X

3

D	8
---	---

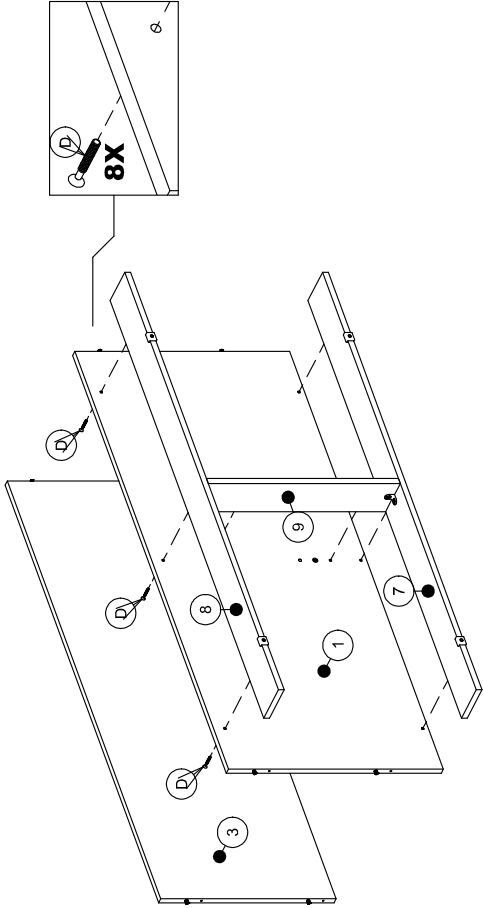

8X

PH-1728 ROUPEIRO 2 PORTAS DE CORRER

G 2 **4**

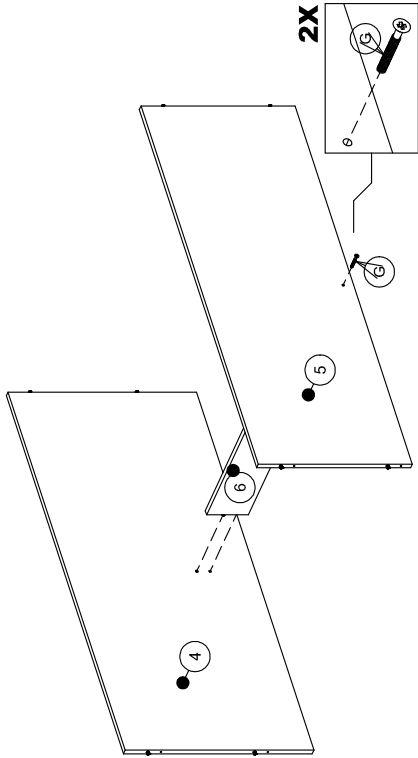

6 G 8

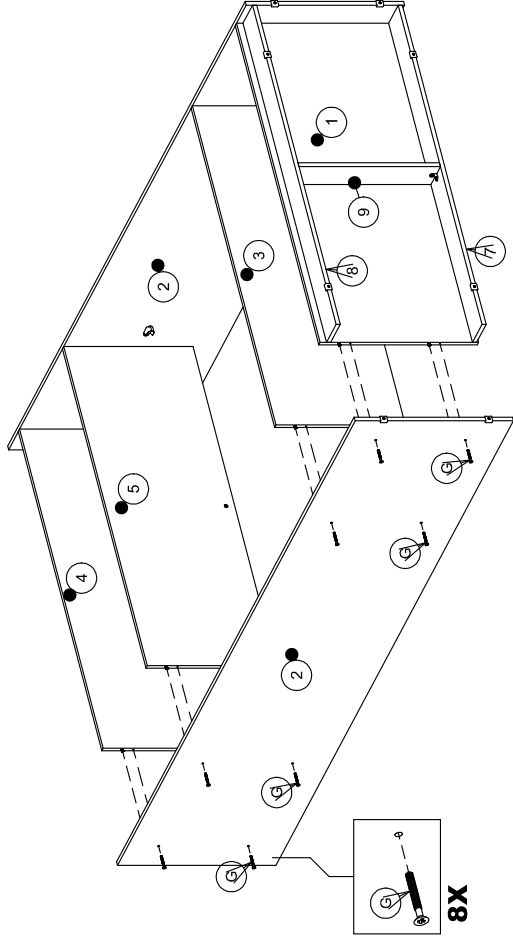

G 8 **5**

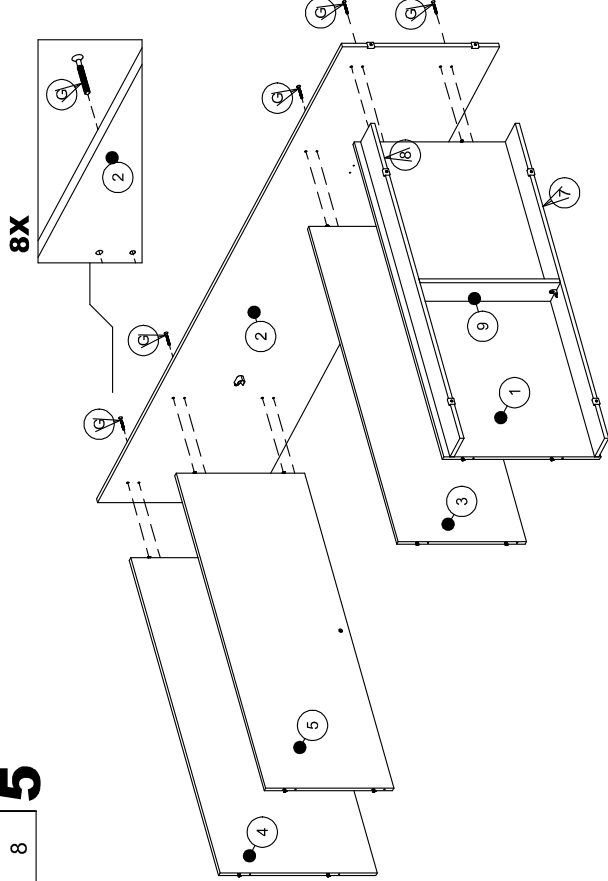

7 21 66
220 1

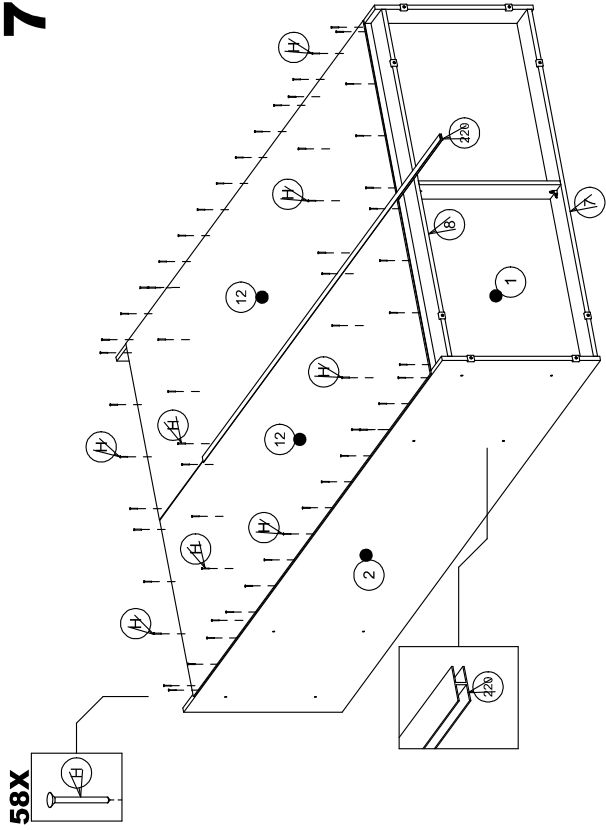

PH-1728 ROUPEIRO 2 PORTAS DE CORRER

A	3
B	8
F	44
J	2

8

8X

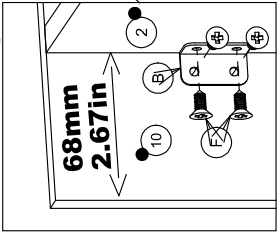

3x

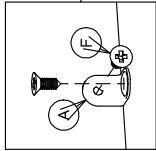

2X

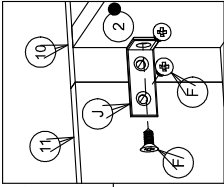

9

224	1
226	1
228	1
F	12

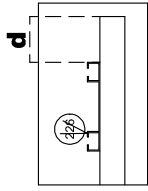
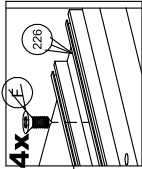
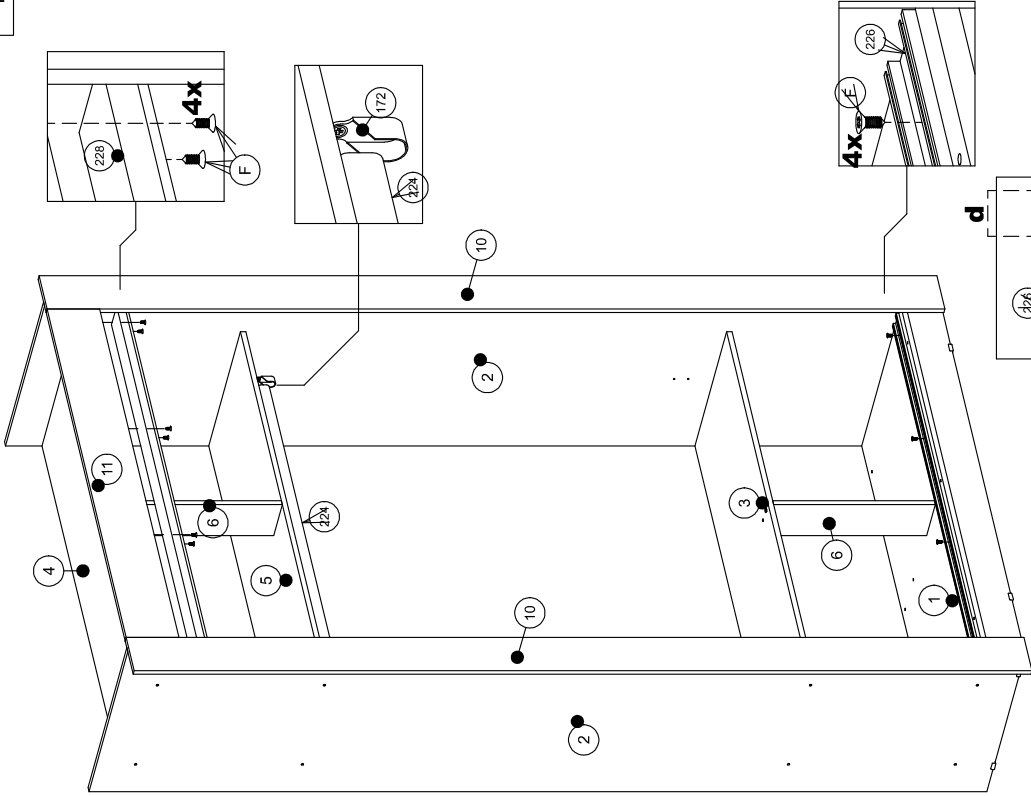

d= 24mm
0.94in

PH-1728 ROUPEIRO 2 PORTAS DE CORRER

210	1
222	1
03G	1
E	2
F	6

10

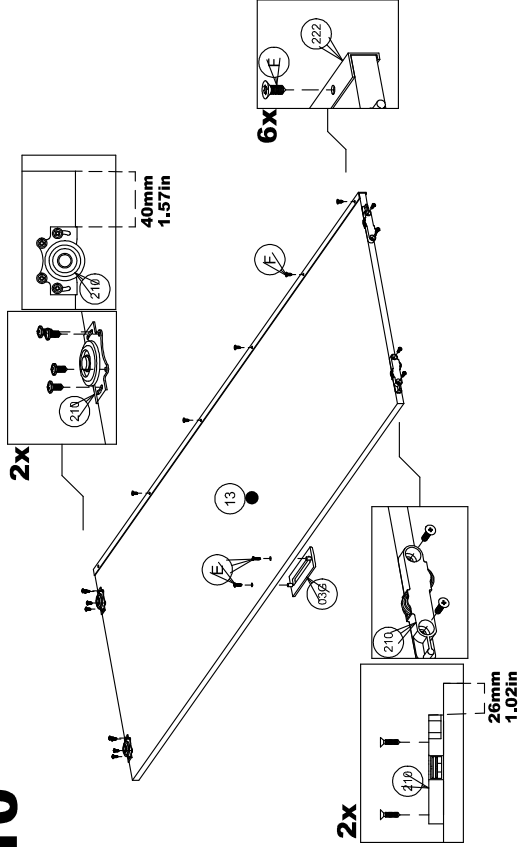

210 4

12

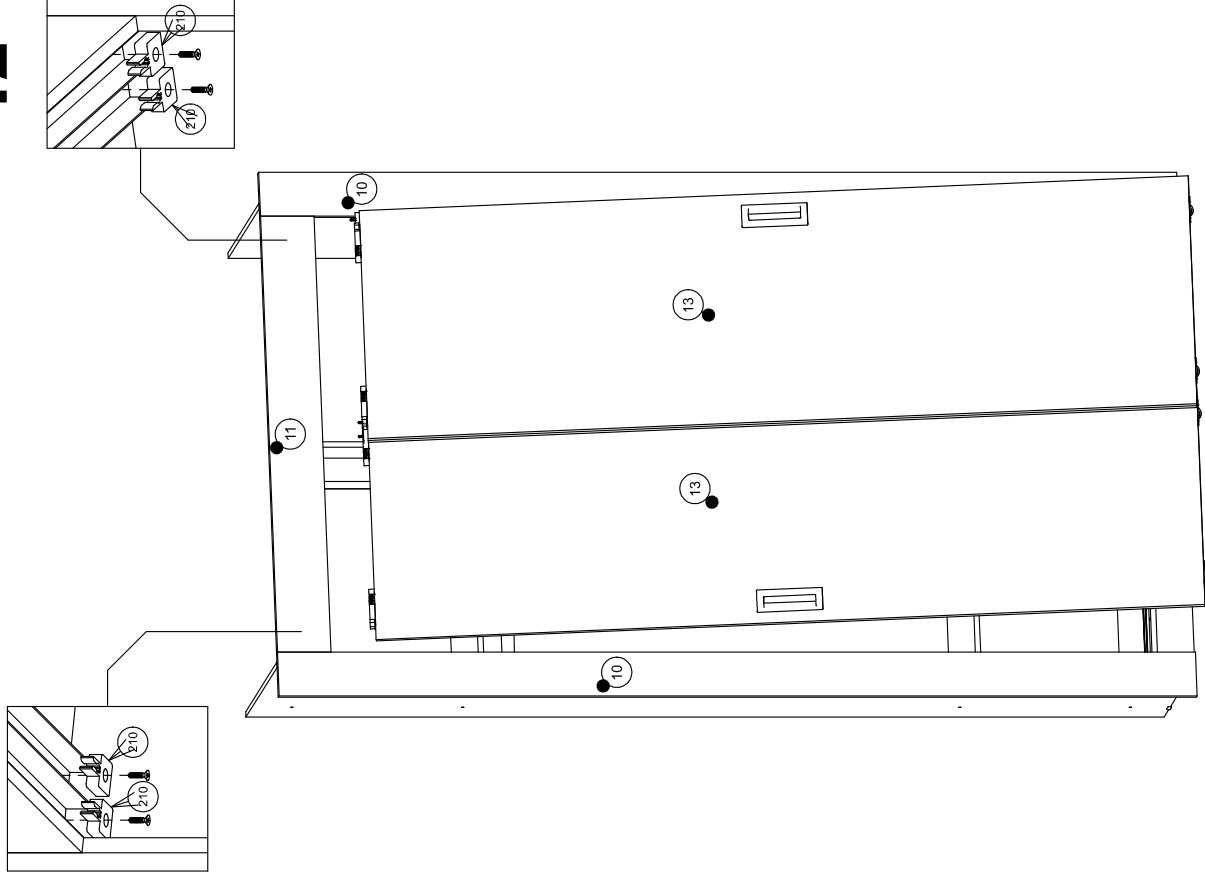

210	1
222	1
03G	1
E	2
F	6

11

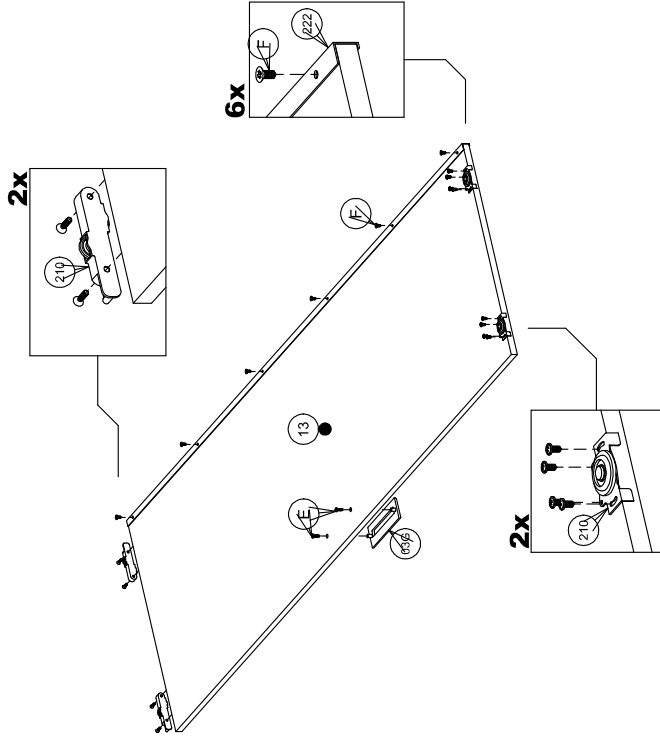

PH-1728 ROUPEIRO 2 PORTAS DE CORRER

MONTAGEM DO KIT ESPELHOS / ASSEMBLY THE MIRRORS KIT / MONTAJE DEL KIT ESPEJOS

- * Fixar o Kit Espelhos somente na Porta Frontal.
- * Fix the Mirrors Kit only at the Front Door.
- * Fijar el Kit Espejos solo en la Puerta Frontal.

