

ACESSÓRIOS

A 11X

PARAFUSO
GIROFIX

B 11X

TAMBOR
GIROFIX

C 14X

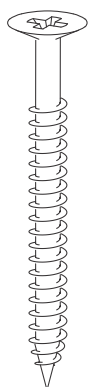
PARAFUSO
CHATO 5X50mm

D 08X

PARAF. CHATO
3,5X12mm

E 04X

CAVIL. MADEIRA
6X30mm

F 32X

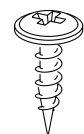
PARAF. FLANG.
3,5X14mm

G 01X

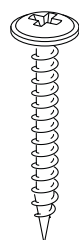
PARAF. FLANG.
3,5X30mm

H 04X

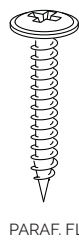
PARAF. FLANG.
5X25mm

I 24X

PREGO
10X10mm

J 02X

CANTONEIRA 02
FUROS

L 02X

RODÍZIO COM
TRAVA

M 01 par

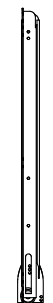

CORREDIÇA

N 02X



PASSA FIO

O 04X

PARAFUSO
CHATO 6X8mm

P 01X



PUXADOR

Q 04X

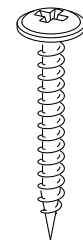
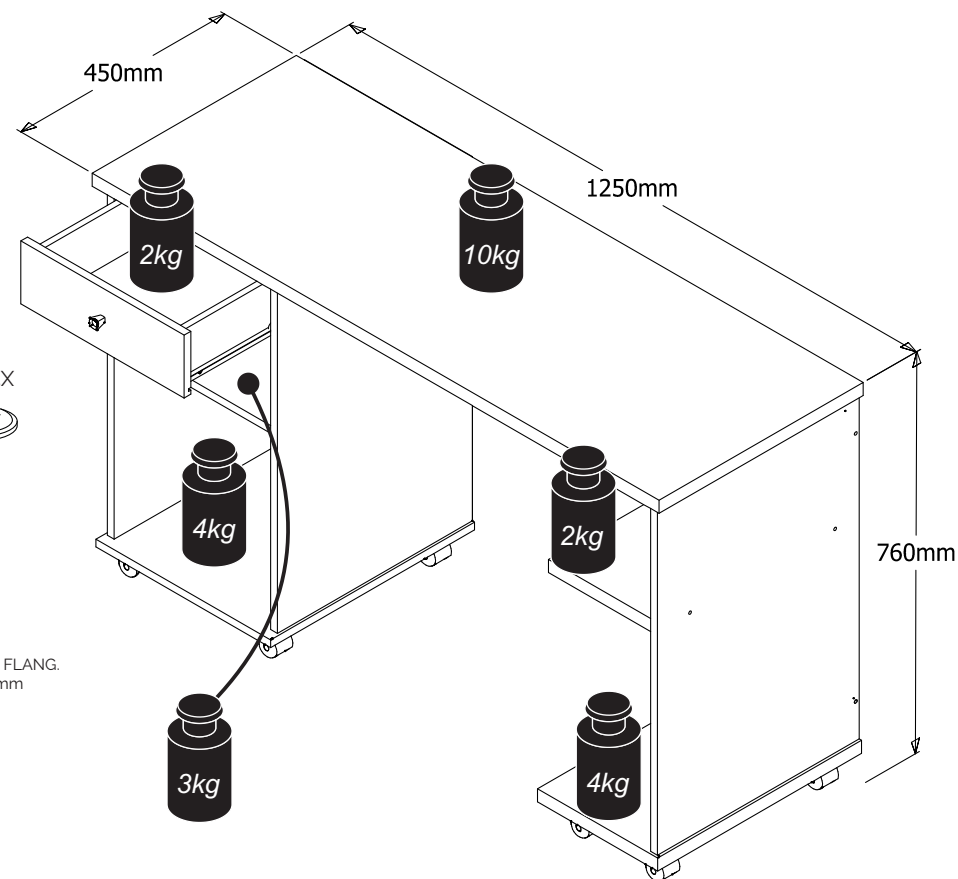
PREGO FLANG.
3,5X35mm

ATENÇÃO

Conferir as medidas dos parafusos e acessórios na escala abaixo antes de utilizá-los

MEDIDAS EM mm



FERRAMENTAS NECESSÁRIAS (NÃO FORNECIDAS)

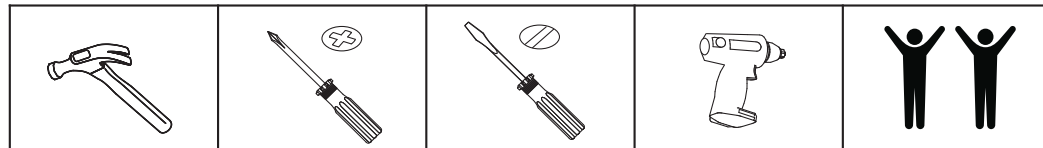

RECOMENDAÇÕES DE USO

- 1- O produto deve ser transportado em sua embalagem para que sejam preservadas suas características;
- 2- A limpeza e manutenção do produto deve ser feita com pano úmido, sem adição de produtos químicos;
- 3- A montagem deve atender aos passos especificados no roteiro de montagem, que se encontra em anexo ao produto;
- 4- Evitar locais úmidos ou com excessiva luz do sol, para maior durabilidade do produto.

Nº	QTD.	DESCRIÇÃO	MEDIDAS (mm)
01	01	TAMPO	1250X450X25
02	01	LATERAL ESQUERDA	670X430X15
03	01	PRATELEIRA ESQUERDA	345X380X15
04	01	DIVISORIA	670X430X15
05	01	BASE ESQUERDA	450X385X15
06	01	TRAVA	838X130X15
07	01	LATERAL DIREITA	660X445X15
08	01	FUNDO DIREITO	660X240X15
09	01	PRATELEIRA DIREITA	230X425X15
10	01	BASE CPU	265X450X25
11	01	FUNDO TRASEIRO	705X370X3
12	01	FRENTE GAVETA	360X120X15
13	02	LATERAL GAVETA	300X90X12
14	01	FUNDO GAVETA	320X305X3
15	01	CONTRAFUNDO GAVETA	295X75X12

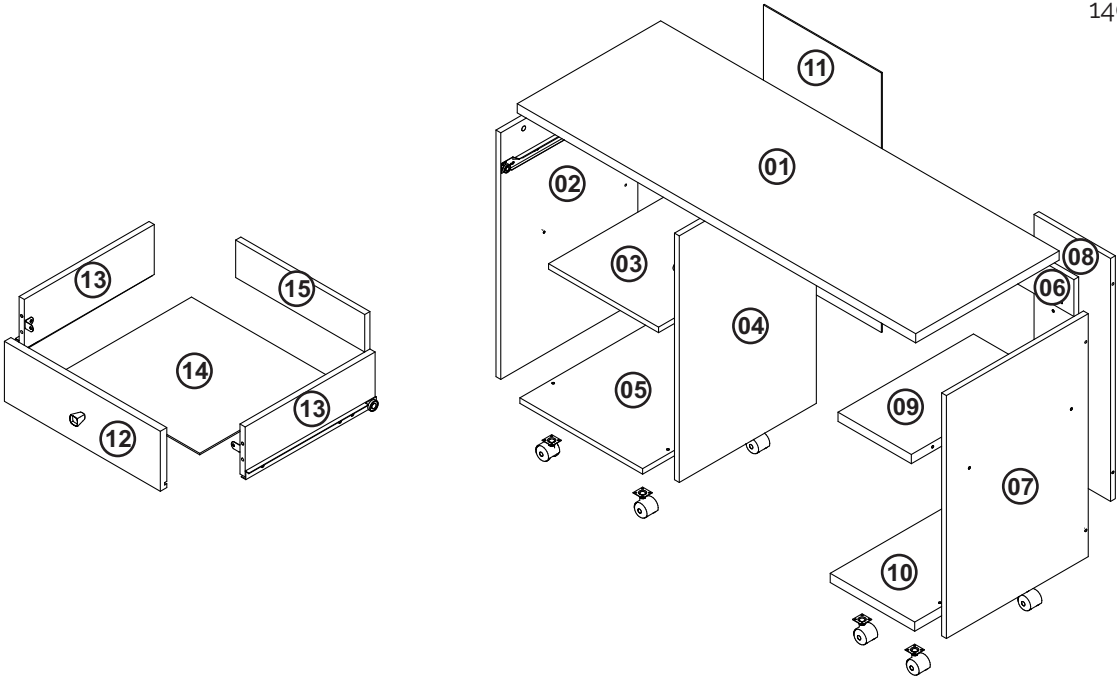

| MONTAGEM

PASSO 01

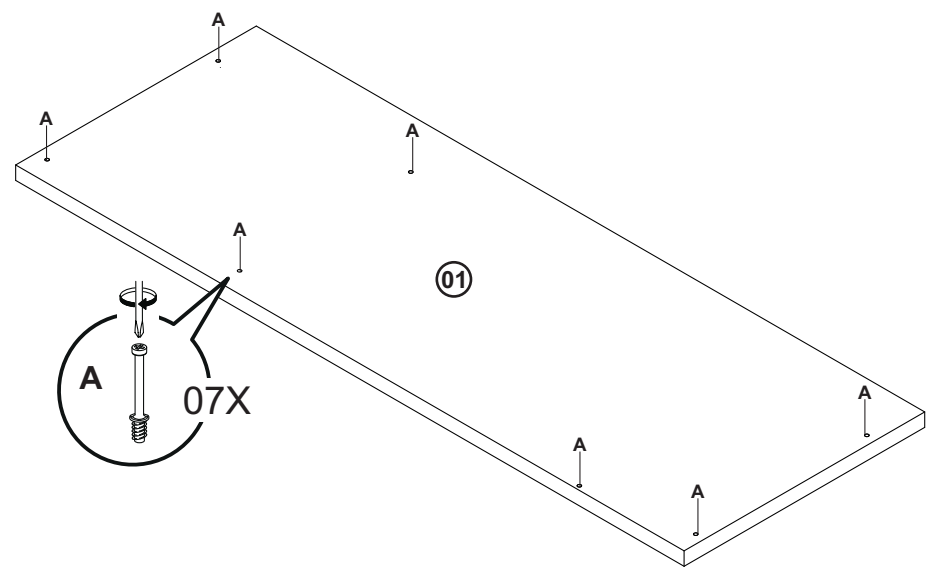

PASSO 02

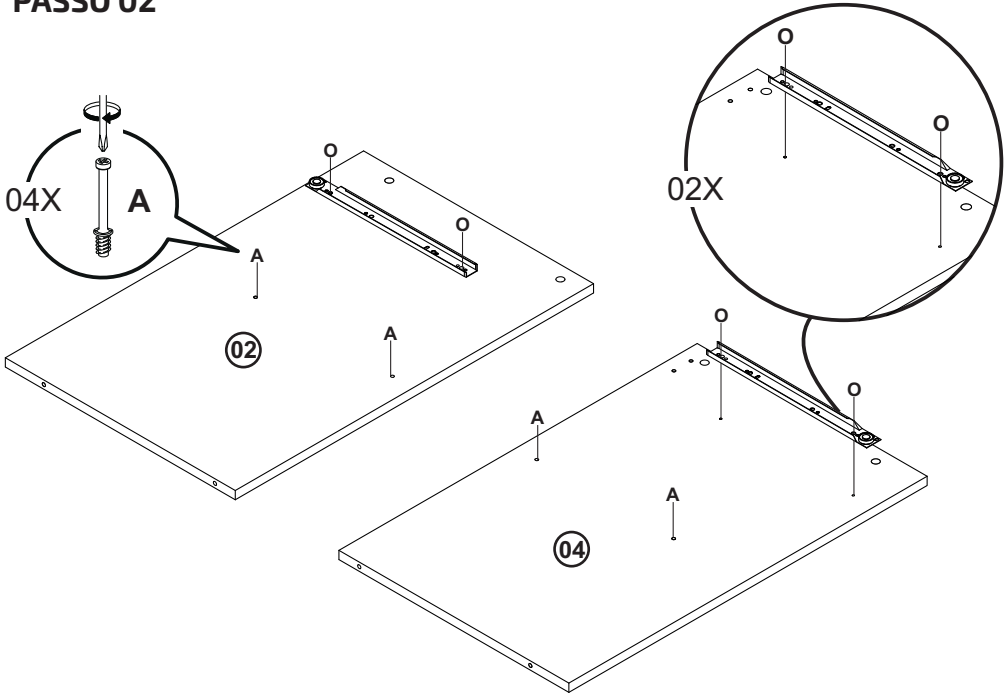

PASSO 03

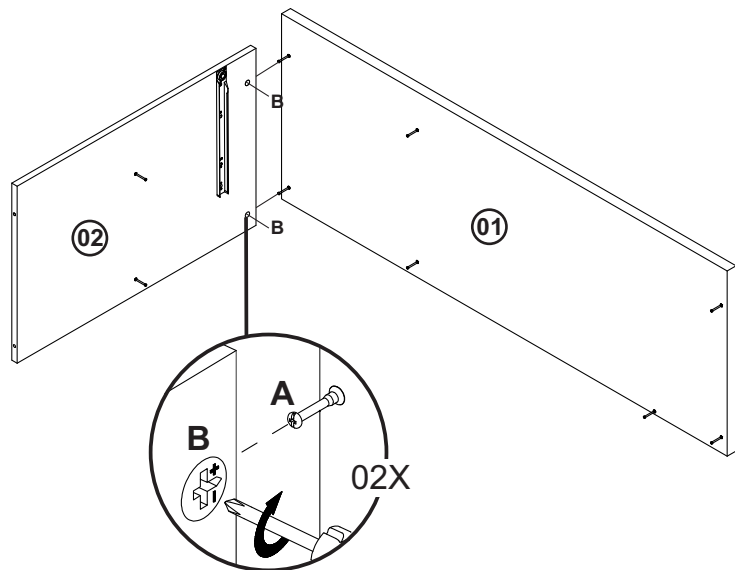

PASSO 04

140722

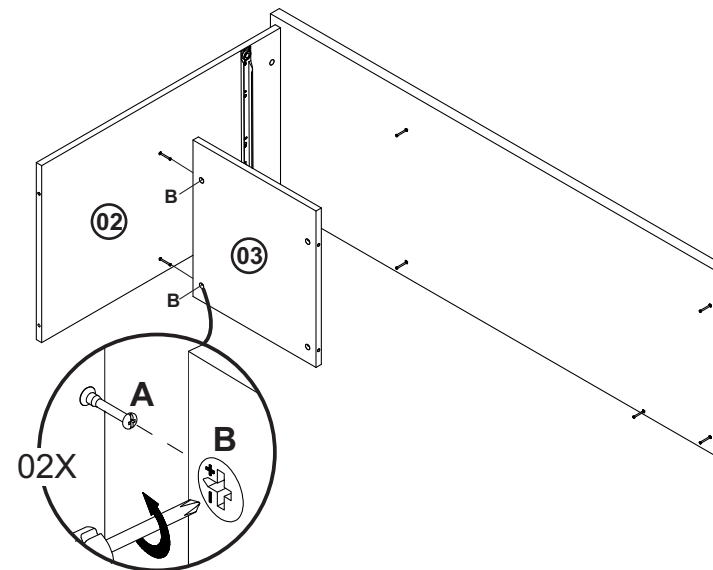

PASSO 05

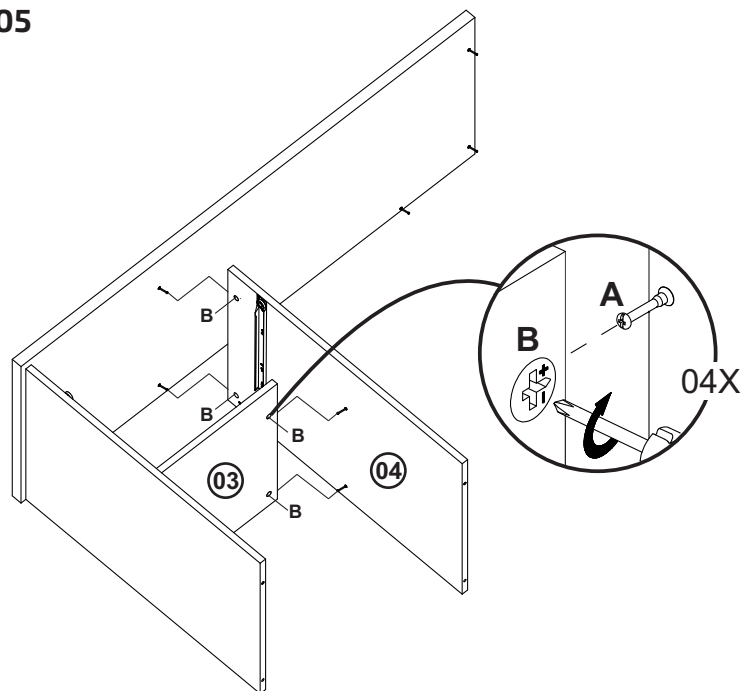

PASSO 06

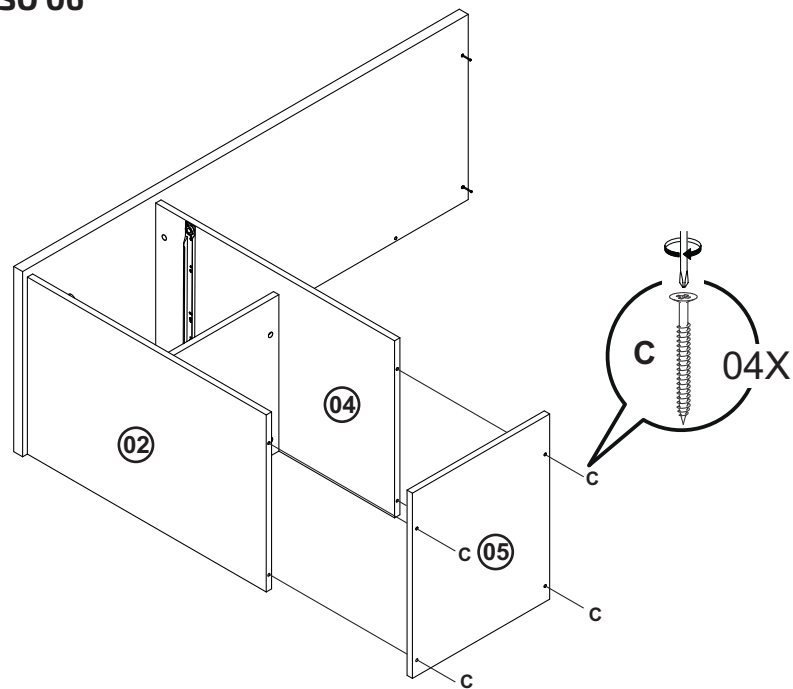

PASSO 07

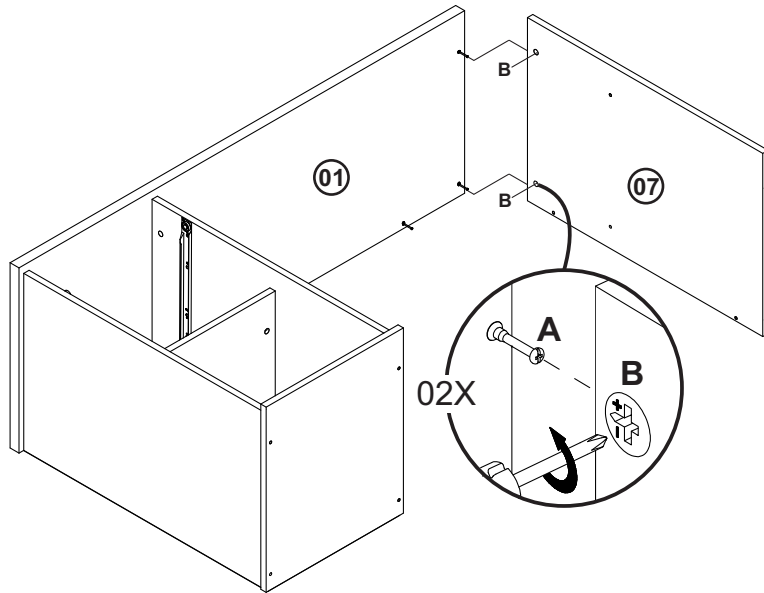

PASSO 08

140722

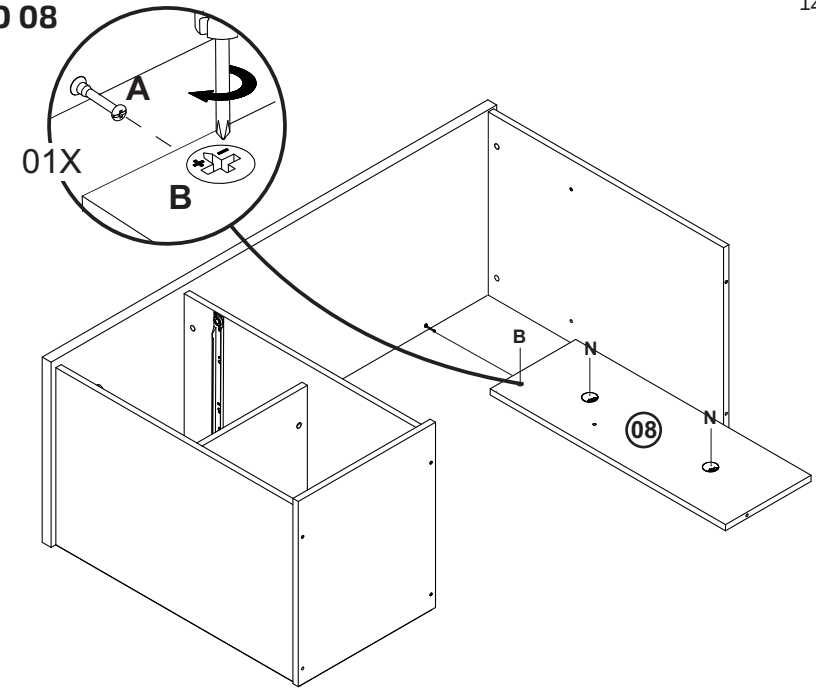

PASSO 09

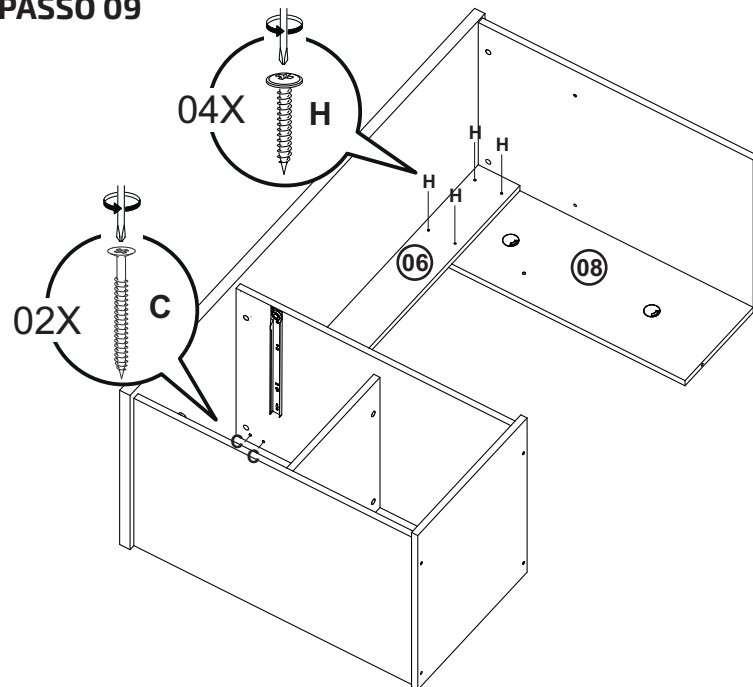

PASSO 10

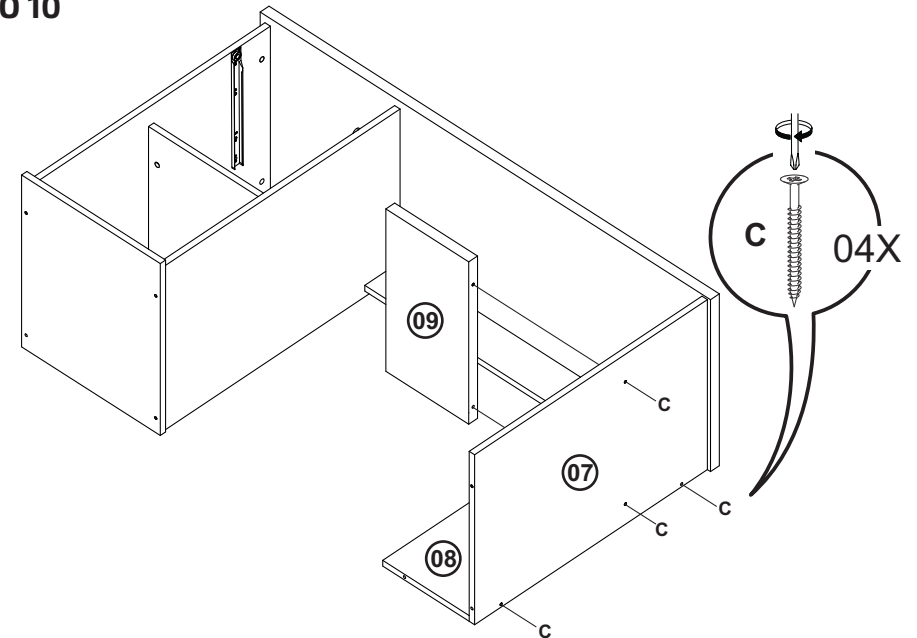

PASSO 11

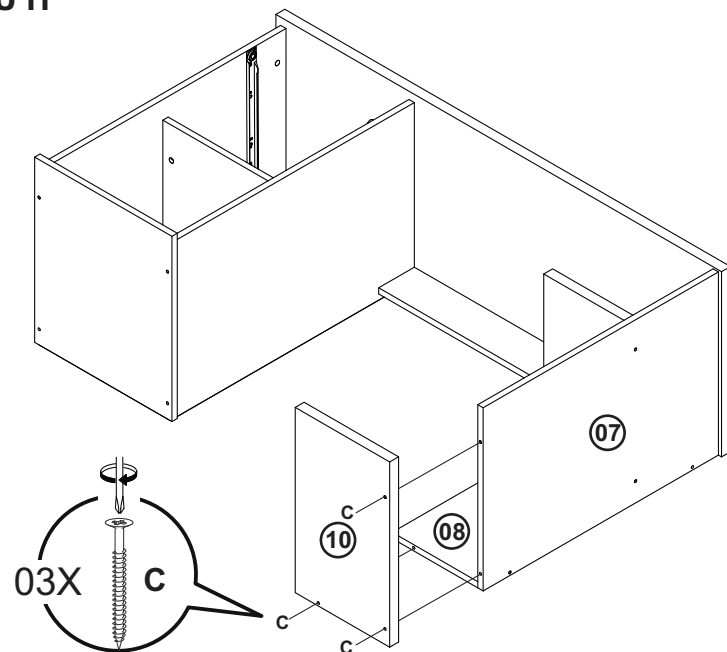

PASSO 12

Observe a posição correta dos rodízios (K, L).
Os rodízios com
trava (L) vão nas
extremidades
das
bases **05 e 10**.

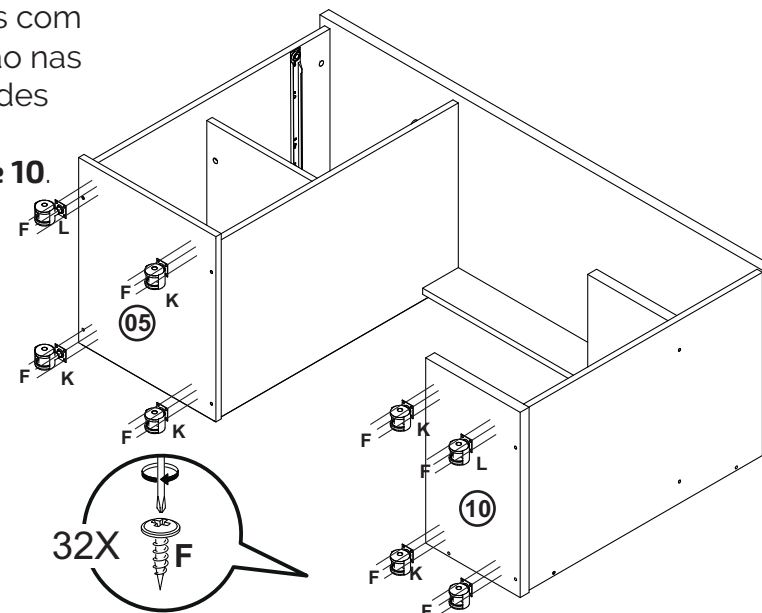

PASSO 13

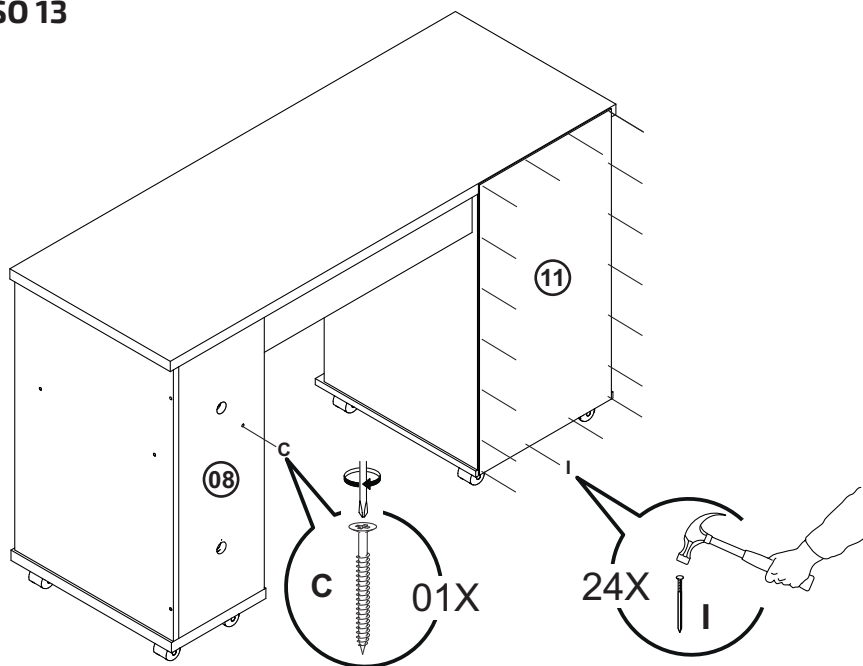

PASSO 14

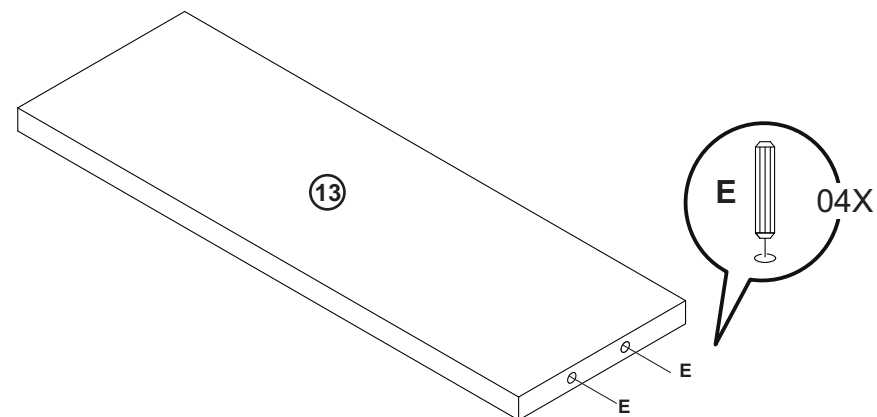

PASSO 15

As laterais da gaveta (13) devem ser colocadas com o acabamento para cima, como indica o desenho ao lado.

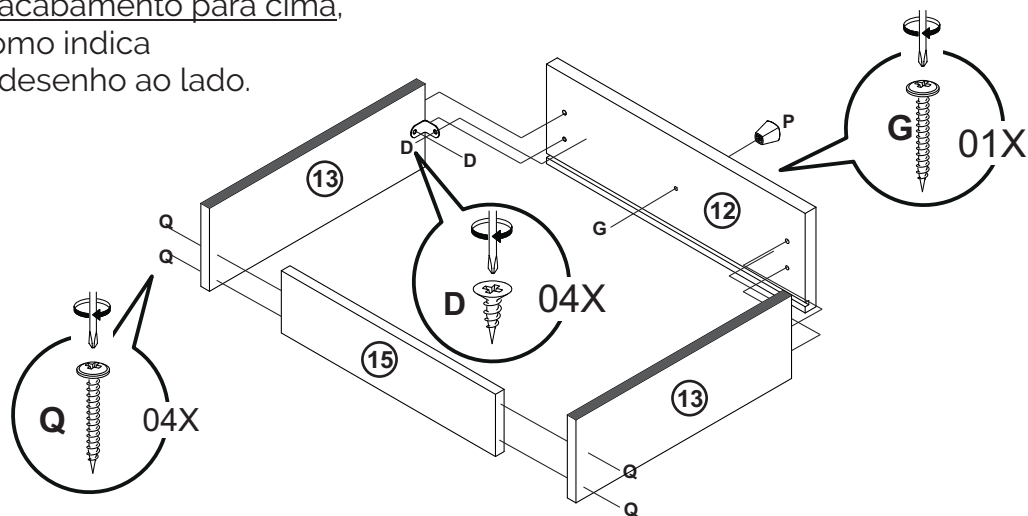
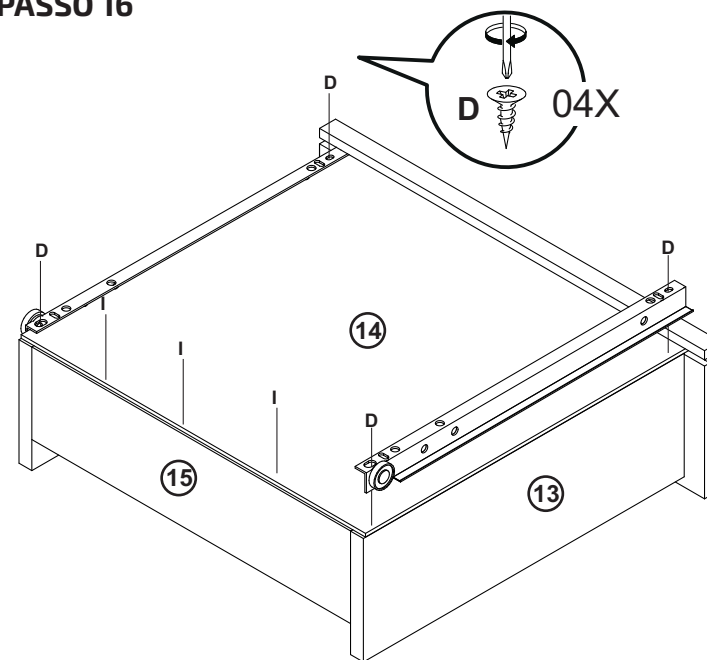
**PASSO 16****PASSO 17**